

## ENSO — OYSTER MARINE LTD



**Судостроитель:** OYSTER MARINE LTD

**Год постройки:** 2016

**Модель:** Sloop

**Цена:** **ЦЕНА ЯХТЫ ПО ЗАПРОСУ**

**Местонахождение:** Spain

**Длина общая:** 82' 0" (24.99m)

**Ширина:** 20' 6" (6.25m)

**Мин. осадка:** 11' 2" (3.40m)

**Макс. осадка:** 11' 2" (3.40m)

**Крейс. скорость:** 9 Kts. (10 MPH)

**Макс. скорость:** 12 Kts. (14 MPH)

Купить **ENSO — OYSTER MARINE LTD** а также выбрать подходящую вам яхту из нашего каталога яхт вам поможет опытный яхтенный брокер Андрей Шестаков. На сегодняшний день компания **Shestakov Yacht Sales Inc.** имеет большое количество яхт в собственном списке продаж, а также тесно сотрудничает со всеми крупными яхтенными производителями по всему миру.

Для того чтобы купить яхту **ENSO — OYSTER MARINE LTD** а также проконсультироваться по любому вопросу связанному с покупкой, продажей, чартером яхт позвоните по телефону **+7(918)465-66-44**.

# ОГЛАВЛЕНИЕ

ОГЛАВЛЕНИЕ	2
ХАРАКТЕРИСТИКИ	3
Обзор	3
Основная информация	3
Размеры	3
Скорость, вместимость и масса	4
Размещение	4
Корпус и палуба	4
Информация о двигателе	4
ПОДРОБНОЕ ОПИСАНИЕ	5
Specification	5
Исключения	10
Отказ от ответственности	10
ФОТОГРАФИИ	11
ENSO GA	15
КОНТАКТЫ	16
Контактная информация	16
Телефоны	16
Время работы	16
Адрес	16

# ХАРАКТЕРИСТИКИ

## Обзор

Oyster 825 'ENSO' is an exciting opportunity. Immediately available, you can take delivery of this 'as new' Oyster 825 for sale. Meticulously maintained by her professional crew this stunning example has an exemplary 'superyacht' specification and is ready for adventure in Summer 2019. ***View 'ENSO' at Palma Superyacht Show (27 April - 1 May)***

## Основная информация

**Тип судна:** Sloop

**Подкатегория:** Крейсерская яхта

**Модельный год:** 2016

**Год постройки:** 2016

**Страна:** Spain

**Регистрационный номер:** 747005

**Номер регистрации в береговой охране:** ROAD HARBOUR

## Размеры

**Длина общая:** 82' 0" (24.99m)

**Длина по ватерлинии:** 72' 0" (21.95m)

**Ширина:** 20' 6" (6.25m)

**Мин. осадка:** 11' 2" (3.40m)

**Макс. осадка:** 11' 2" (3.40m)

## Скорость, вместимость и масса

Крейс. скорость: 9 Kts. (10 MPH)	Крейсерская скорость поворота: 1600 Kts.
Макс. скорость: 12 Kts. (14 MPH)	Макс. скорость поворота: 2600 Kts.
Водоизмещение: 123458.86672 Pounds	Чистый вес: 73 Pounds
Вместимость воды: 2000 Gallons	Вместимость сточного бака: 950 Gallons
Объем топливного бака: 3000 Gallons	

## Размещение

Всего кают: 4	Всего коек: 11
Спальные места: 11	Всего ком. состава: 4
Каюты экипажа: 1	Койки экипажа: 2
Спальных мест экипажа: 2	Комм. состав экипажа: 1

## Корпус и палуба

Материал корпуса: GRP	Материал палубы: GRP
Комплектация корпуса: Fin & Bulb	Цвет корпуса: White
Отделка корпуса: Plastic	Дизайнер корпуса: Humphreys Yacht Design

## Информация о двигателе

Двигатели: 1	Производитель: Cummins
Модель: QSB 6.7MD-305	Тип двигателя: Inboard
Тип топлива: Diesel	

# ПОДРОБНОЕ ОПИСАНИЕ

## Specification

Oyster 825 Bermudan sloop built By Oyster Yachts, UK Hull No. 6 Year: 2016

LOA: 25 metres / 82" LWL: 21.9 metres / 72" BEAM: 6.3 metres / 20' 6" DRAFT: 3.42 metres / 11' 2" DISPL: 56000 kg / 123458 lbs

**ENSO HIGHLIGHTS:** - Carbon Mast & carbon furling boom - Halyard & mainsheet captive winches - Lewmar Commander 800 hydraulic Powerpack - 720ah Lithium ION domestic batteries - SKYSHIPS – mms monitoring system - Hydraulic passerelle in transom - Reckman GZ hydraulic furler on bowsprit (Code zero) - Additional ONAN Generator (11kw) - Retractable stern thruster - Vi Spring exclusive mattresses **BROKER COMMENT:** **Oyster 825 'ENSO' is an exciting opportunity. Immediately available, you can take delivery of this 'as new' Oyster 825 for sale. Meticulously maintained by her professional crew this stunning example has an exemplary 'superyacht' specification and is ready for adventure in Summer 2019. View 'ENSO' at Palma Superyacht Show (27 April - 1 May)**

**CONSTRUCTION:** Constructed of Fibre Reinforced Plastics (FRP) and sandwich materials. Category A – Ocean Design and structure to Det Norske Veritas (DNV) Built to MCA Category 2 specification Foam cored sandwich construction above water line Single skin composite construction below waterline Foam cored deck giving excellent insulation properties

White hull and deck with grey hull striping Teak laid cockpit and side decks Deep fin keel with lead bulb Twin spade rudders Hydraulic transom swim platform with teak steps and swim ladder

**GROUND TACKLE:** 66kg (140lb) galvanised CQR main anchor 125 metres of 14mm galvanised chain 40kg Lewmar Delta collapsible kedge anchor (MCA rated) & 100 metres Octoplait warp (MCA compliant).

**WINDLASS:** Lewmar V8 vertical hydraulic, two-way anchor windlass. Operated by adjacent foot switch controls. Retractable Sanguinetti warping drum on foredeck

**VARIOUS FEATURES:** Pair of gateway stanchions with stainless steel hinging ladders Stainless steel boarding ladder Hydraulic passerelle in transom Main companion way door electrically powered and with inflatable seal for use while at sea Solimar flush deck hatches. Lewmar 44 flush escape hatches to aft guest cabins Main companion way folding sprayhood (light Charcoal' Sunbrella) 2 x Biminis with stainless steel tube frames in 'Light Charcoal' (1 x main guest cockpit and 1 x over helm positions – both zipped on solid sides and mesh sides) Foredeck sun awning in 'Silver' Sunbrella – both zipped on solid sides and mesh sides. Padded cockpit table cover, pedestal and steering wheel covers Cockpit, helm and pushpit seat cushions upholstered in Sunbrella 'Prussian Blue' acrylic covers. Exterior scatter cushions in Sunbrella 'Flannelle' fabric Custom RIB cover in 'Light Charcoal' Sunbrella Sole (floor) protection druggets in galley, saloon and aft passageway H+C transom shower Jabsco Ultra 7 saltwater wash down

pump - outlet on deck by pushpit. 3m and 24m hose. (MCA compliant). Freshwater outlets on deck at the bow and cockpit. Waterproof speakers in guest cockpit and helm areas with remote control at helm for CD/tuner/MP3. White cockpit table with integral refrigerated GRP drinks fridge Steering wheels - Lewmar Y-spoke 1.2m diameter carbon wheel with friction brake Pair of stainless steel dinghy bump bars. Seasmart stainless steel 'pop-up' mooring cleats Stainless steel and teak chocks for tender on foredeck. Large lazarette locker with twin stainless steel gas struts.

**RIG AND SAIL HANDLING** Hall Spars carbon painted white mast Carbon Oceanfurl in-boom hydraulic furling boom In-boom preventer with sheave at aft end of boom 2 x Harken hydraulic backstay tensioners with mechanical lock-off 1 x Harken hydraulic vang with positive support 'No-Strike' lightning ion dissipater at masthead Glomex FM/TV antenna at masthead Reckmann RF-90 hydraulic headsail furler for blade Jib + manual backup. Aramid removable storm jib stay, storm jib halyard and hydraulic tensioner. Reckmann CZ 8 hydraulic furler fitted into bowsprit – for Code Zero and A2 Spinnaker Carbon spinnaker pole stowed vertically on mast (inc halyards, pole lift, sheets, guys and tender lift track)

**WINCHES:** Lewmar 3500 captive winch for main halyard Lewmar captive winch for mainsheet 2 x Lewmar 88/3 SHST 3-speed, hydraulic drive self-tailing primary winches 2 x Lewmar 77/2 SHST 2-speed, hydraulic drive, self-tailing secondary winches 1 x Lewmar 68 SHST hydraulic drive, stainless steel GY, self-tailing halyard winch 1 x Lewmar 77 SHST hydraulic drive, stainless steel GY, self-tailing halyard winch Deck switches upgraded to stainless steel Lewmar Grand Prix.

**SAILS:** North Sails 3Di 760 mainsail, furling blade jib C-tech carbon battens Storm jib soft hanked in white with day-glo orange strip – Dacron North Sails Code Zero sail in Aramid downwind laminate CZ90 DP (inc PBO torsion rod) North Sails asymmetric G2 Spinnaker, Norlon NO150 c/w C-tech inflatable snuffer

**ACCOMODATION:** ENSO sleeps 11 Guests in 4 guest cabins (inc two Pullman berths & 1 pipecot) Sleeps two crew in port side forward bunk cabin & bathroom Watertight bulkhead door fwd to sail locker Guest cabin comprising of: - King sized double master cabin aft & master bathroom - Twin VIP cabin aft Port with bathroom ensuite (Twin beds slide to create double. Also pipecot and pullman fitted) - Twin VIP cabin aft Starboard with bathroom ensuite (Twin beds slide to create double. Also pullman fitted) - Double guest cabin en suite & starboard forward of saloon All sea berths have Dacron lee screens fitted 7" Vi Spring exclusive mattresses for all cabin berths **INTERIOR FINISH & FEATURES:** Interior joinery - American White Oak with water stained finish Features include sculpted fiddles and grabrails and 'shadow-gap' joints between panels Door handles in nickel finish with leather wrapping Companionway and all handrails covered with distressed 'Chocolate' leather Cabin floor in 'fumed oak' with water based whitening stain Floor borders in water stained 'Wenge.' Matt black Avonite galley work surfaces with radiused upstands Blind system to windows in all cabins, except galley hullport Oceanair skyscreens to all deck hatches Caframo Bora fans in galley 2 x Digital brick safes Master cabin c/w 2 x overhead deck hatches - double as escape hatches. Emergency access ladder is provided

Bathrooms: Dometic Masterflush toilets Hansgrohe mixer taps and shower controls in brushed nickel finish. Matching towel rail, toothbrush tumbler, soap dispenser, toilet roll holder, toilet brush, plus two additional lotion dispensers and two robe hooks. Hansgrohe AX Montreux shaving mirror.

**GALLEY:** To port and forward of the saloon is the galley, laundry and service area Avonite galley work surfaces Hansgrohe 'Starck' Kitchen mixer tap with pullout spray in brushed nickel finish QuOoker boiling water tap at galley sink Gimballed Miele electric oven with Miele ceramic induction hob Miele steam oven Alpes Inox cooker hood with light and extractor fan Frigomatic 24V DC seawater-cooled full-height front-opening stainless steel refrigerator Stainless steel 24V DC seawater-cooled Frigomatic freezer Frigomatic 24V DC keel-cooled cockpit table drinks box 290-litre 24V Veco freezer mounted under starboard lower saloon seating Veco fridge drawer in lower inboard cabinet Fisher and Paykel double dishwasher

LAUNDRY: Miele washing machine Miele condensing tumble dryer

**SALOON** The deck saloon is extremely light and airy with nine windows and six vertical hull ports Large square shaped settee to port with expandable brushed stainless steel table adjacent 3 x folding chairs provide additional seating for dining To starboard further seating area TV in electric lift starboard side of saloon Wrap around black mesh sunshade for exterior of saloon windows **ENGINEERING** Main engine: Cummins turbo-charged 224kW (305Hp at 2600rpm) QSB 6.7MD-305 MCD Twin disc MG 5075A gearbox Hours: 4-bladed 32" Brunton Varifold folding propeller Ambassador rope cutter 2 x alternators controlled by a Mastervolt Alpha Pro Regulator.

GENERATORS Onan MDKBT e-QD 22.5kW 50Hz/230V AC 4-cylinder diesel generator, Hours = Onan MDKBN e-QD 11.0kW 50Hz/230V second generator, Hours = Reverso electric oil change pump with (four take offs - one from each generator and one from the engine and gearbox) BOWTHRUSTER/STERN THRUSTER Sleipner SRH240 retractable, hydraulic bowthruster with 240kg thrust (powered by PTO from the generator) Sleipner retractable 24V DC stern thruster

STEERING Chain on rod system (Mamba drive) Emergency tiller

SHIPS HYDRAULICS Lewmar 800 Commander Power pack System (operating 6 winches, mainsheet captive winch, main halyard captive winch, blade furler, boom furler, Code Zero furler, storm jib ram tensioner, windlass, backstays cylinders, vang, lazarette door and Sanguinetti warping drum

AIR CONDITIONING/HEATING Cruisair reverse cycle 230V AC dual frequency heating and cooling system (50/60Hz) 1 x 16,000 BTU compressor in master cabin 2 x 8,000 BTU compressor – one in each aft guest cabin. 2 x 16,000 BTU compressor units in saloon 1 x 12,000 BTU compressor unit in galley 1 x 8,000 BTU compressor unit in forward double cabin 1 x 10,000 BTU compressor in forward crew cabin

Dometic 'Easy Breathe' system fitted to each air conditioning unit with Micromesh filter on all

return air grilles Owner's, aft guest cabins and fore ship, plus head/shower areas are fitted with forced air ventilation.

WATERMAKER Seafresh H2016A (276 litres per hour) Seafresh auto back flush system

TANKAGE: FUEL - 3,000 litres (660 Imp gallons/793 US gallons) in two GRP tanks Separ FPS-150-DC fuel polishing system

WATER: 2,000 litres (440 Imp gallons/528 US gallons) in two GRP tanks

HOT WATER: 2 x 93 litres (20 Imp gallons/25 US gallons) tanks heated by the engine's heat exchanger or 230V element

Spot Zero SZ2000 reverse osmosis system in lazarette. Plumbed to freshwater manifold in engine room & treating all shore water that is bunkered

HOLDING TANKS 2 x GRP black water holding tanks = 950 litres (209 Imp gallons/251 US gallons)

GREY WATER 4 x grey water tanks, each fitted with a float switch and a Whale Gulper pump, giving automatic evacuation of all showers and washbasins **ELECTRICS:** SHIP'S SUPPLY = 24V 230V AC ring (64ah) shore power supply BATTERIES Domestic = 4 x 180Ah lithium ion batteries Engine start = 95Ah 24V sealed lead acid battery bank Generator start = 95Ah 24V sealed lead acid generator cranking battery Navigation instruments = dedicated supply 24V 55Ah gel acid battery bank

BATTERY MANAGEMENT Engine batteries are charged by a 70A engine alternator Service batteries are charged by a Mastervolt 150A alternator on the engine 3 x Mastervolt MASS 100A/24V battery chargers, which feed on 230V from generator or dockside power Mastervolt Alpha Pro Regulator.

Skyships (MMS) monitoring system - AC/DC, chargers/inverter, generator sets, Sea Chest pressure, and main engine exhaust

INVERTER Mastervolt MASS 24/5000W sine wave inverter 230V/50Hz output from domestic supply 800W inverter to power the forced air system.

EXTERIOR LIGHTING Boom lights Downlighters on lower spreaders 3 x pairs of uplighters (one pair per spreader) LED Lopolight Navigation lights Aqua Signal 'Kiel' deck floodlight Hella low-level courtesy lighting around cockpit/walkthrough and transom steps Hella white LED bulwark lights at each stanchion base 6 x Ocean white LED Pro Series 2010XFM HD underwater lights

**NAVIGATION AND COMMUNICATION** SIRS Marine Major 150mm diameter magnetic steering compass Hand compass (MCA compliant).

Raymarine i70 displays at cockpit helm 1 x Raymarine p70 pedestal pilot control 1 x Raymarine



Ray 260E VHF (repeater) Hailer/horn mounted on radar bracket at mast (first microphone and horn button) 1 x Raymarine e127 hybrid touch radar/plotter Raymarine HD digital 4kW scanner Raymarine AIS 650 Echomax Active Radar transponder Sailmon multi function display mounted aft face of cockpit seating

AUTOPILOT Raymarine SPX SOL SmartPilot with p70 control head unit.

CHART TABLE: 1 x Raymarine i70 display 1 x Raymarine Ray 260E VHF (main station) 1 x Raymarine e127 hybrid touch radar/plotter with GS195 Glass Bridge 19" touchscreen display Furuno N300 Navtex Furuno GP32 GPS receiver as stand-alone unit (emergency backup) ICOM IC 802 SSB radio.

CAPTAIN'S CABIN Furuno RD-33 remote display unit (multi) Ray 260E VHF handset

OWNER'S CABIN Furuno RD-33 remote display unit (multi)

SATELLITE PHONE Sailor Fleet Broadband 250 BGAN satellite telephone with voice and data (up to 280kbps,) linked to PC BT Elements 1K cordless telephone connected to satellite phone Yellow Brick – Yellow Standard 3 satellite based tracking unit with bluetooth

SHIPS COMPUTER (at chart table) AG Neovo SX 17 – black 17" glass-fronted LCD display Nexcom Nise 3600E Mini PC with Intel i5 chip, 240GB SSD, 8GB RAM, Windows 7, CD/DVD drive Inventica Yacht Spot 4G EU/Asian version – wireless client Wi-Fi, 400mW wireless card and router Shakespeare Wi-Fi antenna Comrod AP21 mast mounted 4G antenna with LMR 400 coaxial cable assembly CISCO WAP371 Wi-Fi access point, simultaneous dual band (Allows portable devices to access 4G data, shore Wi-Fi data and NAS drive)

**SAFETY EQUIPMENT:** 2 x Ocean 8C ISO9650 8-person canister liferaft (inc 2 x SOLAS B grab bags, 24-hour packs) Hammar hydrostatic releases (MCA compliant) Both liferafts upgraded to include manual Survivor 06 watermakers.

EPIRB Float free 406Mhz EPIRB with GPS (MCA compliant) – pushpit mounted

BILGE PUMPS 24V DC Jabsco Utility Puppy 3000 (50 litres per minute) bilge pump with an automatic Par hydro air switch Henderson double action manual bilge pump (rated at 104 litres per minute) operated from the cockpit Emergency engine-driven 38mm Jabsco bilge pump with manual clutch (approximately 190 litres per min) Each bilge pump is fitted with a Whale tstrum box 2 x electric bilge pumps with automatic/manual/off switch at DC panel linked to alarm (in sail locker and Laz) ALARMS 9V smoke alarm for engine room lobby, crew mess and aft passageway (MCA compliant) Bilge alarm High-level float switch alarm at pedestal

OTHER SAFETY FEATURES Raymarine Ray CAM200IP camera in engine room Raymarine T470SC 25Hz stabilized Thermal Imaging Camera (spreader mounted and linked to all Raymarine screens) Stainless steel U-bolts for safety harness attachment in cockpit Watertight bulkheads and doors

DINGHY: Zar Formenti ZF3 with integral 40-litre fuel tank, navigation lights, bilge pump and stainless steel boarding ladder Yamaha F70 4-stroke outboard engine Stainless steel ski pole Single point lifting kit SAFE: Digital 4-brick safe and Digital 2-brick safe HEYCO MARINE TOOL KIT : Large Heyco marine toolkit in sealed box.

ASSORTED TOOLS, SPARES AND MANUALS

---

## Исключения

---

При продаже яхты исключаются личные вещи владельца.

---

## Отказ от ответственности

---

Компания предоставляет описание судна или яхты добросовестно, но не может гарантировать точность этой информации, а также не ручается за техническое состояние. Покупатель должен проинструктировать своих агентов или оценщиков исследовать представленную информацию более подробно, по собственному желанию. Продажа судна или яхты, изменение цены или снятие с продажи будет происходить без предварительного уведомления.

# ФОТОГРАФИИ







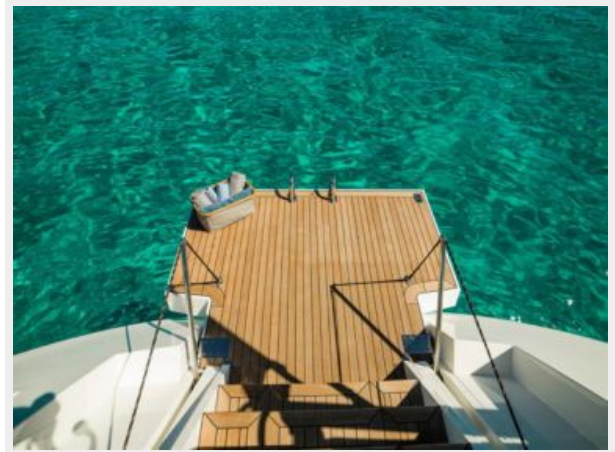

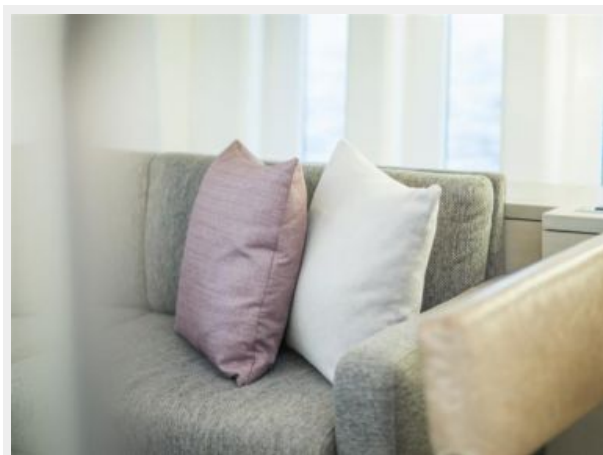
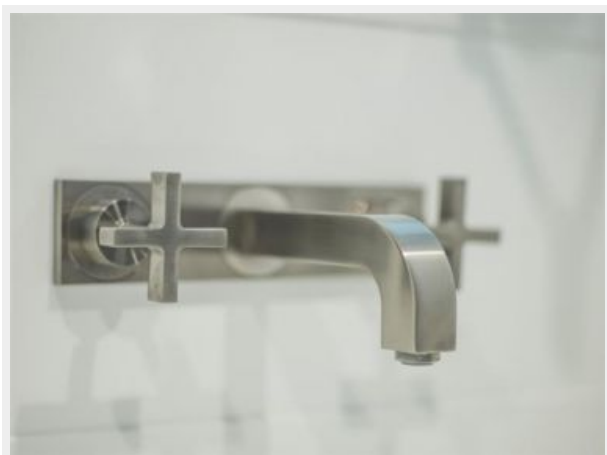

## ENSO GA

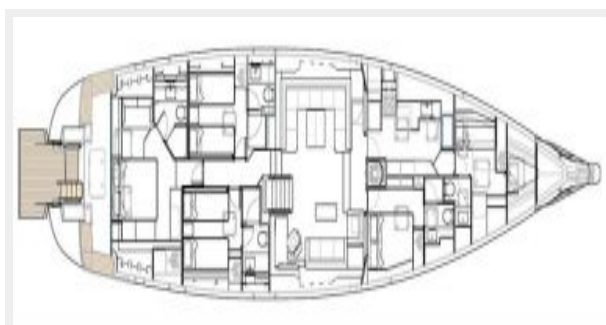

# КОНТАКТЫ

---

Андрей Шестаков (Andrey Shestakov) – ведущий яхтенный брокер отдела продаж яхт и судов компании Shestakov Yacht Sales Inc. Официальный представитель Shestakov Yacht Sales Inc. для русскоговорящих клиентов в центральном офисе компании в Майами/Форт Лодердейл/Флорида/США.

## Контактная информация

---

Email: [andrey@shestakovyachtsales.com](mailto:andrey@shestakovyachtsales.com)

Web: [shestakovyachtsales.com](http://shestakovyachtsales.com)

## Телефоны

---

Краснодарский край: **+7(918)465-66-44**

США, Майами, Флорида: **+1(954)274-4435**

## Время работы

---

Понедельник – Суббота: **9:00 - 21:00**  
EDT

Воскресенье: **Закрето**

## Адрес

---



Harbour Towne Marina, 850 NE 3rd St,  
STE 213, Dania, FL 33004