

## ALTINEL 213' STEEL — ALTINEL SHIPYARDS



**Builder:** ALTINEL SHIPYARDS

**LOA:** 213' 4" (65.00m)

**Year Built:** 2023

**Model:** Mega Yacht

**Price:** PRICE ON APPLICATION

**Location:** Turkey

Our experienced yacht broker, Andrey Shestakov, will help you choose and buy a yacht that best suits your needs **ALTINEL 213' Steel — ALTINEL SHIPYARDS** from our catalogue. Presently, at Shestakov Yacht Sales Inc., we have a wide variety of yachts available on our sale's list. We also work in close contact with all the big yacht manufacturers from all over the world.

If you would like to buy a yacht **ALTINEL 213' Steel — ALTINEL SHIPYARDS** or would like help answering any questions concerning purchasing, selling or chartering a yacht, please call **+1(954)274-4435**

# TABLE OF CONTENTS

TABLE OF CONTENTS	2
SPECIFICATIONS	3
Overview	3
Basic Information	3
Dimensions	3
Accommodations	3
Hull and Deck Information	4
Engine Information	4
DETAILED INFORMATION	5
SUMMARY	5
Exclusions	5
Disclaimer	5
PHOTOS	6
CONTACTS	9
Contact details	9
Telephones	9
Office hours	9
Address	9

# SPECIFICATIONS

## Overview

**Notice:** All pictures, text and information etc, come from our previous experience. It is for giving ideas, there may be changes according to customer wishes.

**Reference (sister) yacht,**

213' (65 m) motor yacht, has a steel hull with an aluminium superstructure with a beam of 11.04m (36'2") and a 3.70m (12'1") draft. She is capable of 17 knots flat out with a range of approx. 6000 nm. from her 190,000 fuel tanks. She offers accommodation for up to 14 guests in 14 suites. She is also capable of carrying up to 18 crew onboard to ensure a relaxed luxury yacht experience.

## KEY FEATURES

- Custom build according to customer prefers
- ABS class Maltese cross, MCA Cayman Island

## Basic Information

**Category:** Mega Yacht

**Model Year:** 2023

**Year Built:** 2023

**Country:** Turkey

**Fly Bridge:** Yes

**Cockpit:** Yes

**Helipad:** Yes

## Dimensions

**LOA:** 213' 4" (65.00m)

## Accommodations

**Total Cabins:** 7

---

## Hull and Deck Information

---

**Hull Material:** Steel

## Engine Information

---

**Engines:** 1

**Manufacturer:** MTU

---

# DETAILED INFORMATION

---

## SUMMARY

---

**Notice:** All pictures, text and information etc, come from our previous experience. It is for giving ideas, there may be changes according to customer wishes.

**Reference (sister) yacht,**

**213' (65 m) motor yacht, has a steel hull with an aluminium superstructure with a beam of 11.04m (36'2") and a 3.70m (12'1") draft. She is capable of 17 knots flat out with a range of approx. 6000 nm. from her 190,000 fuel tanks. She offers accommodation for up to 14 guests in 14 suites. She is also capable of carrying up to 18 crew onboard to ensure a relaxed luxury yacht experience.**

## KEY FEATURES

- **Custom build according to customer prefers**
- **ABS class Maltese cross, MCA Cayman Island**

## Exclusions

---

Owner's personal belongings.

## Disclaimer

---

The Company offers the details of this vessel or yacht in good faith but cannot guarantee or warrant the accuracy of this information nor warrant the condition of the vessel. A buyer should instruct his representatives, agents, or his surveyors, to investigate such details as the buyer desires validated. This vessel or yacht is offered subject to prior sale, price change, or withdrawal without notice.

# PHOTOS





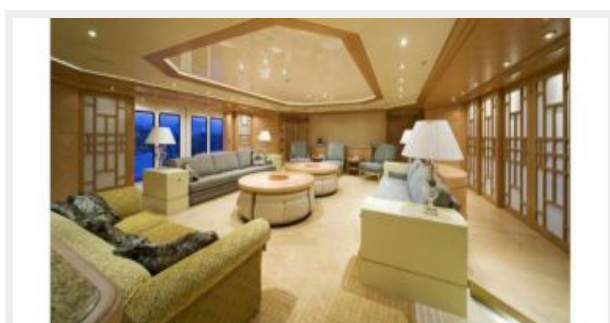

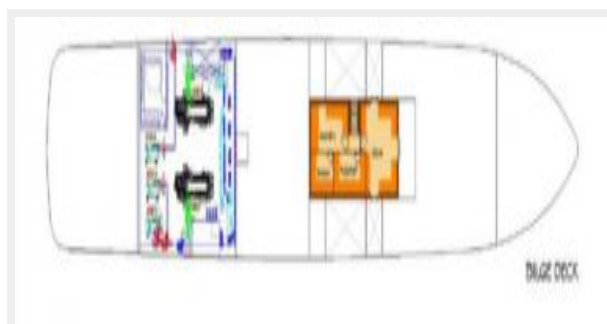
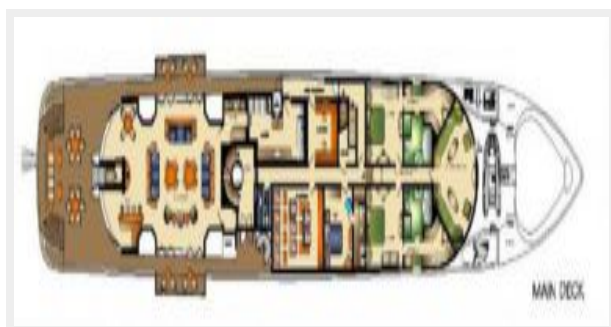



# CONTACTS

---

Andrey Shestakov, leading yacht broker of the sales department of Shestakov Yacht Sales Inc. Shestakov Yacht Sales Inc., the official representative of the Miami/Fort Lauderdale FL headquarters.

## Contact details

---

Email: **andrey@shestakovyachtsales.com**

Web: [shestakovyachtsales.com/en/](http://shestakovyachtsales.com/en/)

## Telephones

---

USA: **+1(954)274-4435**

## Office hours

---

Monday – Saturday: **9:00 - 21:00 EDT**

Sunday: **closed**

## Address

---



Harbour Towne Marina, 850 NE 3rd St,  
STE 213, Dania, FL 33004