

SADO — RIVA



Builder: RIVA

Year Built: 2009

Model: SHELBY

Price: PRICE ON APPLICATION

Location: Turkey

LOA: 52' 11" (16.12m)

Beam: 15' 2" (4.61m)

Min Draft: 0' 0" (0.00m)

Max Draft: 0' 0" (0.00m)

Cruise Speed: 32 Kts. (37 MPH)

Max Speed: 37 Kts. (43 MPH)

Our experienced yacht broker, Andrey Shestakov, will help you choose and buy a yacht that best suits your needs **SADO — RIVA** from our catalogue. Presently, at Shestakov Yacht Sales Inc., we have a wide variety of yachts available on our sale's list. We also work in close contact with all the big yacht manufacturers from all over the world.

If you would like to buy a yacht **SADO — RIVA** or would like help answering any questions concerning purchasing, selling or chartering a yacht, please call **+1(954)274-4435**

TABLE OF CONTENTS

TABLE OF CONTENTS	2
SPECIFICATIONS	3
Overview	3
Basic Information	4
Dimensions	4
Speed, Capacities and Weight	4
Accommodations	4
Hull and Deck Information	4
Engine Information	5
PHOTOS	6
CONTACTS	9
Contact details	9
Telephones	9
Office hours	9
Address	9

SPECIFICATIONS

Overview

Generator: KOHLER / approx 2.340 hours

Staterooms: 3

Water maker: IDROMAR 180 (installed on 08/2015)

Flag: USA / Delaware

Metallic brown color

There are 6 pieces of paint on the boat

The TV had been changed with LCD screen

The pumps are well maintained

Engine services are done season

Antifouling is done for the season

The boat was purchased from Monaco RAM in May 2015

Top speed is 37,5 knots (at half load)

52' Rivale SADO is a luxury yacht, launched and delivered to her original owner by the leading yacht builder Riva yachts in 2009. The brilliantly appointed interior accommodations have a 3-stateroom layout, which accommodates 5 guests and designed for maximum comfort and storage. Her exterior designed by Officina Italiana Design. Her hull and decks are made of composite, with a beam of 15' (4.61m). SADO is powered by 2 MAN engines, SADO has a total of 1800 horsepower.

Basic Information

Category: SHELBY

Sub Category: Motor Yacht

Model Year: 2009

Year Built: 2009

Country: Turkey

Fly Bridge: Yes

Cockpit: Yes

Dimensions

LOA: 52' 11" (16.12m)

LWL: 0' 0" (0.00m)

LOD: 0' 0" (0.00m)

Beam: 15' 2" (4.61m)

Min Draft: 0' 0" (0.00m)

Max Draft: 0' 0" (0.00m)

Clearance: 0' 0" (0.00m)

MFG Length: 0' 0" (0.00m)

Speed, Capacities and Weight

Cruise Speed: 32 Kts. (37 MPH)

Max Speed: 37 Kts. (43 MPH)

Accommodations

Total Cabins: 3

Total Berths: 4

Sleeps: 5

Hull and Deck Information

Hull Material: Composite

Deck Material: Composite

Engine Information

Engines: 2

Manufacturer: MAN

Model: V8

Engine Type: Inboard

Fuel Type: Diesel

PHOTOS



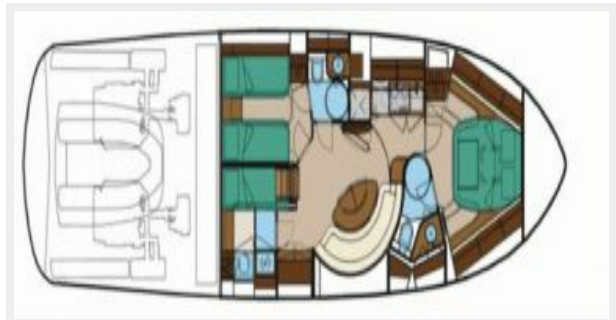



CONTACTS

Andrey Shestakov, leading yacht broker of the sales department of Shestakov Yacht Sales Inc. Shestakov Yacht Sales Inc., the official representative of the Miami/Fort Lauderdale FL headquarters.

Contact details

Email: andrey@shestakovyachtsales.com

Web: shestakovyachtsales.com/en/

Telephones

USA: +1(954)274-4435

Office hours

Monday – Saturday: **9:00 - 21:00** EDT

Sunday: **closed**

Address



Harbour Towne Marina, 850 NE 3rd St,
STE 213, Dania, FL 33004