

## SEASIDE BLONDE — HORIZON



**Builder:** HORIZON

**Year Built:** 2014

**Model:** Catamaran

**Price:** PRICE ON APPLICATION

**Location:** United States

**LOA:** 52' 0" (15.85m)

**Beam:** 22' 0" (6.71m)

**Min Draft:** 4' 4" (1.32m)

**Max Draft:** 4' 6" (1.37m)

**Cruise Speed:** 18 Kts. (21 MPH)

**Max Speed:** 21 Kts. (24 MPH)

Our experienced yacht broker, Andrey Shestakov, will help you choose and buy a yacht that best suits your needs **SEASIDE BLONDE — HORIZON** from our catalogue. Presently, at Shestakov Yacht Sales Inc., we have a wide variety of yachts available on our sale's list. We also work in close contact with all the big yacht manufacturers from all over the world.

If you would like to buy a yacht **SEASIDE BLONDE — HORIZON** or would like help answering any questions concerning purchasing, selling or chartering a yacht, please call **+1(954)274-4435**

# TABLE OF CONTENTS

TABLE OF CONTENTS	2
SPECIFICATIONS	4
Overview	4
Basic Information	10
Dimensions	10
Speed, Capacities and Weight	11
Accommodations	11
Hull and Deck Information	11
Engine Information	11
DETAILED INFORMATION	12
Overview	12
Exclusions	18
Disclaimer	18
PHOTOS	19
SALON	19
GALLEY	19
SALON/GALLEY	19
MASTER	19
MASTER	19
MASTER COMPANIONWAY	19
MASTER HEAD	20
VIP STATEROOM	20
TRANSOM	20
GUEST STATEROOM	20
AFT DECK CONTROLS	20
AFT DECK	20
AFT DECK	21
AFT DECK	21

BOSUN'S LOCKER	21
FLY BRIDGE	21
HELM	21
G/A BRIDGE DECK	21
G/A SALON DECK	22
G/A STATEROOMS	22
CONTACTS	23
Contact details	23
Telephones	23
Office hours	23
Address	23

# SPECIFICATIONS

---

## Overview

---

### A. Hull and Main Structure:

1. White Gelcoat finish for hull above water line, exterior deck, furniture and superstructure.
2. One-piece hull lamination and longitudinal girders
3. Hull is built with licensed process SCRIMP™ for improved strength and less weight
4. High density foam cored construction bottom and topsides
5. Solid fiberglass laminate stem, keel.
6. Main Engine girders with high density foam coring
7. Deck & superstructure foam cored reinforcement for rigidity
8. International anti-fouling bottom paint, w/ anti-osmosis treatment

### B. Exterior Deck and Equipment:

1. Nonskid side and fore deck
2. Teak covered aft deck & Steps.
3. Fiberglass cap rail.
4. S/S rub rail around hull deck joint.
5. Heavy-duty S/S #316 1-1/4" handrail w/1" (stanchions)
6. 10 Mooring cleats on deck.
7. Flag staff on back of flybridge.
8. Fuel and water inlets.
9. Locker for 24V anchor windlass.
10. 50KG ULTRA anchor.
11. 150ft of high tensile 3/8" chain and 150ft warp.
12. Roller for anchor.

### Doors, Hatches, Windows & Port Holes

13. SS sliding salon door.
14. Two bow storage lockers with access through flush FRP deck hatches.
15. 2 x Deck hatches with blinds & screens.
16. Engine access through manual deck hatches in cockpit floor with manual struts.
17. Two large hull side frameless window.
18. Six oval portholes.

### Aft Deck Area

19. FRP Curved seat with cushions at aft. deck.
20. Hi Gloss Teak cockpit table.
21. Comfortable stairs from aft deck to flybridge.
22. Two steps down to dive/swim platform.

23. Cockpit lockers for storage.
24. 2 side boarding doors
25. Second location bases for aft. deck table
26. S/S transom door with Horizon Logo
27. Dimmer switch for Aft. deck ceiling lighting
28. (2) Aft deck engine control stations

## 29. **Swimming Platform Area**

30. Built-in shower with hot/cold water.
31. Swim ladder on STBD side.
32. S/S safety rail on swim platform

### **Light**

33. LED courtesy lights.
34. LED bulwark w/ flush mounted deck lights
35. LED ceiling lights
36. LED white light with 24VDC transformer on Horizon group logo in P&S.
37. Wiring for boat name on transom.
38. AQUA SIGNAL navigation lights.
39. Cockpit down lights.

## **C. Flybridge:**

1. Non-skid flybridge cambered deck with ample drainage.
2. Helm station with stainless wheel and instrument console.
3. Single STIDD helm chair
4. FRP Arch & FRP Hardtop.
5. Wet bar package:
  - FRP module bar with sink, with hot and cold water.
  - DC fridge in bar.
6. FRP table with seating.
7. Sunning bed/ Bench Seat stb side of helm console with cushions
8. Ample locker space for storage.
9. Upgraded ES1500 Steelhead Crane
10. Covers for F/B Seating and console
11. Covers for aft deck seating, aft deck table and flybridge Table
12. Coffee table (Burlwood) that converts into dining table
13. (3) Overhead skylight/port hatches

## **E. Engine Room and Equipments:**

1. Sound and heat insulated compartments
2. Delta –T Moisture eliminators for engine rooms.

3. DC 24Volt lights.
4. One AC outlet.

## **F. Electrical system:**

### **General**

1. Color-coded wiring for easy identification.
2. Premium DC distribution board with switches, voltmeter and amp meter.
3. Outlets in Salon / bar / galley / cabins / fly-bridge / aft deck / engine room.
4. Vimar switches for lights and electrical outlets.

### **AC/DC Main Power System**

5. AC power supply from generator / shore power.
6. Selector switch for AC power supply.
7. Remote panel for generator.
8. Four AGM Batteries for engine & generator start up. (New Feb 2019)
9. Two AGM Batteries for ship's service power. (New Feb 2019)
10. Bow thruster batteries (New Feb 2019)
11. BEP battery switch.
12. One battery charger for all batteries.
13. One inverter 3.0 KW.
14. Premium AC panel with switches

### **Shore Power System**

15. Glendenning shore power 50Amp connector with 100ft cord.

## **G. Mechanical system:**

### **Fuel and Lube Oil System**

1. Dual Racor Upgraded 900FG filters for both engines.
2. Upgraded External mounted Oil Filter on Generator
3. One oil change pump for engines, generator and Gearboxes.

### **Fresh Water System**

4. 270 Gal of water tank integral to hull.
5. Color coded piping for easy identification.
6. Marine grade lines for fresh water system
7. One 17 Gal/110V or 220V water heater.
8. 2 x High volume 24V fresh water pumps with accumulator tank.
9. Fresh water washdown for anchor.
10. Fresh Water Washdown on Aft Deck.
11. Fresh water Washdown for Flybridge

12. 170 Gal extra fuel tank with extra fuel transfer pump and gauge

### **Sanitary System**

13. 2 x 30 Gal of holding tank integral to hull
14. Electric fresh water flush toilets, pumps with Y valve for automatic discharge. and dock side pump out (2).

### **Bilge Water System**

15. 4x electric 24V bilge pumps.
16. High level bilge water alarm.

### **Fire Safety System**

17. One Seafire automatic/manual fire extinguisher in each engine room.

### **Air Conditioning System**

18. Marine Air —central air conditioning for each cabins and salon.
19. Air Cond. Self cleaning system
20. Hyd. Trim tab system

## **H. Interior Design and Equipment:**

### **Interior Finish**

1. HardWood flooring.
2. Tempered safety glass windows.
3. Soft furnishings including roman blinds and accent wood finishing.
4. Electric blinds in salon
- 5.

### **Heads and Showers General**

6. Upgraded to Corian floor.
7. Corian countertops.
8. Fabric blind over large window.
9. Portlights for ventilation.
10. Basin, cabinets and mirrors.
11. Walk-in separate shower.
12. Linen Cupboard inboard of the M/S shower.
13. Separate toilet.
14. Lights in Overhead.
15. Extractor fan.

### **Salon**

16. Salon seating covered in fabric.
17. Burl Wood coffee table which lifts to dinning Table.
18. Cabinet for Crystal Glasses.
19. Electric Pop up TV.
20. Office desk with Garmin 8212 Screen
21. Two hatches with screen on top of salon roof

### **Galley/ Dinette**

22. Wood floor.
23. Granite counter tops.
24. Double sinks with tap.
25. Custom accent wood carpentry.
26. Custom wooden carpentry for galley, cupboards and counters.
27. Cutlery & crockery drawers.
28. Pot drawer & spice drawers.
29. Additional storage drawers and cupboards.
30. Sub Zero 700TCI Fridge with 2 freezer drawers.
31. Fischer Paykel Dishwasher

### **VIP stateroom:**

32. Queen bed, semi walk around.
33. Custom wood accent carpentry.
34. Carpeted floor
35. Deck hatch with screen & opening.
36. Fabric blind over large window.
37. Soft furnishings.
38. Night stands with light switches and outlets.

### **Port Aft guest stateroom:**

39. Custom wood accent carpentry.
40. Carpeted floor.
41. Opening port lights in hull side.
42. Soft furnishings.
43. Queen size Bed
44. Storage beneath bed.
45. Cabin lights.
46. Shared bathroom with VIP cabin.

### **Master Stateroom**

47. Custom carpentry for accent finishing.
48. Carpeted floor.
49. Deck hatch with screen & opening.



50. Fabric blinds over large window
51. Queen size bed, semi walk around.
52. Large full height closets.
53. Closets for linens / towels and clothes.
54. Cabin lights.
55. Garmin 8212 Screen next to Bed
56. Night stands with light switches and outlets.

### **Galley**

57. GE- 4 burner Elec. cook top.
58. Extractor over cooktop.
59. GE Microwave / Convection oven.
60. Sub Zero 700TCI refrigerator w/ freezer and Icemaker.

### **1. Navigation & Instrumentation: & Audio Video Equipment:**

1. 2 x Garmin 8617 17" touch screen chart plotter with GPS antenna on Flybridge. (New Feb 2018)
2. 1 x Garmin 8212 12" touch screen in Salon
3. 1 x Garmin 8212 12" touch screen in Master Cabin
4. Garmin Auto pilot.
5. Garmin GMR 424 4ft open array 72 mile radar.
6. 2 x Garmin GSD 26 Depth transducers.
7. Additional GM120 display
8. Garmin VHF 300 on flybridge.
9. Garmin VHF 300 in Salon
10. Garmin XM weather and Radio.
11. ACR RCI 100D Spotlight on Flybridge
12. 2 Garmin Engine Room Cameras in each engine compartment and 1 x Aft Deck Camera
13. Fusion UD750 Stereo on Flybridge
14. Sirius XM Module and Antenna
15. Fusion 51600 Amp
16. JL Audio Sub woofer & 6 x 7" JL Audio Speakers on Flybridge
17. Sonos Connect on Flybridge
18. Sonos Connect on Aft Deck with 2 x 7" JL Audio Speakers
19. Sonos Connect on Bow with 2 x 7" JL Audio Speakers
20. Sonos Playbar in Salon with 2 x Play 1 speakers and Sub woofer
21. Cisco Linksys router in Salon
22. Sonos Playbar in Master Cabin
23. 48" Samsung LED TV in Salon
24. 32" Samsung LED TV in Master (New Feb 2018)
25. 32" Samsung LED TV in VIP
26. 32" SKYVUE TV on Aft Deck
27. KVH HD7 Satellite TV with Dummy Dome

28. Apple TV in salon, master, aft deck, and fly bridge
29. Bluray in Salon and Master
30. Sat TV displays on Flybridge Garmin
31. Garmin Displays on Salon TV
32. Wave WiFi Internet
33. Fusion audio control on aft deck
34. Cradlepoint Cellular Internet

1. **1. Additional Equipment:**

1. Fixed Aft Deck Awning
2. Bow Bimini with Deck Cushions
3. Custom Salon and Flybridge Tables
4. Direct TV wired to Flybridge Garmin 17" Screen and Fusion Speakers.
5. Plumbed High Pressure washer in Foredeck Locker
6. Flybridge Clear Enclosure which encompass the Stairs
7. External Generator Oils filter kits
8. 1400 Gal/day Water-maker
9. 3<sup>rd</sup> Cabin is a queen bed

## Basic Information

---

**Category:** Catamaran

**Model Year:** 2015

**Year Built:** 2014

**Refit Year:** 2018

**Country:** United States

**Fly Bridge:** Yes

## Dimensions

---

**LOA:** 52' 0" (15.85m)

**Beam:** 22' 0" (6.71m)

**Min Draft:** 4' 4" (1.32m)

**Max Draft:** 4' 6" (1.37m)

---

## Speed, Capacities and Weight

---

**Cruise Speed:** 18 Kts. (21 MPH)

**Cruise Speed RPM:** 3000 Kts.

**Cruise Speed Range:** 400

**Max Speed:** 21 Kts. (24 MPH)

**Max Speed RPM:** 3350 Kts.

**Max Speed Range:** 300 Kts.

**Displacement:** 65000 Pounds

**Fuel Capacity:** 1000 Gallons

---

## Accommodations

---

**Total Cabins:** 3

**Total Berths:** 3

**Sleeps:** 6

**Total Heads:** 2

---

## Hull and Deck Information

---

**Hull Material:** Advanced Composites

**Deck Material:** Composite Fiberglass

**Hull Configuration:** Catamaran

**Hull Color:** White

**Hull Finish:** Fiberglass

**Hull Designer:** Angelo Lavranos

---

## Engine Information

---

**Engines:** 2

**Manufacturer:** Cummins

**Model:** QSB 6.7

**Engine Type:** Inboard

**Fuel Type:** Diesel

---

# DETAILED INFORMATION

---

## Overview

---

### A. Hull and Main Structure:

1. White Gelcoat finish for hull above water line, exterior deck, furniture and superstructure.
2. One-piece hull lamination and longitudinal girders
3. Hull is built with licensed process SCRIMP™ for improved strength and less weight
4. High density foam cored construction bottom and topsides
5. Solid fiberglass laminate stem, keel.
6. Main Engine girders with high density foam coring
7. Deck & superstructure foam cored reinforcement for rigidity
8. International anti-fouling bottom paint, w/ anti-osmosis treatment

### B. Exterior Deck and Equipment:

1. Nonskid side and fore deck
2. Teak covered aft deck & Steps.
3. Fiberglass cap rail.
4. S/S rub rail around hull deck joint.
5. Heavy-duty S/S #316 1-1/4" handrail w/1" (stanchions)
6. 10 Mooring cleats on deck.
7. Flag staff on back of flybridge.
8. Fuel and water inlets.
9. Locker for 24V anchor windlass.
10. 50KG ULTRA anchor.
11. 150ft of high tensile 3/8" chain and 150ft warp.
12. Roller for anchor.

### Doors, Hatches, Windows & Port Holes

13. SS sliding salon door.
14. Two bow storage lockers with access through flush FRP deck hatches.
15. 2 x Deck hatches with blinds & screens.
16. Engine access through manual deck hatches in cockpit floor with manual struts.
17. Two large hull side frameless window.
18. Six oval portholes.

### Aft Deck Area

19. FRP Curved seat with cushions at aft. deck.
20. Hi Gloss Teak cockpit table.
21. Comfortable stairs from aft deck to flybridge.
22. Two steps down to dive/swim platform.

23. Cockpit lockers for storage.
24. 2 side boarding doors
25. Second location bases for aft. deck table
26. S/S transom door with Horizon Logo
27. Dimmer switch for Aft. deck ceiling lighting

### **Swimming Platform Area**

28. Built-in shower with hot/cold water.
29. Swim ladder on STBD side.
30. S/S safety rail on swim platform

### **Light**

31. LED courtesy lights.
32. LED bulwark w/ flush mounted deck lights
33. LED ceiling lights
34. LED white light with 24VDC transformer on Horizon group logo in P&S.
35. Wiring for boat name on transom.
36. AQUA SIGNAL navigation lights.
37. Cockpit down lights.

## **C. Flybridge:**

1. Non-skid flybridge cambered deck with ample drainage.
2. Helm station with stainless wheel and instrument console.
3. Single STIDD helm chair
4. FRP Arch & FRP Hardtop.
5. Wet bar package:
  - FRP module bar with sink, with hot and cold water.
  - DC fridge in bar.
6. FRP table with seating.
7. Sunning bed/ Bench Seat stb side of helm console with cushions
8. Ample locker space for storage.
9. Upgraded ES1500 Steelhead Crane
10. Covers for F/B Seating and console
11. Covers for aft deck seating, aft deck table and flybridge Table

## **E. Engine Room and Equipments:**

1. Sound and heat insulated compartments
2. Delta –T Moisture eliminators for engine rooms.
3. DC 24Volt lights.
4. One AC outlet.

## **F. Electrical system:**

## General

1. Color-coded wiring for easy identification.
2. Premium DC distribution board with switches, voltmeter and amp meter.
3. Outlets in Salon / bar / galley / cabins / fly-bridge / aft deck / engine room.
4. Vimar switches for lights and electrical outlets.

### AC/DC Main Power System

5. AC power supply from generator / shore power.
6. Selector switch for AC power supply.
7. Remote panel for generator.
8. Four AGM Batteries for engine & generator start up. (New Feb 2019)
9. Two AGM Batteries for ship's service power. (New Feb 2019)
10. BEP battery switch.
11. One battery charger for all batteries.
12. One inverter 3.0 KW.
13. Premium AC panel with switches

### Shore Power System

14. Glendenning shore power 50Amp connector with 100ft cord.

## G. Mechanical system:

### Fuel and Lube Oil System

1. Dual Racor Upgraded 900FG filters for both engines.
2. Upgraded External mounted Oil Filter on Generator
3. One oil change pump for engines, generator and Gearboxes.

### Fresh Water System

4. 270 Gal of water tank integral to hull.
5. Color coded piping for easy identification.
6. Marine grade lines for fresh water system
7. One 17 Gal/110V or 220V water heater.
8. 2 x High volume 24V fresh water pumps with accumulator tank.
9. Fresh water washdown for anchor.
10. Fresh Water Washdown on Aft Deck.
11. Fresh water Washdown for Flybridge
12. 170 Gal extra fuel tank with extra fuel transfer pump and gauge

### Sanitary System

13. 2 x 30 Gal of holding tank integral to hull
14. Electric fresh water flush toilets, pumps with Y valve for automatic discharge. and dock side

pump out (2).

### **Bilge Water System**

15. 4x electric 24V bilge pumps.
16. High level bilge water alarm.

### **Fire Safety System**

17. One Seafire automatic/manual fire extinguisher in each engine room.

### **Air Conditioning System**

18. Marine Air –central air conditioning for each cabins and salon.
19. Air Cond. Self cleaning system
20. Hyd. Trim tab system

## **H. Interior Design and Equipment:**

### **Interior Finish**

1. HardWood flooring.
2. Tempered safety glass windows.
3. Soft furnishings including roman blinds and accent wood finishing.

### **Heads and Showers General**

4. Upgraded to Corian floor.
5. Corian countertops.
6. Fabric blind over large window.
7. Portlights for ventilation.
8. Basin, cabinets and mirrors.
9. Walk-in separate shower.
10. Linen Cupboard inboard of the M/S shower.
11. Separate toilet.
12. Lights in Overhead.
13. Extractor fan.

### **Saloon**

14. Salon seating covered in fabric.
15. Burl Wood coffee table which lifts to dinning Table.
16. Cabinet for Crystal Glasses.
17. Electric Pop up TV.
18. Office desk with Garmin 8212 Screen
19. Two hatches with screen on top of salon roof

### **Galley/ Dinette**

20. Wood floor.
21. Granite counter tops.
22. Double sinks with tap.
23. Custom accent wood carpentry.
24. Custom wooden carpentry for galley, cupboards and counters.
25. Cutlery & crockery drawers.
26. Pot drawer & spice drawers.
27. Additional storage drawers and cupboards.
28. Under counter trash drawer.
29. Sub Zero 700TCI Fridge with 2 freezer drawers.
30. Fischer Paykel Dishwasher

**VIP stateroom:**

31. Queen bed, semi walk around.
32. Custom wood accent carpentry.
33. Carpeted floor
34. Deck hatch with screen & opening.
35. Fabric blind over large window.
36. Soft furnishings.
37. Night stands with light switches and outlets.

**Port Aft guest stateroom:**

38. Custom wood accent carpentry.
39. Carpeted floor.
40. Opening port lights in hull side.
41. Soft furnishings.
42. Queen size Bed
43. Storage beneath bed.
44. Cabin lights.
45. Shared bathroom with VIP cabin.

**Master Stateroom**

46. Custom carpentry for accent finishing.
47. Carpeted floor.
48. Deck hatch with screen & opening.
49. Fabric blinds over large window
50. Queen size bed, semi walk around.
51. Large full height closets.
52. Closets for linens / towels and clothes.
53. Cabin lights.
54. Garmin 8212 Screen next to Bed
55. Night stands with light switches and outlets.



## Galley

- 56. GE- 4 burner Elec. cook top.
- 57. Extractor over cooktop.
- 58. GE Microwave / Convection oven.
- 59. Sub Zero 700TCI refrigerator w/ freezer and Icemaker.

### 1. Navigation & Instrumentation: & Audio Video Equipment:

- 1. 2 x Garmin 8617 17" touch screen chart plotter with GPS antenna on Flybridge. (New Feb 2019)
- 2. 1 x Garmin 8212 12" touch screen in Salon
- 3. 1 x Garmin 8212 12" touch screen in Master Cabin
- 4. Garmin Auto pilot.
- 5. Garmin GMR 424 4ft open array 72 mile radar. (New Feb 2019)
- 6. 2 x Garmin GSD 26 Depth transducers.
- 7. Additional GM120 display
- 8. Garmin VHF 300 on flybridge.
- 9. Garmin VHF 300 in Salon
- 10. Garmin XM weather and Radio.
- 11. ACR RCI 100D Spotlight on Flybridge
- 12. 2 x Garmin Engine Room Cameras and 1 x Aft Deck Camera
- 13. Fusion UD750 Stereo on Flybridge
- 14. Sirius XM Module and Antenna
- 15. Fusion 51600 Amp
- 16. JL Audio Sub woofer & 4 x 7" JL Audio Speakers on Flybridge
- 17. Sonos Connect on Flybridge
- 18. Sonos Connect on Aft Deck with 2 x 7" JL Audio Speakers
- 19. Sonos Connect on Bow with 2 x 7" JL Audio Speakers
- 20. Sonos Playbar in Salon with 2 x Play 1 speakers and Sub woofer
- 21. Cisco Linksys router in Salon
- 22. Sonos Playbar in Master Cabin
- 23. 48" Samsung LED TV in Salon
- 24. 32" Samsung LED TV in Master
- 25. 32" Samsung LED TV in VIP
- 26. 24" Samsung LED TV in 3<sup>rd</sup> Stateroom
- 27. 32" SKYVUE TV on Aft Deck
- 28. KVH HD7 Satellite TV with Dummy Dome
- 29. Apple TV in all Cabins
- 30. Bluray in Salon and Master
- 31. Sat TV displays on Flybridge Garmin
- 32. Garmin Displays on Salon TV
- 33. Wave WiFi Internet
- 34. Cradlepoint Cellular Internet

---

### 1. 1. **Additional Equipment:**

1. Fixed Aft Deck Awning
2. Bow Bimini with Deck Cushions
3. Custom Salon and Flybridge Tables
4. Direct TV wired to Flybridge Garmin 17" Screen and Fusion Speakers.
5. Plumbed High Pressure washer in Foredeck Locker
6. Flybridge Clear Enclosure which encompass the Stairs
7. External Generator Oils filter kits
8. 1400 Gal/day Water-maker
9. 3<sup>rd</sup> Cabin is a queen bed

## **Exclusions**

---

Owner's personal belongings.

## **Disclaimer**

---

The Company offers the details of this vessel or yacht in good faith but cannot guarantee or warrant the accuracy of this information nor warrant the condition of the vessel. A buyer should instruct his representatives, agents, or his surveyors, to investigate such details as the buyer desires validated. This vessel or yacht is offered subject to prior sale, price change, or withdrawal without notice.

# PHOTOS

**SALON****GALLEY****SALON/GALLEY****MASTER****MASTER****MASTER COMPANIONWAY**

**MASTER HEAD****VIP STATEROOM****GUEST STATEROOM****TRANSOM****AFT DECK CONTROLS****AFT DECK**

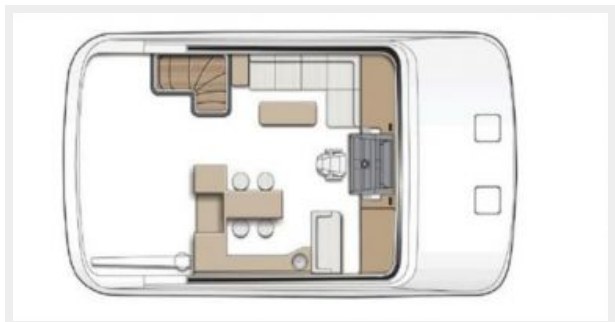

**AFT DECK****AFT DECK****BOSUN'S LOCKER****FLY BRIDGE****HELM****G/A BRIDGE DECK**

G/A SALON DECK

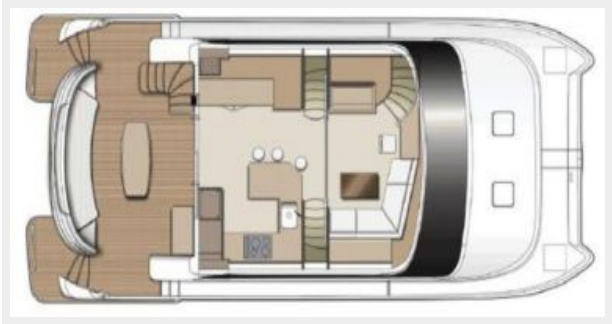

G/A STATEROOMS



# CONTACTS

---

Andrey Shestakov, leading yacht broker of the sales department of Shestakov Yacht Sales Inc. Shestakov Yacht Sales Inc., the official representative of the Miami/Fort Lauderdale FL headquarters.

## Contact details

---

Email: **andrey@shestakovyachtsales.com**

Web: [shestakovyachtsales.com/en/](https://shestakovyachtsales.com/en/)

## Telephones

---

USA: **+1(954)274-4435**

## Office hours

---

Monday – Saturday: **9:00 - 21:00 EDT**

Sunday: **closed**

## Address

---



Harbour Towne Marina, 850 NE 3rd St,  
STE 213, Dania, FL 33004