

ТОPAZ — HALLBERG-RASSY



Судостроитель: HALLBERG-RASSY

Год постройки: 1972

Модель: Sloop

Цена: ЦЕНА ЯХТЫ ПО ЗАПРОСУ

Местонахождение: United States

Длина общая: 35' 0" (10.67m)

Ширина: 10' 0" (3.05m)

Мин. осадка: 4' 3" (1.30m)

Макс. осадка: 4' 3" (1.30m)

Крейс. скорость: 7 Kts. (8 MPH)

Макс. скорость: 8 Kts. (9 MPH)

Купить **Topaz — HALLBERG-RASSY** а также выбрать подходящую вам яхту из нашего каталога яхт вам поможет опытный яхтенный брокер Андрей Шестаков. На сегодняшний день компания **Shestakov Yacht Sales Inc.** имеет большое количество яхт в собственном списке продаж, а также тесно сотрудничает со всеми крупными яхтенными производителями по всему миру.

Для того чтобы купить яхту **Topaz — HALLBERG-RASSY** а также проконсультироваться по любому вопросу связанному с покупкой, продажей, чартером яхт позвоните по телефону **+7(918)465-66-44**.

ОГЛАВЛЕНИЕ

ОГЛАВЛЕНИЕ	2
ХАРАКТЕРИСТИКИ	4
Обзор	4
Основная информация	4
Размеры	4
Скорость, вместимость и масса	4
Размещение	5
Корпус и палуба	5
Информация о двигателе	5
ПОДРОБНОЕ ОПИСАНИЕ	6
Main Description	6
MEDIA	6
Upgrades	6
Walkthrough	6
Accomodations	8
Main cabin	9
NAV STATION	9
Galley	9
Head	10
Cockpit	10
Helm	10
INST. STATION	10
Rig	11
Sails & Canvas	11
Deck & Hull	11
Mechanical	11
Electrical	11
Safety	12

Dinghy	12
EQUIP. & SPARE	12
Disclaimer	12
Исключения	13
Отказ от ответственности	13
ФОТОГРАФИИ	14
КОНТАКТЫ	29
Контактная информация	29
Телефоны	29
Время работы	29
Адрес	29

ХАРАКТЕРИСТИКИ

Обзор

Designed for long distance cruising the Rasmus 35 has numerous circumnavigations to her credit and remains a practical choice for extended voyaging and local cruising alike. Considered Hallberg-Rassy's first production sailboat, the Rasmus 35 was well ahead of her time and with 760 hulls produced, one of the most popular models to come from the legendary Swedish boat builder. The high quality build and thoughtful design are evident throughout Topaz. She has been well maintained and has withstood the test of time, showing remarkably well for a boat of her vintage. With all systems operational, ample storage and accommodations for six across three mahogany lined cabins, Topaz is ready to carry you across the waves on adventures far and wide.

Основная информация

Тип судна: Sloop

Модельный год: 1972

Год постройки: 1972

Страна: United States

Размеры

Длина общая: 35' 0" (10.67m)

Длина по ватерлинии: 27' 7" (8.41m)

Ширина: 10' 0" (3.05m)

Мин. осадка: 4' 3" (1.30m)

Макс. осадка: 4' 3" (1.30m)

Трапы: 44' 6" (13.56m)

Скорость, вместимость и масса

Крейс. скорость: 7 Kts. (8 MPH)

Макс. скорость: 8 Kts. (9 MPH)

Вместимость воды: 75 Gallons

Вместимость сточного бака: 37 Gallons

Объем топливного бака: 45 Gallons

Размещение

Всего кают: 3

Всего ком. состава: 1

Корпус и палуба

Материал корпуса: Fiberglass

Информация о двигателе

Двигатели: 1

Производитель: Yanmar

Модель: 4JH2E

Тип двигателя: Inboard

Тип топлива: Diesel

ПОДРОБНОЕ ОПИСАНИЕ

Main Description

Designed for long distance cruising the Rasmus 35 has numerous circumnavigations to her credit and remains a practical choice for extended voyaging and local cruising alike. Considered Hallberg-Rassy's first production sailboat, the Rasmus 35 was well ahead of her time and with 760 hulls produced, one of the most popular models to come from the legendary Swedish boat builder. The high quality build and thoughtful design are evident throughout Topaz. She has been well maintained and has withstood the test of time, showing remarkably well for a boat of her vintage. With all systems operational, ample storage and accommodations for six across three mahogany lined cabins, Topaz is ready to carry you across the waves on adventures far and wide.

MEDIA

To view media files of the Topaz type or cut and paste these links (case sensitive) into your web browser: Video Tour: 360 Photos: Photo Slide Show: Manufacture's Sales Brochure: Manufacturer's Information Sheet:

Upgrades

- Plumbing replaced - 2008-2010 - Wiring replaced - 2008-2010 - Winches replaced/ upgraded - 2008-2010 - Hot water heater installed - 2011 - Cockpit shower installed - 2011 - Air-conditioning installed - 2011 - Roller fuller replaced - 2014 - Dingy davits installed - 2017 - Bilge pump replaced - 2019

Walkthrough

COCKPIT: The well protected center-cockpit features a fixed windscreen with hard top covering the forward third of the cockpit, shielding the instrument station and salon companionway from the elements. A Bimini top with side curtains (not pictured) completes the cockpit enclosure when installed. A center mounted pedestal helm with a stainless steel wheel, compass and engine throttle/gear shift is located in the aft section of the cockpit. Seating for up to seven people is provided by a bench seat extending from the forward bulkhead 280 degrees around the cockpit. Large under bench lockers are found on the starboard side forward and port side aft. A propane locker found under the starboard bench aft and a stainless steel cooler locker is located under the port bench forward. There is a swim shower under the starboard bench aft. A starboard offset companionway leading to the salon is found on the forward bulkhead. A Datamarine CD400 Depth Gauge and a Rieker Degree of Heal Gauge are mounted on the forward bulkhead starboard of the companionway. There is a instrument station to port of the companionway. A

Garman 3210 GPSmap Chartplotter is top mounted at the station, with a Raymarine ST6002 Autohelm control panel and Uniden handheld VHS mount found underneath on the starboard side of the station. The Yanmar engine control panel is mounted underneath on the port side. A fuel gauge and volt meter are located to starboard of the Yanmar control panel. Two Lewmar 40 2-Speed self-tailing winches are mounted on the port and starboard cockpit coaming for jib trim, with the mainsheet mounted behind the cockpit on the aft cabin top. The cockpit is completed by a starboard offset aft companionway leading to the aft cabin. TOPSIDES: Moving forward the deck features raised, teak capped gunwales. The deck is protected by stainless steel bow and stern railings connected by dual lifelines running the length of the deck port and starboard; gates are found midship, port and starboard. An anchor locker is found at the bow, with a Fortress FX-23 anchor mounted at the bow. There is a Lewmar electric windless deck mounted aft of the anchor locker. Teak hand rails run along the cabin top, port and starboard, with stainless steel hand rails found on the sides of the cockpit hard top. Two opening hatches and two Dorade vents are found on the cabin top. Foresail car tracks are found on the port and starboard side decks. There are 2 cleats at the bow, two midship and two at the stern, port and starboard. Flush deck water, waste and fuel fills are found on the side decks port and starboard, with a 30 amp electric plug mounted on the outside of the starboard cockpit coaming. Dingy davits and a swim ladder are found at the stern, with a Lehr propane outboard engine mounted on the starboard side of the stern rail, and a life sling overboard rescue system and gps antenna are mounted on the port side. The emergency tiller is center mounted on the stern deck. The single spreader rig features gold anodized Selden spars. The mast is stepped on the cabin top and supported below by a bulkhead. The halyards are managed with two Lewmar 16 two speed winches mounted on the on the port and starboard sides of the mast. The rig is completed by a Harken roller furler, mechanical boom vang and lazy jacks. A Forespar 25' extendable whisker pole is secured to the port cabin-top hand hold. MAIN CABIN: With mahogany joinery throughout the interior, the main cabin is a warm and inviting space. Entering from the cockpit companionway, the nav station is found immediately to starboard with the galley extending forward along the starboard side of the cabin. Opposite on the port side there is a U-shaped settee & table with seating for 6, which converts into a double berth. A shelf is found behind the settee along the port side, with storage lockers above. An open top storage compartment is found on the aft bulkhead behind the settee, and additional storage compartments are located underneath the settee. There are five overhead lights in the salon, 2 mounted over the settee, one over the galley, one over the nav station and one overhead center. Two overhead teak grab rails run fore & aft on the port and starboard sides. Ventilation is provided by the companion way, an overhead opening hatch and two fans. Two fixed port/windows with shades run along the side of the cabin, one port and one starboard. A barometer, fire extinguisher and air-conditioning/heat registers are mounted on the port aft bulkhead. A flat screen TV is mounted in the aft starboard corner of the salon over the nav station. GALLEY: The galley runs along the starboard side of the main salon. There is a working counter with removable inserts over the sink and the stove/oven. A locker with sliding doors runs the length of the galley behind the countertop with additional storage provided by three under counter lockers and four drawers. The oven/cook top is found under the counter toward the stern followed by a stainless steel sink w/hot and cold running water and an under counter refrigerator forward toward the bow. The galley is completed by an light mounted above the sink. NAV STATION: The nav station is found starboard of the companionway and features a forward facing

seat with a lift top table/countertop. The nav station includes a Uniden ES VHF radio, the DC and AC electrical control panels, MarineAir control panel, Xintex Propane/CNG Fume Detector and Control System, two 110 VAC outlets, two 12 VDC outlets and an overhead light. HEAD: The dual head/shower is found forward of the salon on the port side, opposite a locker area and companionway leading to the forward cabin. The head features a counter top with a stainless steel sink along the forward bulkhead. A hot and cold spigot/shower head is mounted next to the sink with a bracket overhead for use when showering. A mirror is mounted above the counter, with a storage locker and storage cubie underneath. The manual Jabsco marine head is found on the port side. There is a storage locker and cubie on the port side behind the head with a final storage locker found on the port side above the counter. There is one fixed port/window on the port side. A light and dorade vent are found overhead. Finally there is a towel rack mounted on the aft bulkhead. FORWARD CABIN: With mahogany joinery and paneling the private forward cabin can be closed off from the rest of the yacht with a pocket door, or the space can be extended to include the head and companionway by swinging the head door 90 degrees into a second doorframe to close off the salon area. The cabin features a V-Berth for two with two drawers and a storage locker below. Additional storage is provided by shelves running the length of the cabin, port and starboard. Finally, there is a large hanging locker on the starboard side of the companionway opposite the head. There are two reading lights mounted on the aft bulkhead, port and starboard, with a fan and A/C register mounted on the aft bulkhead, port side. A dual use shelf/ladder is also mounted on the aft bulkhead below an overhead opening hatch. There is an overhead light and dorade vent in the companionway above the hanging locker. The forward cabin is completed by two fixed port/windows with shades, one each on the port and starboard side. AFT CABIN: The aft cabin is located behind the cockpit in the stern of the boat and is accessible through a companionway/hatch in aft section of the cockpit. The cabin is surprisingly roomy and again features the fine mahogany interior found throughout the yacht. Accommodations in the cabin can be configured as two single berths or a queen berth. Shelving runs along the cabin on the port and starboard sides. A fire extinguisher and AC register are found mounted on the forward bulkhead port and starboard. There are two reading lamps mounted port and starboard on the aft bulkhead, with an additional light mounted overhead, center. There are three fixed port/windows, one each port, starboard and stern. Storage is provided by cubies behind the stairs and a locker on the forward bulkhead, plus two additional lockers at the aft bulkhead. Additional storage is found under the berths. ENGINE COMPARTMENT: The engine compartment is found under the cockpit deck.

Accomodations

FORWARD CABIN: The forward cabin is located ahead of the salon and head and features: - Private cabin with a pocket door, that can be expanded to include the head and companionway with the dual head/salon door - Mahogany joinery paneling throughout - Solid mahogany sole - V-berth w/Insert (sleeps 2) - 2 Drawers under the berth - Storage locker under the starboard side v/berth - Hanging locker in the companionway, opposite the head - 2 Aft bulkhead mounted reading lights; port & starboard; 12 vdc - 1 Overhead light; in companionway; 12 vdc - Aft bulkhead mounted Hella-turbo fan; starboard side; 12 vac - Aft bulkhead mounted A/C register;

starboard side - Aft bulkhead mounted shelf/ladder - Opening overhead hatch - 2 Fixed port/windows w/shades; port and starboard - 1 Fixed port/window, in companionway above hanging locker; starboard side - Holding tank; under the v-berth, port side - Overhead dorade vent; in companionway - Headroom: 69.5" AFT CABIN: The aft cabin is located behind the cockpit at the stern and is accessed via a companionway/hatch in the back of the cockpit and includes: - Mahogany joinery paneling throughout - Solid mahogany sole - Berth for 2 people - 3 fixed port/windows w/shades; port, starboard and aft - Overhead light; 12 vdc - 2 Reading lights; 12 vdc aft bulkhead port and starboard - Under berth storage lockers - Forward bulkhead storage locker - 2 aft bulkhead storage lockers - Under stair storage - A/C register; forward bulkhead, port side - Headroom: 53" SALON SETTEE: - Settee convert to a double berth

Main cabin

The main cabin is entered from the cockpit, four steps down via a starboard offset companionway and features: - Mahogany joinery paneling throughout - Solid mahogany sole - Starboard settee; seats 6; converts to a double berth - Mahogany dining table - Shelving with storage lockers above running length of salon on the starboard side - Open top storage compartment at aft bulkhead, behind settee - Storage compartments under settee - Sharp flat screen TV; mounted above nav station; aft starboard corner - Selsi Barometer, aft bulkhead mounted, port side - Stickler thermometer; forward bulkhead mounted, port side - 2 Fire extinguishers, aft and forward bulkhead mounted, port side - A/C register and intake, aft bulkhead mounted, port side - 2 Hela turbo fans, 12 vdc, forward bulkhead mounted, port and starboard - Nav station; aft corner, starboard side - Galley; extending forward of nave station to forward bulkhead, starboard side - 2 Fixed port/windows w/shades, one port one starboard - Overhead opening hatch, center mounted - 2 Overhead teak grab rails; port & starboard - Overhead light; 12 vdc; cabin center - 2 Overhead lights; 12 vdc; above settee - 1 Overhead light; 12 vdc; above galley - 1 Overhead light; 12 vdc; above nav station - Water tank, under salon sole; molded fiberglass - Headroom: 73.5"

NAV STATION

The Navigation Station is located in the aft starboard side of the main cabin and features: - Navigation table with lift top - Forward facing seat - Uniden ES UM525 VHS Radio; starboard side, overhead mounted - MarineAire A/C control panel; aft bulkhead mounted - Xintex S-2A Propane/CNG Fume Detector and Control System; aft bulkhead mounted - AC electrical panel; starboard side mounted - DC electrical panel; aft bulkhead mounted - 3 110 vac electrical sockets, aft bulkhead mounted - 2 12 vdc electrical sockets; starboard side mounted - Overhead light; 12 vdc - Handheld siting compass - Various local charts and guide books

Galley

The galley is located along the starboard side of the main cabin and features: - Counter top running along the starboard side from the nav station to the forward bulkhead - Plastimo Pacific

2500, two burner, propane stove & oven; gimbled; under removable section of the countertop - Stainless steel sink w/hot & cold running water and removeable countertop insert - Waeco CoolMatic CD-30 refrigerator; under counter - MC Appliance Corp microwave oven; MCM770WTG; not installed - Behind counter locker w/sliding doors - 3 Under counter storage lockers - 4 under counter drawers - Assorted pots/pans/dishes/cooking utensils/galley supplies

Head

The private combination head/shower is located forward of the main cabin on the port side and includes: - Jabsco Manual Marine Head; port side - Sink with shower wand spigot, w/hot & cold running water; forward bulkhead - Countertop w/mirror above; forward bulkhead - Under sink storage locker - Under counter storage cubby - 2 Storage lockers; port side - Storage cubby, port side - Towel rack; aft bulkhead - Overhead light, 12 vdc - Overhead dorade vent - Fixed port/window w/shade; port side - Shower wand mount; forward bulkhead center - Headroom: 72"

Cockpit

The center cockpit is found midship forward of the aft cabin and features: - 280 degree bench seating for up to 7 passengers - Wheel Helm - Fixed windshield with hard top - Bimini top w/side panels - Cockpit shower; starboard side - Instrument station, port side forward - 1 Storage locker; under port bench seat aft - 1 Storage locker; under starboard bench seat forward - Propane locker; under starboard bench seat aft - Stainless steel lined icebox; under port bench seat forward - Companionway to main cabin; starboard offset forward - Companionway to aft cabin; starboard offset aft - Teak companionway slats (solid) - Teak deck and bench tops - Teak topped coamings - Headroom under hardtop: 72"

Helm

Center mounted pedestal helm with: - Stainless steel wheel - Magnetic binnacle compass - Gear shift & throttle; pedestal mounted

INST. STATION

Located at the forward port corner of the cockpit the instrument station includes: - Garman 3210 GPSmap chart plotter; top-mounted - Uniden submersible hand held VHF w/mount - Raymarine ST6002 Autohelm w/remote control - Yanmar engine control panel; Tachometer, Oil Pressure, Water Pressure, Hour meter, Start/Stop Controls, Warning lights - Fuel gauge - Volt meter
Located on on the starboard side bulkhead: - Datamarine CD400 Depth Meter - Rieker Heal Angle Gauge

Rig

- Single spreader masthead sloop rig - Selden spars; aluminum; gold anodized - 2 Mast mounted Lewmar 16 Two Speed Winches - Stainless steel wire standing rigging - Harken roller furler - Aft cabin top mounted mainsheet - Foresail lead tracks & cars - Mechanical boom vang - Lazy Jacks - Forespar HD 6-12 DL Extendable Whisker Pole; 25'

Sails & Canvas

- Mack Mainsail - Mack Genoa - Drifter - Cockpit Bimini w/side curtains - Main sail cover

Deck & Hull

- Fiberglass construction - Full keel - Anchor locker, foredeck access - Fortress FX-23 Anchor; bow mounted - Lewmar Pro Series 700 electric windless - 2 Lewmar 16, 2 speed winches; mast mounted - 2 Lewmar 40, 2 speed self-tailing winch; cockpit coaming, port and starboard side - 3 Winch handles - 2 Opening hatches - 2 Dorade vents - 6 Cleats; 2 at bow, 2 midships, 2 at stern - Stainless steel bow pulpit and stern rail, connected by double life lines with port & starboard gates at midship - Bow anchor mount - Emergency tiller coupling, stern deck center - Dinghy davits - LifeSling 2 Overboard Rescue System; stern rail port side - Outboard engine mount; stern rail starboard side - Swim ladder; stern, center mounted - Navigation, running & anchor lights - Deck light - Fuel fill; starboard side aft - Waste pump out; port side, midship - Water fill; port side, midship - Deck plug key - Bosuns Chair - Boat hook - 6 Fenders - Water hose - Assorted dock and anchor lines

Mechanical

- Yanmar 4JH2E, 4-stroke diesel engine freshwater cooled, 50 HP - 2 Groco ARG-755 raw water strainers - Parker Racor fuel filter/water separator - MarineAire reverse cycle marine air/heat unit - MarineAire MAP 500KT raw water pump - Johnson WPS 2.4, 9 lpm house water pump - Electric bilge pump - Isotemp Slim B, HXC25M, hot water heater w/engine heat exchanger; 25 gallon - Lasdrop Shaft Seals dripless coupling

Electrical

- House electric panels - 12 vdc electrical system - 110 vac electrical system - 3 12 vdc outlets; 2 at nav station, 1 in starboard cockpit locker - 2 110 vac outlets; nav station - 4 Crown Deep Cycle CR-235 batteries - Cobra CPI 475 DC to AC inverter (not installed) - ProMariner ProNautic 12.50P battery charger - Solar trickle charger - Quicksilver Galvanic Isolator - Battery switch; under salon aft settee - Windless circuit breaker; under salon aft settee - 30 Amp shore power receptacle; starboard cockpit coaming - 30 Amp shore power cable

Safety

- 2 Kidde Marine Type B:C Size 1 Dry Chemical Fire Extinguisher - Tundra kitchen fire extinguisher (expired) - 3 Hand held signal horns - Orion Emergency Signal Kit; Flair Gun, Whistles, Signal Mirror; Dye Marker; Flairs (Expired) - Various flairs (expired) - Pro-Torx Rechargeable 1,000.000 Candlepower Hand Held Spot Light - Stanley 1M Series Hand Held Spot Light - 3 Type IV Throwable Device PFDs - 3 West Marine Coastal Inflatable Type III Adult PFDs - 1 Near-Shore Type II Child PFD - 1 Type III Child PFD - 1 Type III Youth PFD - 1 Type III Adult Small/Medium PFD - 1 Type III Adult Large/X Large PFD - 1 Throwable Lifeline - West Marine 200 Medical Kit - Set, Emergency Tapered Wood Plugs

Dinghy

- Trident 270AIR 2-V 4 person dinghy (requires leak repair) - Lehr LP2.5S propane outboard motor; 2.5 hp - Lehr maintenance kit - Propane Tank - Support Kit - Sevylor electric inflator pump - Folding anchor system

EQUIP. & SPARE

- Classic wooden helm wheel - new (not installed- spare) - West Marine Huahine, 7x50, Field 6.6, 350ft/1,000yds, Binoculars - Hella Marine Turbo Fan - new (not installed) - Black & Decker 14.4V Dust Buster hand held vacuum - Vidal Sassoon 1875 Ionick hair dryer - Titan 1500 watt Ceramic Heater - 2 Individual ridged cockpit seat cushions w/backs - Helm cushion - Assorted towels and throw rugs - Assorted cleaning supplies - FM/VHF Marine Band Separator - Digital TV Antenna - Coby Portable DVD Player - AC and TV remote controls - Sony CDX-M10 Marine FM/AM Radio/CD Player - new (not installed) - Polly Planar RM-10 waterproof marine under dash/overhead stereo housing - new (not installed) - SeaWorthy SEA/4623 Covetable Wedge Speakers - new (not installed) - Whale Gusher Galley MK 3 Foot Operated Water Pump (not installed) - Whale Supersub Smart 650 low profile automatic bilge pump - new (not installed) - Manual water pump - Engine oil change pump; drill operated - Assorted fuel filters - Assorted alternator belts - Assorted water pump impellers - Jabsco joker valve - new - West Marine tool kit - Battery maintenance kit - 2 LED light strips - new (not installed) - 12 vdc splitter plug - 3 Headlamp flashlights - Hand held flashlight - 110 vac drop line - Assorted household batteries - Miscellaneous electrical spare parts - 2 Pair, Sarnac gloves - Fish net - System manuals & ships papers

Disclaimer

The Company offers the details of this vessel in good faith but cannot guarantee or warrant the accuracy of this information nor warrant the condition of the vessel. A buyer should instruct his agents, or his surveyors, to investigate such details as the buyer desires validated. This vessel is offered subject to prior sale, price change, or withdrawal without notice.

Исключения

При продаже яхты исключаются личные вещи владельца.

Отказ от ответственности

Компания предоставляет описание судна или яхты добросовестно, но не может гарантировать точность этой информации, а также не ручается за техническое состояние. Покупатель должен проинструктировать своих агентов или оценщиков исследовать представленную информацию более подробно, по собственному желанию. Продажа судна или яхты, изменение цены или снятие с продажи будет происходить без предварительного уведомления.

ФОТОГРАФИИ















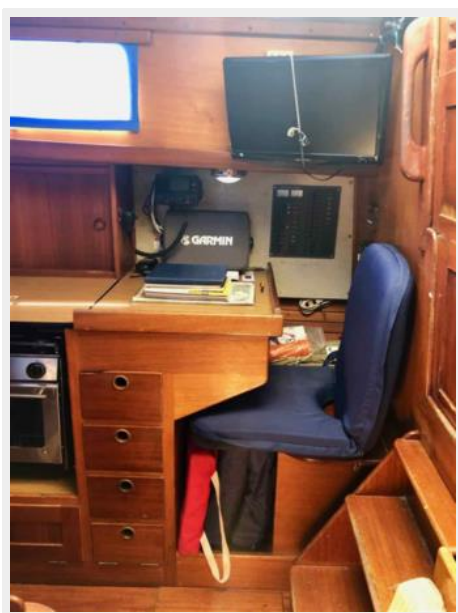



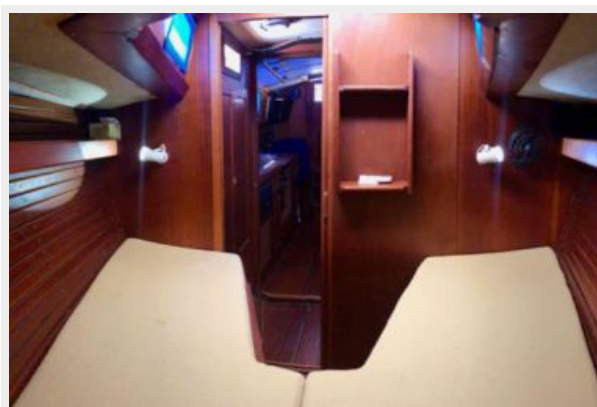

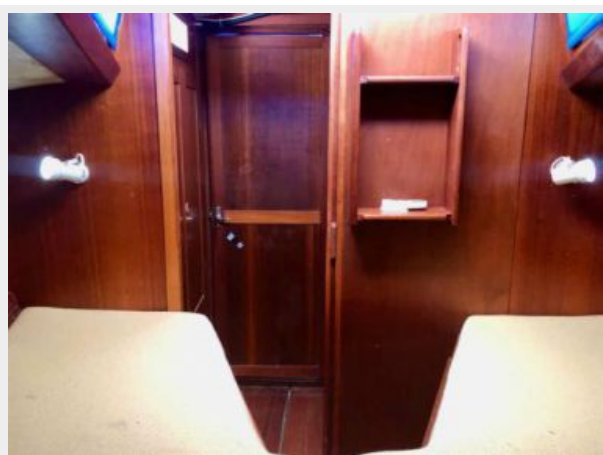



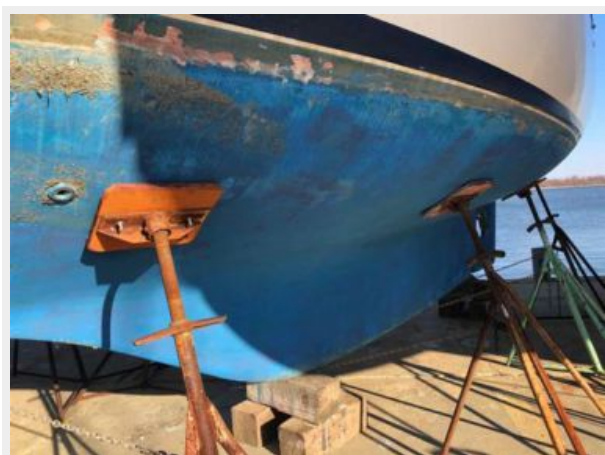

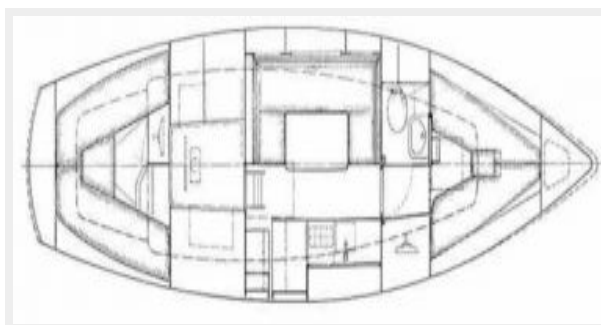
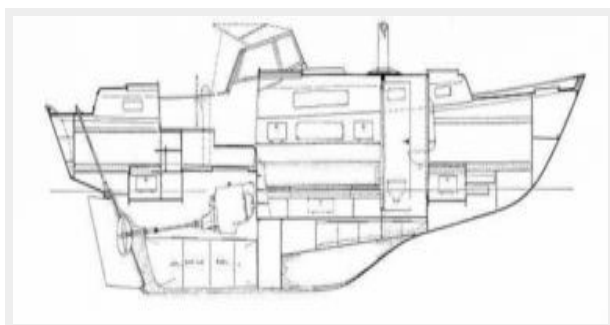
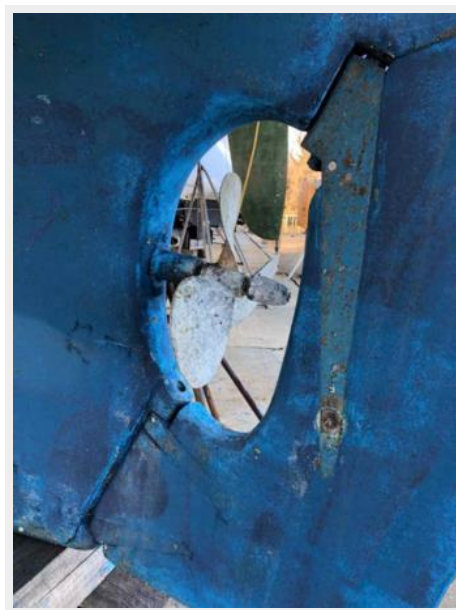



КОНТАКТЫ

Андрей Шестаков (Andrey Shestakov) – ведущий яхтенный брокер отдела продаж яхт и судов компании Shestakov Yacht Sales Inc. Официальный представитель Shestakov Yacht Sales Inc. для русскоговорящих клиентов в центральном офисе компании в Майами/Форт Лодердейл/Флорида/США.

Контактная информация

Email: andrey@shestakovyachtsales.com

Web: shestakovyachtsales.com

Телефоны

Краснодарский край: **+7(918)465-66-44**

США, Майами, Флорида: **+1(954)274-4435**

Время работы

Понедельник – Суббота: **9:00 - 21:00**
EDT

Воскресенье: **Закрето**

Адрес

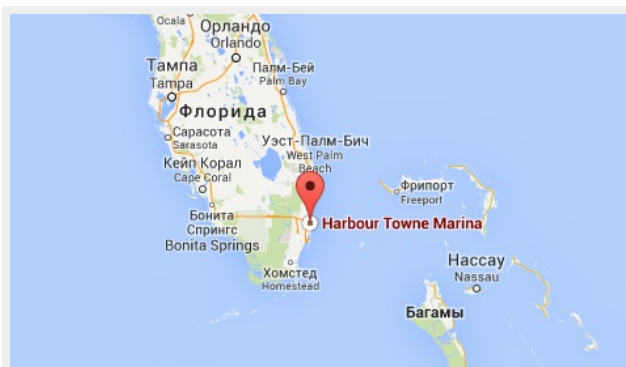

Harbour Towne Marina, 850 NE 3rd St,
STE 213, Dania, FL 33004