

## BLUE BIRD — BAYLINER



**Судостроитель:** BAYLINER

**Год постройки:** 1998

**Модель:** Моторная яхта

**Цена:** **ЦЕНА ЯХТЫ ПО ЗАПРОСУ**

**Местонахождение:** Canada

**Длина общая:** 59' 5" (18.11m)

**Ширина:** 17' 2" (5.23m)

**Мин. осадка:** 4' 11" (1.50m)

**Крейс. скорость:** 17 Kts. (20 MPH)

**Макс. скорость:** 20 Kts. (23 MPH)

Купить **Blue Bird — BAYLINER** а также выбрать подходящую вам яхту из нашего каталога яхт вам поможет опытный яхтенный брокер Андрей Шестаков. На сегодняшний день компания **Shestakov Yacht Sales Inc.** имеет большое количество яхт в собственном списке продаж, а также тесно сотрудничает со всеми крупными яхтенными производителями по всему миру.

Для того чтобы купить яхту **Blue Bird — BAYLINER** а также проконсультироваться по любому вопросу связанному с покупкой, продажей, чартером яхт позвоните по телефону **+7(918)465-66-44**.

# ОГЛАВЛЕНИЕ

---

ОГЛАВЛЕНИЕ	2
ХАРАКТЕРИСТИКИ	3
Обзор	3
Основная информация	11
Размеры	12
Скорость, вместимость и масса	12
Размещение	12
Корпус и палуба	12
Информация о двигателе	12
ФОТОГРАФИИ	13
IMG_1086	18
IMG_1089	18
IMG_1094	19
IMG_1095	19
IMG_1096	19
IMG_1093	19
IMG_1092	20
IMG_1097	20
КОНТАКТЫ	21
Контактная информация	21
Телефоны	21
Время работы	21
Адрес	21

# ХАРАКТЕРИСТИКИ

## Обзор

### IMMACULATE “FRESHWATER” BAYLINER 5788 MOTOR YACHT PILOTHOUSE

This Bayliner 5788 Motor Yacht is now known as a Meridian 580 Pilothouse. This vessel has been kept cleaned/waxed and otherwise well maintained, with any maintenance or repairs performed as required. Bottom just painted and engines, generator and transmission serviced this summer. This vessel is loaded with options, including upgraded 610 MAN engines and everything needed for long-range cruising. This vessel is currently going a major refit. Don't miss it!

### Vessel Walkthrough

Cherry Wood cabinets and trim, solid-surface countertops, direct and indirect lighting and designer accents are found throughout. The main salon includes an L-shaped lounge with hi/low cocktail table and ottomans. It offers lots of nature light and entertainment area. Forward of the salon, there is a large dinette directly across from the full service galley, with the pilothouse further forward. The large pilothouse has great raised seating for guests behind the helmsman, with excellent visibility for all. There are heavy-duty sliding doors on either side for quick access to the deck. The command console, with full-scale electronics, is set on the centerline behind an expansive windshield. Stairs to starboard lead to staterooms below. Down below, the ample beam allows very spacious staterooms, with large heads and vanities. The vast master stateroom lies amidships, just past a mirrored door in the companionway, concealing a brand new full-sized over/under washer/dryer. This stateroom has a large island berth, entertainment center and private head which features an enclosed, full-sized tub. The forward stateroom is spacious with island berth and good storage. With four portlights and two overhead hatches, this bright and spacious stateroom also offers privacy, including ensuite access to the head. The third cabin has bunks that criss-cross in an open-L pattern. Interior steps from the pilothouse lead up to the flybridge, where there's a second command station and more seating for entertaining guests. The deck extends aft to provide cover for the cockpit below as well as room for a davit. Integral steps also lead from the flybridge to the spacious cockpit. These steps lift up to reveal the stairs down to the engine room, with emphasis on the word, "room." There's plenty of room around the upgraded twin 610 HP MAN Diesels. The cockpit also provides access to a boarding platform aft, with transom doors to port and starboard.

### Salon

From the cockpit, enter through sliding doors to the salon with comfortable seating, entertainment center to starboard, as well as a spacious wet bar and ice maker.

- Lounge, L-Shaped, Stowage Under
- Ottomans (2)
- Wet Bar w/Stainless Steel Sink and

- Table, Adjustable Hi/Low, w/Solid-Surface Top
- Entertainment Cabinet - TV (27") w/VCR
- Stereo System: AM/FM/Cassette, CD Player and Surround Sound
- Solid Surface Countertops
- Built-In Blender
- Ice Maker
- Storage, Bottle/Glass
- Carpeting
- Silhouette Blinds

## Galley

The U-shaped galley is extremely functional with full-sized appliances, generous storage and ample counter space for food preparation and entertaining. This galley boasts the optional dishwasher and trash compactor and is on the same level as the salon.

- Cooktop - 4 Burner, Electric, Smooth-top
- Oven, Electric
- Microwave Oven
- Refrigerator/Freezer
- Dishwasher
- Coffeemaker
- Cabinets and Drawers
- Cabinet w/Lazy Susan
- Spice Rack
- Sink, Double SS
- Countertops, Solid-Surface
- Flooring, Hardwood
- Dockside and Pressure Water

## Dinette

- Dinette Table w/Solid-Surface Top
- Pedestal, Wood w/Stowage
- Seat, U-Lounge, w/Stowage Under

## Lower Helm/Pilothouse

The pilothouse has a command console and helm seat with excellent visibility, and a raised L-shaped dinette/lounge area w/opening pedestal table. Port and starboard doors give easy access to wide decks.

- Compass, Flush-Mounted, Illuminated
- Instrumentation: Voltmeter, Oil Pressure Gauge, Fuel Gauge, Temperature Gauge
- Hour Meters
- Engine Controls, Top-Mount, Dual Hydraulic
- Steering Wheel, Stainless Steel
- Ray GPS/Chart 611T
- Battery Level Indicators
- Satellite Phone
- Cell Phone w/Amplifier & Antenna
- Helm Seat, Adjustable and Movable
- Seat, L-lounge w/Removable Center Section and Stowage Under
- Table, Pedestal

- Ray R41XX Radar
- Color Monitor
- Ray ST60 Autopilot
- Ray 210 VHF
- Depth Sounder
- Bow Thruster Control
- Spotlight Control
- Trim Tabs
- Windmeter
- Windows, Port and Starboard, Opening w/Screen
- Doors, Port and Starboard
- Stairs: Access to Staterooms w/Stainless Steel Hand Rail
- Stairs:Open Stepsto Bridge
- Stowage Cabinets, Above Lounge
- Windshield Wipers and Washers
- Windshield Cover

## Master Stateroom

The master stateroom has queen-size island berth, abundant storage, built-in entertainment center and ensuite head.

- Berth, Queen-size, Island
- Drawers (6): Under Berth
- Drawers (8): Under Vanities
- Nightstands (2): w/Lamps and Drawers
- Hanging Lockers (2), Cedar, Lighted
- Entertainment Cabinet w/TV/VCR
- Stereo System, AM/FM/CD Player
- Portlights (2), Opening w/Screen
- Window Shades, Custom
- Mirrors, Above Vanities
- Vanity Cabinet w/Molded Sink, Solid-Surface Countertop, Stowage Under
- Medicine Cabinet w/Mirrored Doors

## Master Head

The large master head includes an enclosed shower with tub.

- Enclosed Shower/Tub Stall, Fiberglass w/Acrylic Enclosure
- Toilet, Electric
- Linen Cabinet
- Chrome and Brass Fixtures
- Opening Portlight w/Screen

## VIP Stateroom

The VIP has a double island berth with plenty of storage and natural light.

- Berth, Double, Island, w/Stowage Under
- Hatches (2), Opening w/Screens

- Television
- Hanging Lockers (2): Cedar-Lined, Lighted
- Drawers, Under Berth
- Portlights (4) w/Screens
- Window Curtains
- Ensuite Access to Head

### Bonus/Third Stateroom

The mid stateroom has upper/lower berths, criss-crossed. There's lots of headroom and storage.

- Bunks (2), Single, Stowage Under
- Drawers (2): Under Lower Bunk
- Hanging Locker, Cedar w/Shelves
- Portlight, Opening w/Screen
- Washer and Dryer in Companionway

### Guest Head

The head is dual-access from companionway and VIP stateroom. The enclosed shower stall has a molded-in seat, plus a generous amount of headroom and elbow room.

- Enclosed Shower Stall, Fiberglass w/Acrylic Enclosure
- Vanity Cabinet w/Molded Sink, Solid-Surface Countertop, Stowage Under
- Medicine Cabinet, w/Sliding, Mirrored Doors
- Toilet, Electric
- Chrome and Brass Fixtures
- Opening Portlight w/Screen

### Cockpit

Access to the engine room as well as the generator is gained from the cockpit. Another hatch in the cockpit holds the spare props. There are two doors through the transom leading out onto the big swim platform.

- Bulkhead, w/Window, Opening w/Screen
- Door to Cabin, Sliding, Locking
- Hatches (2), Bilge Access
- Molded Steps to Side Decks
- Molded Steps to Bridge, Hinged for Engine Room Access
- Shore Water Connection
- Fresh Water Washdown
- Fender Stowage
- Stowage Locker
- Boarding Ladder
- Transom Doors, Port and Starboard
- Transom Shower
- Lights, Overhead
- Courtesy Lights

### Flybridge/Upper Helm

The flybridge is very spacious with a second command station, ample seating for guests, plus a wet bar and plenty of room for the davit and tender.

- Bimini Top
- Center Console, Non-Glare Dash Panel
- Instrumentation, Dual-Analog: Tachometer, Voltmeter, Oil Pressure Gauge, Temperature Gauge, Hour Meters
- Engine Controls, Top-Mount, Dual Hydraulic
- Steering Wheel, Stainless Steel
- Compass, Flush-Mounted, Illuminated
- GPS Remote
- Autopilot
- VHF Radio
- Depth Finder
- Bow Thruster Control
- Dual Station Spotlight
- Windlass Control
- Trim Tab Control
- Helm & Companion Seats: Adjustable/Swivel, Removable
- Seat, L-lounge: w/Removable Cushions, Stowage Under
- Helm & Seat Covers
- Wet Bar and Refrigerator w/Icemaker
- Courtesy Lights
- Stereo, AM/FM CD Player
- EPIRB
- Radar Arch: w/Recessed Lighting and Speakers
- Door: Access to Pilothouse, Sliding, Locking w/Screen
- Hatch, w/Stair Access to Cockpit
- Davit, Hydraulic Lift 1,500#

## Deck

There are wide walkways leading up to the foredeck, where there's a removable sunpad and a deep bow well for anchor rode and chain, plus a raw-water, wash-down. The windlass can be controlled either at the bow or from the flybridge.

- Anchor w/200' Chain and 150' Line
- Windlass
- Locker for Anchor Rode
- Washdown, Bow Raw Water
- Rails, Stainless Steel, Welded
- Sunlounge Cushion, Foredeck, Removable
- Fenders and Lines
- Swim Platform, Integrated
- Swim Ladder, Concealed, Fold-Away

## Engine/Mechanical

The engine room is huge with easy access to engines (upgraded 610 MAN) and mechanicals. Full service on engines, generator and transmission done August 2019.

- Fire Suppression System

- Reverse Cycle AC/Heat
- Hydraulic Steering
- Overboard Discharge, Macerator, 24V
- Bilge Pumps, Automatic
- Water Heater - 20 gal
- Alarm, Engine High Temperature/Low Oil Pressure
- Alarm, High Water
- Upgraded Fresh Water Pump w/Upsized Accumulator Tank
- MAN Spare Parts Kit

## Electrical System

- Generator, Westerbeke 15kw w/Soundshield - 2100 Hrs.
- Inverter, Trace 4kw
- Batteries w/Isolator and Battery Control Switches
- Battery Chargers (2)
- Battery Paralleling System
- Cable and TV Connectors
- Distribution Panel: 110V AC/24V DC
- Glendinning Cablemaster, 240V/50 amp
- Horn, 24V
- Monitoring System, 24V
- Navigation Lights, 24V
- Westerbeke Spare Parts Kit

**Dimensions** LOA: 59 ft 4 in Beam: 17 ft 2 in **Accommodations** Number of staterooms: 3

Number of heads: 2

## Specification:

- LOA 59' 5"
- LOD 56' 8"
- Beam 17' 2"
- Draft 4' 11"
- Displacement 69,000lbs.
- Bridge Clearance 20' 2"
- Cruise Speed 17 Knots
- WOT 20 Knots
- Hull - Fiberglass Construction
- Hull Keel - Modified Vee Section - Moderate Displacement
- Bronze Spade Rudders
- Decks - Fiberglass with Sea-Dek
- Superstructure - Fiberglass with Core
- Designer – Brunswick Corporation
- Builder – Brunswick Corporation
- Built in Arlington, WA. USA

## Tankage:



- FUEL - 800 Gallons in 2 Aluminum Fuel Tanks
- DOMESTIC WATER - 226 Gallons in 1 Plastic Water Tank
- WASTE HOLDING TANK - 76 Gallons in 1 New Stainless Steel Holding Tank

**Interior:**

- Sleeps 6 - 2 in Forward Private Stateroom - Pedestal Bed
  - 2 in Mid-Ship Private Stateroom - Twin Bunks
  - 2 in Master Stateroom below Pilothouse Queen Size Bed
- Hot & Cold Pressure Water System
- **Horizon SeaFari HRO Watermaker System**
- Double Stainless Steel Galley Sinks
- Frigidaire 15 Cubic Foot Upright Refrigerator/freezer
- AEG 4-Burner Glass Countertop Stove/Oven - 120 Volt AC System
- Range Hood/Fan
- New Bosch Dishwasher
- GE Microwave Oven
- U-Line Ice Maker
- Cherry Wood Cabinetry
- Corian Countertops
- New LG Washer & Dryer
- **Webasto Diesel Fired Recirculating Hydronic Heating System**
- Toshiba 24" TV
- RCA 21" TV with Built-in DVD Player
- 13" Sony in Forward Stateroom
- Digital Satellite Receiver
- TracVision G4 TV Antenna
- Pioneer Stereo Tuner
- Sony CD/DVD
- Dual 12Volt DC AM/FM/CD Stereo System
- 2 Private Heads
- Both Heads included Walk-in Showers
- Both Heads have Electric VacuFlush Toilets

**Mechanical / Electrical:**

- Twin MAN D2866 LE405 Freshwater-Cooled 610hp 6-Cylinder Turbocharged Direct Drive Inboard Engines - **Professionally Maintained**
- Port Engine 2116 Hours
- Starboard Engine 2138 Hours
- Cruise Speed 17 Knots
- WOT 20 Knots
- Alternator 75 amps each @ 24 Volt DC

- Wet Injected Exhaust System
- Fuel Filters - Racor Primary Fuel Filters & Secondary Fuel Filters on each Engine
- ZF IRM311A.1 Transmissions
- 2.03 to 1 Reduction Gear Ratio
- Two Helm Stations with Hydraulic Throttle/Shift Hynautics Controls
- **Bow Thruster**
- K&S Bronze 4-Blade 32 x 35 Right & Left Hand Rotation Propellers
- One Piece Stainless Steel 3" Shafts
- Bilge Pumps - 1 RuleMate 1100 Submersible in Forward Engine Room Bilge

1 Johnson 2200 Submersible in Forward Engine Room Bilge

2 Johnson 2200 Submersibles in Middle Bilge

1 Johnson 1250 Submersible in Aft Engine Room Bilge

8,950 Gallons per Hour Total Pumping Capacity

- Electrical Systems - 12 Volt DC / 24 Volt DC / 120 Volt AC / 30amp & 50amp
- Batteries - 8 Batteries for 12 Volt System

4 Group 31 Batteries

4 8D Batteries

- Westerbeke 15kw Diesel Powered Generator - **Professionally Maintained**
- 2102 Hours
- Trace Engineering 4000 Watt Inverter/120amp Charger
- Professional Mariner 35amp Battery Charger
- Master Battery Switches - 4 Port Engine / Starboard Engine / House Batteries / 12 Volt Battery Switches
- Sure Power Battery Isolators

### **Navigation / Communication:**

- Pilothouse Helm:

Ritchie 4" Compass

Auto Pilot

Raymarine C140 Sunlight Viewable Color LCD Touchscreen

Raymarine GPS with Rose Point Navigation integrated to Custom Computer System

Raymarine Navigation/Speed/Depth

RAY210 VFH Radio

## FloScan Fuel Monitoring System

### FLIR System

- Flybridge Helm:

Ritchie 5" Compass

Raymarine C90 Sunlight Viewable Color LCD Touchscreen

### Auto Pilot

Simrad Depth/Wind/Speed

RAY220 VHF Radios (2)

### Ground Tackle:

- Davis 55# Plow Type Anchor
- 200' of 3/8" High Test Chain
- 10' of Line Rode
- Lewmar Electric Vertical Windlass with Capstan

### Miscellaneous:

- Fiberglass Radar Arch
- Yacht Davit Systems Aluminum Dingy Davit

## Основная информация

---

**Тип судна:** Моторная яхта

**Модельный год:** 1998

**Год постройки:** 1998

**Год обновления:** 2019

**Страна:** Canada

**Верх:** Bimini Top

**Открытая палуба мостика:** Да

## Размеры

**Длина общая:** 59' 5" (18.11m)

**Длина палубы:** 56' 8" (17.27m)

**Ширина:** 17' 2" (5.23m)

**Мин. осадка:** 4' 11" (1.50m)

**Трапы:** 19' 0" (5.79m)

**Длина привального бруса:** 57' 8" (17.58m)

## Скорость, вместимость и масса

**Крейс. скорость:** 17 Kts. (20 MPH)

**Макс. скорость:** 20 Kts. (23 MPH)

**Водоизмещение:** 53000 Pounds

**Вместимость воды:** 226 Gallons

**Вместимость сточного бака:** 76 Gallons

**Объем топливного бака:** 800 Gallons

## Размещение

**Всего кают:** 3

**Всего коек:** 6

**Спальные места:** 6

**Всего ком. состава:** 2

## Корпус и палуба

**Материал корпуса:** Fiberglass

**Материал палубы:** Composite Fiberglass

**Комплектация корпуса:** Modified V-Hull

**Цвет корпуса:** White

**Отделка корпуса:** Plastic

**Дизайнер корпуса:** Brunswick

## Информация о двигателе

**Двигатели:** 2

**Производитель:** MAN

**Модель:** D2866 LE405

**Тип двигателя:** Inboard

**Тип топлива:** Diesel

# ФОТОГРАФИИ

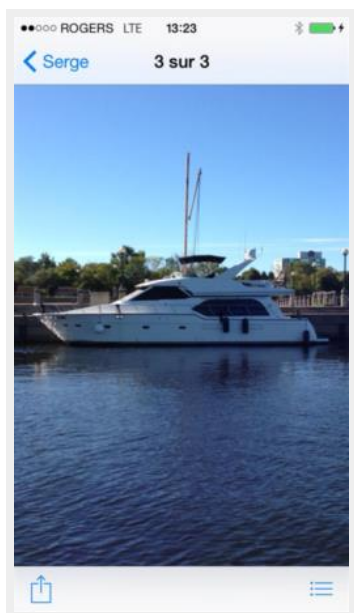











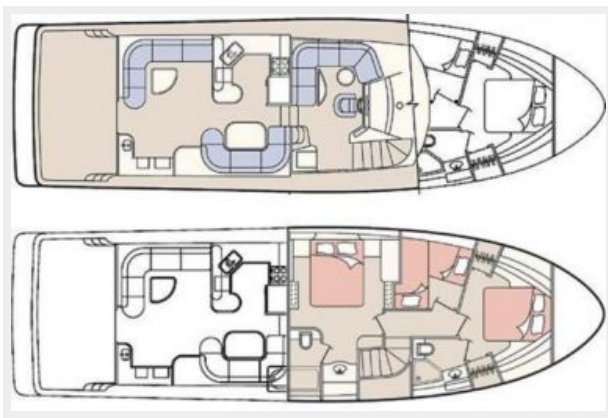

IMG\_1086

IMG\_1089

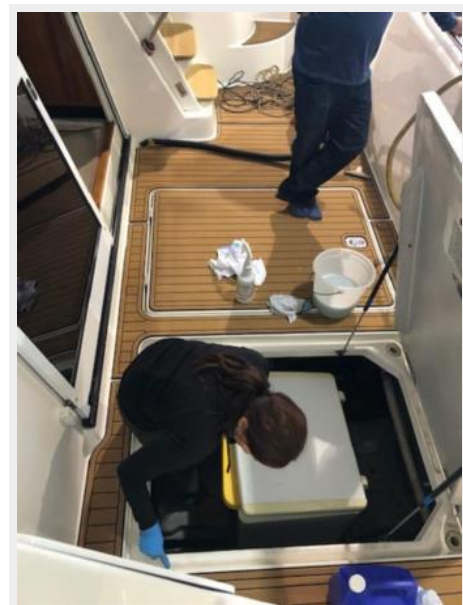

IMG\_1094



IMG\_1095



IMG\_1096



IMG\_1093



IMG\_1092



IMG\_1097



# КОНТАКТЫ

---

Андрей Шестаков (Andrey Shestakov) – ведущий яхтенный брокер отдела продаж яхт и судов компании Shestakov Yacht Sales Inc. Официальный представитель Shestakov Yacht Sales Inc. для русскоговорящих клиентов в центральном офисе компании в Майами/Форт Лодердейл/Флорида/США.

## Контактная информация

---

Email: [andrey@shestakovyachtsales.com](mailto:andrey@shestakovyachtsales.com)

Web: [shestakovyachtsales.com](http://shestakovyachtsales.com)

## Телефоны

---

Краснодарский край: **+7(918)465-66-44**

США, Майами, Флорида: **+1(954)274-4435**

## Время работы

---

Понедельник – Суббота: **9:00 - 21:00**  
EDT

Воскресенье: **Закрето**

## Адрес

---



Harbour Towne Marina, 850 NE 3rd St,  
STE 213, Dania, FL 33004