

## KELLY LAUREL 2 — FONTAINE PAJOT



**Builder:** FONTAINE PAJOT

**LOA:** 50' 0" (15.24m)

**Year Built:** 2018

**Model:** Catamaran

**Price:** PRICE ON APPLICATION

**Location:** Greece

Our experienced yacht broker, Andrey Shestakov, will help you choose and buy a yacht that best suits your needs Kelly Laurel 2 — FONTAINE PAJOT from our catalogue. Presently, at Shestakov Yacht Sales Inc., we have a wide variety of yachts available on our sale's list. We also work in close contact with all the big yacht manufacturers from all over the world.

If you would like to buy a yacht Kelly Laurel 2 — FONTAINE PAJOT or would like help answering any questions concerning purchasing, selling or chartering a yacht, please call **+1(954)274-4435**

---

# TABLE OF CONTENTS

---

|                                   |    |
|-----------------------------------|----|
| TABLE OF CONTENTS                 | 2  |
| SPECIFICATIONS                    | 4  |
| Overview                          | 4  |
| Basic Information                 | 4  |
| Dimensions                        | 4  |
| Accommodations                    | 4  |
| Hull and Deck Information         | 4  |
| Engine Information                | 4  |
| DETAILED INFORMATION              | 5  |
| Manufacturer Provided Description | 5  |
| Cockpit                           | 5  |
| Accommodations                    | 6  |
| Galley                            | 7  |
| Engines                           | 8  |
| Electrics                         | 8  |
| Mast and Boom                     | 9  |
| Sails                             | 9  |
| Helm Station                      | 9  |
| Other Equipment                   | 9  |
| Disclaimer                        | 10 |
| Exclusions                        | 10 |
| Disclaimer                        | 10 |
| PHOTOS                            | 12 |
| 51                                | 12 |
| 50                                | 12 |
| 54                                | 12 |
| 55                                | 12 |
| 52                                | 13 |

---

|                 |           |
|-----------------|-----------|
| 53              | 13        |
| 56              | 13        |
| 57              | 13        |
| 58              | 13        |
| 60              | 13        |
| 61              | 14        |
| 62              | 14        |
| 63              | 14        |
| 59              | 14        |
| 64              | 14        |
| 65              | 14        |
| 66              | 15        |
| 67              | 15        |
| 68              | 15        |
| 69              | 15        |
| 71              | 15        |
| 70              | 15        |
| <b>CONTACTS</b> | <b>16</b> |
| Contact details | 16        |
| Telephones      | 16        |
| Office hours    | 16        |
| Address         | 16        |

---

# SPECIFICATIONS

---

## Overview

---

This Rare to Market 2018 Saba 50 is in impeccable condition with US Taxes Paid - 220/110V - to take you anywhere in the world. Kelly Laurel 2 is on the hard, located in the Cleopatra Marina close to Athens Greece. With her layout of 5 cabins and 5 heads, she can accommodate very comfortably. Why wait for a new build, when you can start sailing your Saba 50 today! (Still under Warranty)

## Basic Information

---

**Category:** Catamaran

**Model Year:** 2018

**Year Built:** 2018

**Country:** Greece

## Dimensions

---

**LOA:** 50' 0" (15.24m)

## Accommodations

---

**Total Cabins:** 5

**Total Heads:** 5

## Hull and Deck Information

---

**Hull Material:** Fiberglass

## Engine Information

---

**Engines:** 2

**Manufacturer:** Volvo

**Model:** D2

**Engine Type:** Inboard

**Fuel Type:** Diesel

---

# DETAILED INFORMATION

---

## Manufacturer Provided Description

---

### THE INTERNATIONALLY-ACCLAIMED SAILING YACHT

The Saba 50 continues to garner critical acclaim throughout the world for its distinctive lines, sophisticated styling, choice of spacious living areas, and outstanding offshore performance. Voted Best Boat, this sailing yacht is the perfect vessel on which to share the joy of exploring the most beautiful destinations with those you love.

With an exterior profile that reflects the elegant and innovative philosophies of her designers, the sailing yacht Saba 50 turns heads wherever she goes. A generous lounge deck delivers a bold high-performance profile, while guests can also choose to unwind in the spacious cockpit or on the magnificent sun lounger at the fore, which provides an indulgent all-weather retreat adjacent to concealed storage lockers. The boat's design provides seamless movement and communication between the cockpit, helmstation and lounge deck, while the incredible space in the saloon evokes the ambience traditionally found only on much larger yachts.

Available in a 6-cabin version including a superb Owner's suite, the Saba 50 is the quintessential lifestyle cruising catamaran for every sailing enthusiast.

## Cockpit

---

- Large cockpit: 19m<sup>2</sup>, Circulation without threshold towards the saloon.
- Access via the transom platforms
- Transom platform with swimming ladder (at port) & handrail
- 1 cold shower in the port platform
- GRP Bimini protecting all the cockpit
- 8 seats sofa around the table
- 1 Teck cockpit table with a capacity of 8 places (10 places in option)
- Serving hatch to the galley via sliding bay
- 1 Large storage area under the sofa
- 1 fainting sofa with large storage locker
- 1 Transom sofa with large storage locker
- 2 Sunbeds
- 1 Gas chest for 2 bottles
- Space for the liferaft under the stairs leading to helm station
- Space on starboard side for a cockpit 75L fridge
- Additionnal ventilation and lighting via 1 deck hatch
- Lighting via 2 waterproof spotlights
- Space available for a barbecue on starboard side aft of the cockpit

---

## Accommodations

---

### Saloon

- Accessible via a single-leaf sliding door with carpeted entrance
- Panoramic view through picture windows
- Natural lighting via 2 glass panels
- 1 veneered table
- 6 places bench seat
- Large storage boxes under the bench
- Ventilation via 2 large front opening hatches
- Main lighting system by 5 spotlights

### Quintet Version

#### Aft Cabin

- Access from the companionway via a wooden door
- Queen-size Island Bed (1,60x2,00 m approx)
- Drawer below the bed with frontal access
- Bedside shelves
- Wardrobe
- Cupboard with shelves in it
- Ventilation via a deck hatch + 1 porthole overlooking the rear deck
- Rear panoramic window
- Large picture-window on hull side
- Curtains to all windows
- Main lighting via 2 spotlights & 2 berth lights
- 1 Bedside two-way switch
- Clothes hooks
- Lining covered ceilings

#### Fore Cabin

- Access from the companionway via a wooden door
- Queen-size Island Bed (1,60x2,00 m approx)
- Drawer below the bed with frontal access
- Wardrobe
- Ventilation thanks to a deck hatch & 1 porthole
- Large picture-window on hull side
- Curtains to all windows and doors
- Main lighting via 2 spotlights & 2 berth lights
- 1 Bedside two-way switch
- Clothes hook

- Lining covered ceilings

### Central cabin

- Access from the companionway via a wooden door
- Queen-size bed (1,60x2,00 approx.)
- Drawer below the bed with frontal access
- Wardrobe
- Ventilation thanks to a deck hatch & 1 porthole
- Large picture-window on hull side
- Curtains to all windows and doors
- Main lighting via 2 spotlights & 2 berth lights
- 1 Bedside two-way switch
- Clothes hook
- Lining covered ceilings

### Aft cabin

- Access from the cockpit though Plexiglas door including keylock
- Queen-size bed (1,60x2,00 approx.)
- Drawer below the bed with frontal access
- Wardrobe
- Cupboard with shelves in it
- Ventilation thanks to a deck hatch
- Large picture-window on hull side
- Curtains to all windows and doors
- Lining covered ceilings

### Aft, central and fore bathroom

- Access via wooden door
- Washbasin with worktop
- Mirror with shelf
- Hot and cold freshwater system from mixer faucet
- Shower separated via a Plexiglas panel
- Electric drainage pump for greywater
- Mixing valve tap for shower
- Large manual marine toilet
- Storage closet with shelves under the worktop
- Clothes hooks
- Ventilation thanks to 1 deck hatch
- Lighting via 2 spotlights

## Galley

- Galley opened to the outside thanks to a sliding bay
- Ventilation via 1 opening hatch above stove top
- Worktop
- Twin stainless-steel sinks
- 1 top accessed trash can, bags removed through separate door
- Pressurized hot and cold freshwater system from mixer faucet
- 1 x 4 burner stove with pan holder
- 1 stainless gas oven
- 2 large cupboards under the sinks accommodating a dishwasher (optionally)
- Front closet that can accommodate a maximum volume of 130L/34gals in refrigeration mode or 90L/24gals in conservation mode
- 1 cutlery drawer, 2 drawer for pots & pans
- 190L cold storage volume (12V) in central “island” cabinet
- 1 large storage cupboard on the starboard side of the entrance
- 3 storage spaces underneath the floor
- 4 spotlights

## Engines

---

- 2 Saildrive Volvo engine D2- 55CV
- 3 Blades fixed propeller
- Salt water filters
- Engine cooled via heat exchanger
- Complete engine panel and dual controls at helm station
- Hour meter

## Electrics

---

### Power system

- 2 x 115A/12V engine alternators
- 1 set starboard onboard/engine batteries of 600A/h (4 x 150 Ah)
- 1 port engine battery of 50A/h/ 800CCA
- 1 automatic back-up link and 1 Manual back-up link

### 12V electrical distribution panel

- General 12V distribution panel at chart table protected via circuit breakers
- Voltmeter for onboard batteries
- Spare sockets for extra equipment
- All accommodation lightings LED
- All LED lighting functions monitored by multiplexing system



---

## Electronics

- 1 V.H.F. mast head antenna

---

## Mast and Boom

- Mast and boom in anodized aluminum
- Complete standing rigging
- Ball bearing mainsail luff cars
- 1 tackle on mainsail halyard
- 1 topping lift
- 3 reef pennants
- 1 genoa halyard
- 1 spinnaker halyard
- Lazy-jack
- Clutches on all halyards for genoa, spinnaker and topping lift
- Clutches on reef pennants at boom exit
- 2 flag halyards
- Navigation, running and mooring lights
- Deck lighting

---

## Sails

- Full batten CSR mainsail
- Roller genoa furler
- Genoa with UV band

---

## Helm Station

- 1 mainsheet tackle led aft to coach roof
- 1 clutch for mainsail sheet
- 2 size 60 self tailing winches for mainsail and genoa sheets
- 1 Ball bearing mainsheet traveler
- 2 x tackle on mainsheet traveler clutches with back on roof
- 2 x genoa tracks with load block
- 2 genoa sheets
- 1 size 50 self tailing winchs for main halyard and reef lines
- 1 halyard storage bag

---

## Other Equipment

- 1 steering compass
- 3 winch handles with their 3 pockets
- Pulpit and pushpit, stanchions with upper and lower guardrails
- Pulpits with bow pulpit seats
- Access to transom
- 2 x tender davits with 1 x size 46 winch on port side
- 7 mooring cleats ( 2 foredeck + 2 middle + 2 astern + 1 in anchor well)
- Protection for both transom
- 6 fenders
- 2 x 50 ft long mooring lines
- 1 x 1500W electric windlass with circuit breaker protection
- Anchor fairlead under bridge deck with built-in bridle
- 1 roller on forward beam
- Net on forward beam
- 1 kit of spare parts

Added by Owner:

- Washer and Dryer
- Carbon fiber ramp
- 2 paddleboards
- All Kitchen accessories
- New sheets and towels
- Tools

## Disclaimer

---

The Company offers the details of this vessel in good faith but cannot guarantee or warrant the accuracy of this information nor warrant the condition of the vessel. A buyer should instruct his agents, or his surveyors, to investigate such details as the buyer desires validated. Hours listed may vary from actual hours due to recent use. Purchaser is encouraged to verify hours prior to purchase. This vessel is offered subject to prior sale, price change, or withdrawal without notice.

## Exclusions

---

Owner's personal belongings.

## Disclaimer

---

The Company offers the details of this vessel or yacht in good faith but cannot guarantee or warrant the accuracy of this information nor warrant the condition of the vessel. A buyer should

instruct his representatives, agents, or his surveyors, to investigate such details as the buyer desires validated. This vessel or yacht is offered subject to prior sale, price change, or withdrawal without notice.

# PHOTOS

50



51



54



55



52



53



56

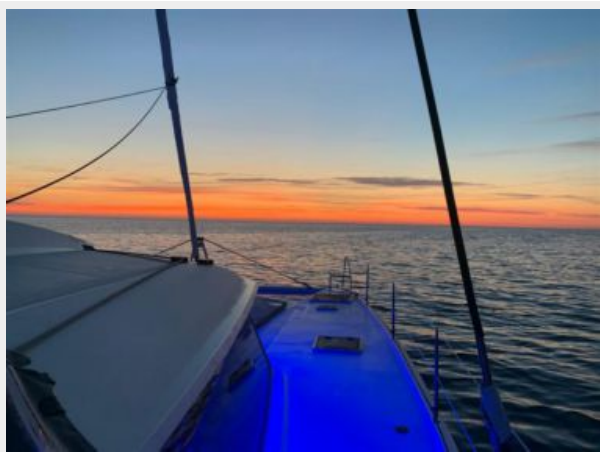

57



58



60





61



62



63



59



64



65



66



67

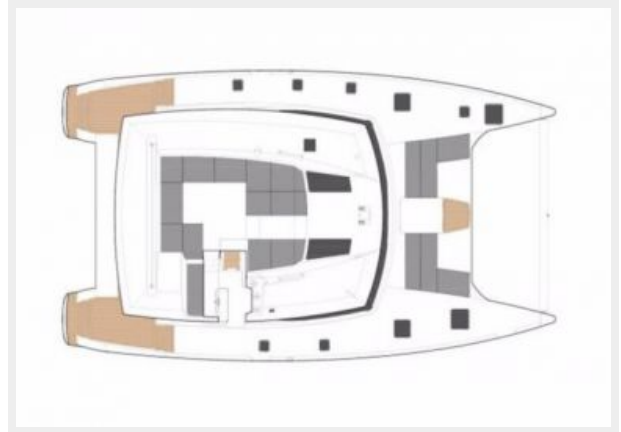

68

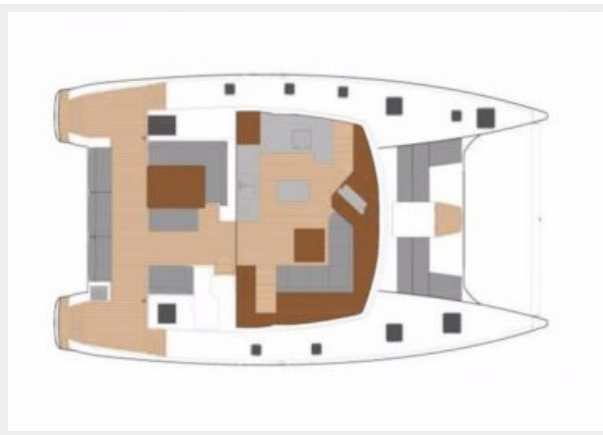

69

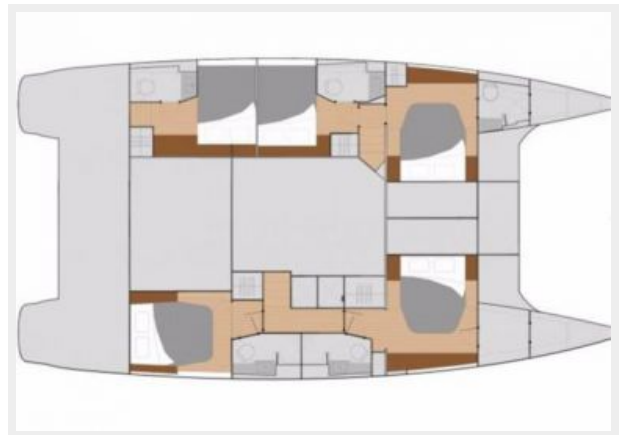

70

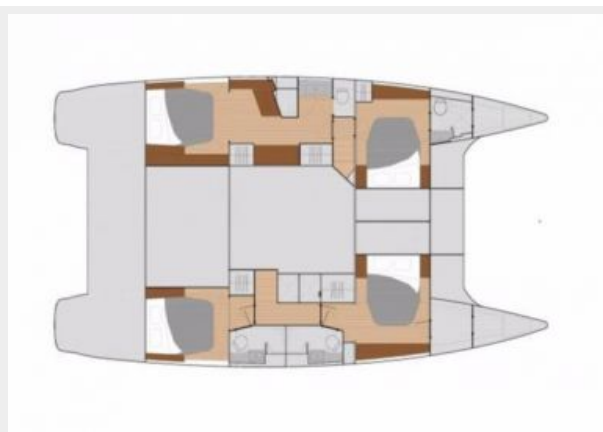

71



# CONTACTS

---

Andrey Shestakov, leading yacht broker of the sales department of Shestakov Yacht Sales Inc. Shestakov Yacht Sales Inc., the official representative of the Miami/Fort Lauderdale FL headquarters.

## Contact details

---

Email: [andrey@shestakovyachtsales.com](mailto:andrey@shestakovyachtsales.com)

Web: [shestakovyachtsales.com/en/](http://shestakovyachtsales.com/en/)

## Telephones

---

USA: +1(954)274-4435

## Office hours

---

Monday – Saturday: **9:00 - 21:00** EDT

Sunday: **closed**

## Address

---



Harbour Towne Marina, 850 NE 3rd St,  
STE 213, Dania, FL 33004