

VARSOVIE — NAUTOR'S SWAN



Builder: NAUTOR'S SWAN

Year Built: 2008

Model: Cruising/Racing Sailboat

Price: PRICE ON APPLICATION

Location: Spain

LOA: 99' 1" (30.20m)

Beam: 23' 4" (7.10m)

Max Draft: 13' 6" (4.10m)

Cruise Speed: 12 Kts. (14 MPH)

Our experienced yacht broker, Andrey Shestakov, will help you choose and buy a yacht that best suits your needs **VARSOVIE — NAUTOR'S SWAN** from our catalogue. Presently, at Shestakov Yacht Sales Inc., we have a wide variety of yachts available on our sale's list. We also work in close contact with all the big yacht manufacturers from all over the world.

If you would like to buy a yacht **VARSOVIE — NAUTOR'S SWAN** or would like help answering any questions concerning purchasing, selling or chartering a yacht, please call **+1(954)274-4435**

TABLE OF CONTENTS

TABLE OF CONTENTS	2
SPECIFICATIONS	5
Overview	5
Basic Information	5
Dimensions	5
Speed, Capacities and Weight	6
Accommodations	6
Hull and Deck Information	6
Engine Information	6
DETAILED INFORMATION	7
SWAN 100-204 VARSOVIE	7
Exclusions	17
Disclaimer	17
PHOTOS	18
Sailing-yacht-Varsovie-aft-view-Photo-by-Rolux-Carlo-Borlenghi	18
nautor_s_swan-varsovie-full	18
Varsovie Specs 2019_Page_01_Image_0003	18
Deck-Hull	18
Varsovie Specs 2019_Page_20_Image_0001	18
Varsovie Specs 2019_Page_17_Image_0001	19
Deck-Flag2	19
Deck-Helm	19
Deck-Helm	19
Deck-Helms	19
Deck-Helm3	19
Deck-Mast	20
Deck-Table	20
Deck-Table_3	20

Deck-Table_4	20
Main Salon 1	20
Varsovie Specs 2019_Page_11_Image_0001	20
Main Salon 2	21
Main Salon 3	21
Varsovie Specs 2019_Page_12_Image_0001	21
Varsovie Specs 2019_Page_03_Image_0001	21
Varsovie Specs 2019_Page_08_Image_0001	21
Galley1	21
Galley2	22
Galley3	22
Galley4	22
Galley6	22
Galley7	22
Galley8	22
Captain's Cabin	23
Captain's Cabin 2	23
AftStateroom	23
AftStateroom2	23
VIP Stateroom	23
Engine Room	23
Engine Room 2	24
Bow2	24
Wave	24
Varsovie Specs 2019_Page_06_Image_0001	24
nautor_s_swan-varsovie-small-13	24
CONTACTS	25
Contact details	25
Telephones	25

Office hours	25
Address	25

SPECIFICATIONS

Overview

Varsovie, Swan 100 - 204, was launched in the spring of 2008, she was built by Nautor's Swan in

Finland at their Pietarsaari shipyard.

This luxury vessel's sophisticated exterior design and engineering are the work of German Frers.

Varsovie, as built, is easy to sail and in eleven years has never been out of commission due to equipment failure.

She is a joy to sail, easily reaching 12 knots of boat speed, continually knocking off 250-mile days on crossings previous 100s include the flush deck version, the raised salon version, the S version, and finally Varsovie, a modified S version.

Varsovie differs from the S version in that the front of the coach roof is raised providing both forward facing windows in the salon and an additional 5" headroom in the engine room.

Basic Information

Category: Cruising/Racing Sailboat

Sub Category: Cruising Sailboat

Model Year: 2008

Year Built: 2008

Country: Spain

Dimensions

LOA: 99' 1" (30.20m)

LWL: 86' 4" (26.30m)

Beam: 23' 4" (7.10m)

Max Draft: 13' 6" (4.10m)

Speed, Capacities and Weight

Cruise Speed: 12 Kts. (14 MPH)

Displacement: 185860.7099791 Pounds

Water Capacity: 401.54151904 Gallons

Fuel Capacity: 834.78368432 Gallons

Accommodations

Total Cabins: 4

Hull and Deck Information

Hull Material: Composite Fiberglass

Deck Material: Teak and Fiberglass

Hull Color: DARK BLUE

Exterior Designer: GERMAN FRERS

Interior Designer: GERMAN FRERS

Engine Information

Engines: 1

Manufacturer: Cummins

Model: QSB5.9

Fuel Type: Diesel

DETAILED INFORMATION

SWAN 100-204 VARSOVIE

Varsovie, Swan 100 - 204, was launched in the spring of 2008, she was built by Nautor's Swan in Finland at their Pietarsaari shipyard. This luxury vessel's sophisticated exterior design and engineering are the work of German Frers.

HULL & APPENDAGES

CONSTRUCTION

Varsovie, as built, is easy to sail and in eleven years has never been out of commission due to equipment failure.

She is a joy to sail, easily reaching 12 knots of boat speed, continually

knocking off 250-mile days on crossings previous 100s include the flush deck version, the raised salon version, the s version, and finally Varsovie, a modified s version.

Varsovie differs from the s version in that the front of the coach roof is raised providing both forward facing windows in the salon and an additional 5" headroom in the engine room.

DECK

Deck Equipment

- Retractable Stainless anchor arm with Hense hydraulic actuator
- Lewmar 5000 vertical windlass
- Custom Nautor made flush deck hatches
- Stainless steel pop-up mooring cleats
- Multiplex carbon electric retractable boarding ladder

- Hydraulic controlled swim platform
- Bauer dive compressor

Hydraulic System / Winches

The hydraulic system on Varsovie, is a Bosch-Rexroth custom designed ring-type system engineered to supply all hydraulic functions quietly and smoothly, eliminating any inherent hydraulic noise.

All sailing functions can be powered by a 24-volt Bosch- Rexroth power pack located in the engine room. For additional power there are PTOs on both generators.

A single PTO can supply adequate power to high demand units like the bow thruster and anchor windlass.

Varsovie utilizes a hydraulic “ring system”. In the ring system hydraulic oil circulates the length of the boat through a pair of large diameter stainless pipes. There are 6 valve groups spaced accordingly on the ring for the various functions. Each valve group can be individually shut off from the ring for servicing or in the event of failure of a component.

Hydraulic functions include:

- Jib furler
- Forward mooring winch Sanguinetti
- Anchor windlass
- Anchor swing arm
- Bow thruster
- Outhaul
- Jib halyard tensioner
- Boom vang
- Starboard halyard winch
- Port halyard winch
- Main halyard captive winch
- Starboard primary winch
- Port primary winch
- Starboard secondary winch

- Port secondary winch

- Main sheet winch
- Dinghy winch
- Backstay tensioner
- Auto pilot back up
- Swim platform

INTERIOR LAYOUT

INTERIOR

General

The main salon on Varsovie differs from other Swan 100s by offering a large, forward facing navigation station near the main hatch. The main salon dining table is to starboard with a 42" pop-up TV aft. To port is a "L" shaped couch with a coffee table. The teak interior is finished with satin varnish as are the oak floors. Electric blinds provide privacy on the side windows and all of the overhead lights are dimmable.

Master Cabin (Aft)

The aft stateroom has a large centerline bed. There is a hull window to port with both night shade and wooden louvers. A large hanging locker with a safe is forward to port. On the forward bulkhead is a LCD TV hooked into a Bose Lifestyle sound system. The bathroom with shower is to starboard

The aft port stateroom has a same floor area to the aft stateroom and features a bed, couch, hull window TV, and bathroom of similar characteristics.

Aft Starboard Guest Stateroom

This stateroom can be set up with (2) twin beds or with a single large bed.

There is a dedicated Bose sound system and LCD TV. The attached bathroom has a door to the main corridor providing a suitable day-head for guests.

Port forward Guest Stateroom

This stateroom is located just forward of the main salon and has full bathroom with shower, B&G GFD, Bose sound system and TV.

Galley

- Miele (4) burner gas stove plus (2) burner electric hob KM 400 & KM417
- Miele oven H3140B
- Miele Microwave M625-1EB
- Quooker instant hot water
- Miele dishwasher
- Miele washing machine M2659
- Miele clothes dryer T4659C

- Refrigerators (2) Frigonautic custom built
- Freezers (2) Frigonautic custom built

ENGINE & SYSTEMS

- Main Engine Cummins QSB5.9 305 hp fuel range approx. 2,000 miles at 1500 rpm
- Gear box Marine Gear ZF280-1
- Propeller Brunton Varifold 4-blade folding propeller
- Bow Thruster Hundested FT2R 30 kW

PLUMBING SYSTEMS

The fresh water system on Varsovie includes (2) 750-liter stainless water tanks that can be filled from deck fills on either side of yacht, from city water connection at stern, or via HEM water maker.

The black/grey water system includes a 525-liter holding tank and a Hamann water treatment system. Waste from toilets are pumped directly into holding tank.

There are five transfer tanks that pump grey water from the various sinks and showers to the holding tank.

TANKS

- (2) 750-liter Stainless steel water tanks
- HEM Series 25 water maker
- 5,000 liter per day, 208 liters per hour
- (2) pre-filters, 5 and 25 microns
- Sand filter
- Charcoal filter
- Limestone filter
- Hamann Super Mini water treatment system
- Tecma electric heads throughout yacht
- Condaria PCWM/FCL 22503 reverse cycle air conditioning system
- 90,000 BTU rated cooling capacity
- 112,500 BTU rated heating capacity

ELECTRICAL SYSTEM

The core of Varsovie's electrical system is:

(2) Northern Lights 26 kW generators and (2) 1000 ah banks of gel cell batteries.

The yacht can sail on batteries alone for a solid 8 hours between charges.

At dock, the vessel can take in any power available, from 180 – 520 volts, 47 – 64 Hz, and single or 3 phases.

A single generator can meet all power requirements aboard, including A/C, washing machine, dryer, hot water heater, compressor, and chargers.

(2) Northern Lights M944 26 Kw generators (new 2019)

(2) 1000 ah battery banks, gel cell, switchable power usages (new 2015)

Vektec VSP11 24 kVA Power converter, 180 – 520 volts, 47 – 64 Hz, single or 3 phases

(4) Mastervolt 100-amp battery chargers, (2) for each battery bank

(2) 140-amp alternators on main engine, (1) for each battery bank (1) Mastervolt 24/5000 sine wave inverter for:

Microwave Stove Hob

Engine room ventilation 220-volt outlets

Fresh water pressure pump

(1) Mastervolt 24/2500 sine wave inverter for entertainment system. Inverters are switchable if necessary

ELECTRONIC SYSTEMS

Navigation Instruments

The addition of a proper navigation station on Varsovie was a non-negotiable in the design phase.

Redundancy and backups were key elements in designing the navigational system. There are two completely independent chart plotting systems – one operating on the Furuno NavNet system and the other on a dedicated Lenovo PC. There are dual monitors at the nav station plus monitors at each helm making it possible to display any combination of chart and/or radar at any station.

Chart Plotting and Radar

MaxSea Charting system. Charts can be viewed at nav station or at either steering pod Furuno (C-Map) 1834C-BB charting/radar system at nav station and at both steering pods.

There is also a 4th, spare 1834C-BB mounted in the nav station. Independent radar controls at nav station and both steering pods.

AIS, Furuno FA-150, information available on MaxSea, NavNet II, and dedicated Furuno AIS GPS, Furuno GP-37 WAAS/GPS

Sperry Navigat Mk I gyro compass

Communications Systems

- Fleet 1 Inmarsat satellite phone at nav station (new 2019)
- Yachtspot Wi-Fi locator with powered antenna on spreader.
- Wireless Wi-Fi capabilities throughout the yacht
- VHF Simrad RS-87H with a handset at nav station and a handset at the starboard helm
- SSB Furuno 1570 with tuner and insulated backstay
- Active antenna at mast head for VHF, TV, and FM radio

Entertainment Systems

- KVH M7 satellite TV dome mounted on starboard spreader with LNBS and receivers for SKY TV UK and Direct TV Caribbean
- Salon has a pop-up 40" Sony LCD TV and a Bose Lifestyle 48 DVD/CD/FM stereo system
- Aft Owner's Stateroom has a 32" Sony LCD TV and Bose Lifestyle 38 stereo system
- VIP Stateroom has a 32" Sony LCD TV and Bose Lifestyle 38 stereo system

- Aft Guest Stateroom has a 19" Sony LCD TV and a Bose Lifestyle 3.2.1 stereo system
- Fwd. Guest Stateroom has a 19" Sony LCD TV and a Bose Lifestyle 3.2.1 stereo system
- Cockpit has (4) Bose 32SE speakers hooked up to salon's stereo system with independent control

MAST & RIGGING

Varsovie has a white painted, carbon fiber mast and boom manufactured by Offshore Spars. The mast is constructed over male tooling using an intermediate modulus, uni-directional, pre-impregnated carbon fiber and autoclave cured at 137°C at a pressure of 5.8Bar.

The standing rigging and fittings are manufactured by Navtec, Inc. The running backstays are Aramid fiber, Kevlar 49.

The standing rigging was assembled by Navtec USA, running rigging by Oy Offshore Spars Ab, Finland and Kevlar by Navtec France.

The mast is equipped with a hydraulic mast jack system with removable hydraulic jacking cylinders. This device is used to tension the rigging at dockside.

The mast is designed with four sets of spreaders in a swept-aft configuration. The mast is also equipped with Kevlar running backstays and inner forestay.

The rig was removed in the fall of 2013 at STP Shipyard in Palma de Mallorca with 5-year inspection carried out by A+ Rigging.

All mast and boom fittings were completely disassembled, cleaned, inspected, and serviced. Rig at mast head, gooseneck, and vang were sonic tested.

At this time the Reckmann hydraulic furling unit was sent to Reckmann Germany for a complete servicing.

All foils on furler are new 2013. Inner forestay was replaced. Additionally:

Rod headstay replaced

Rod backstay replaced, along with backstay legs V1, V2, and V3 rod heads sonic tested – passed

RIG DETAILS:

I = 40.0m

131.2 f.t. P= 38.1m

- 125.0 f.t.

E = 12.5m 40.9 f.t.

J = 10.7m 35.1 f.t.

Offshore Spars 4 spreader carbon rig Offshore Spars Park Avenue boom Navtec solid rod Nitronic 50 rigging

Swan 100-204 'Varsovie' Raised Salon Version

Antennas on mast include:

- Furuno 4kW 60cm radar dome scanner
- KVH M7 satellite TV dome
- KVH Fleet 1 satellite telephone
- Furuno AIS GPS antenna
- Furuno GP-320 GPS antenna
- Wi-Fi antenna AC Marine
- AIS VHF antenna
- VHF antenna
- GSM/GPRS antenna
- TV, FM Delta Pacific Antenna

Hydraulic on rig include:

- Boom vang
- Backstay adjusters
- Outhaul
- Cunningham
- Main Halyard
- Inner forestay
- Inner forestay stowage
- Jib furling
- Code 0
- D1, D2, D3, and V4 rods replaced

Winches include:

(2) Primary Jib Sheets – Lewmar 111ST 3-speed hydraulic winches

(2) Secondary sheet winches -- Lewmar 111ST 4-speed hydraulic winches Main sheet winch – Lewmar 111ST 4-speed hydraulic winch

Halyard winches – Lewmar 88 3-speed halyard/reef winches Main halyard is a Lewmar captive winch

EQUIPMENT

General Equipment

CANVASS

- Full sun awning extending from mast to backstays
- Removable bimini
- Covers for winches, steering pods, steering wheels
- Crew covers for cushions in main salon

DINGYS

Aquascan 4.3-meter jet drive rib with Yamaha 160hp engine Honda 10 hp outboard motor

Safety Equipment

- Full MCA Class A medical kit
- (2) Avon 8 man life rafts
- Novec total flooding of engine room space with remote control
- Fire alarm with heat detectors in engine room, aft corridor, main salon, galley, lazarette, sail locker
- Fire Kill system in each generator box with automatic flooding
- Man overboard module MOM mounted to stern rail
- Fire extinguishers in every hanging locker
- Deck fire hoses fore and aft

SAILS

- North 3Di mainsail – new 2017

- North 3Di Dyneema/carbon 107% jib – new 2018
- North Dyneema cruising jib 90% - new 2019
- North A3 asymmetrical spinnaker – new 2013
- North A4 asymmetrical spinnaker – new 2013

EXCLUSIONS

Owner's personal items, including clothes, books, foul weather gear, CDs and DVDs are excluded from sale

Exclusions

Owner's personal belongings.

Disclaimer

The Company offers the details of this vessel or yacht in good faith but cannot guarantee or warrant the accuracy of this information nor warrant the condition of the vessel. A buyer should instruct his representatives, agents, or his surveyors, to investigate such details as the buyer desires validated. This vessel or yacht is offered subject to prior sale, price change, or withdrawal without notice.

PHOTOS

nautor_s_swan-varsovie-full



Sailing-yacht-Varsovie-aft-view-Photo-by-Rolex-Carlo-Borlenghi



Varsovie Specs 2019_Page_01_Image_0003



Deck-Hull



Varsovie Specs 2019_Page_20_Image_0001

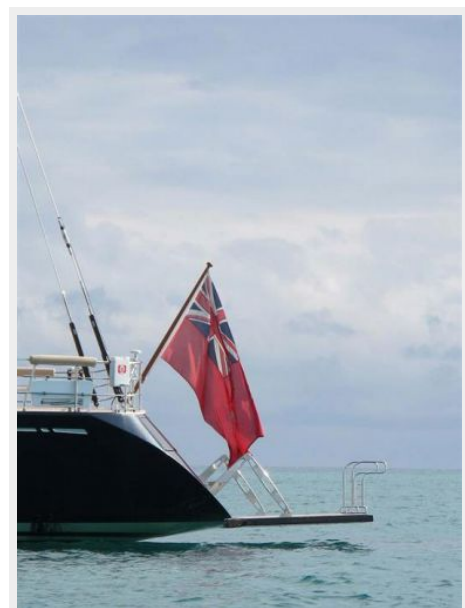

Varsovie Specs 2019_Page_17_Image_0001



Deck-Helm



Deck-Helms



Deck-Flag2

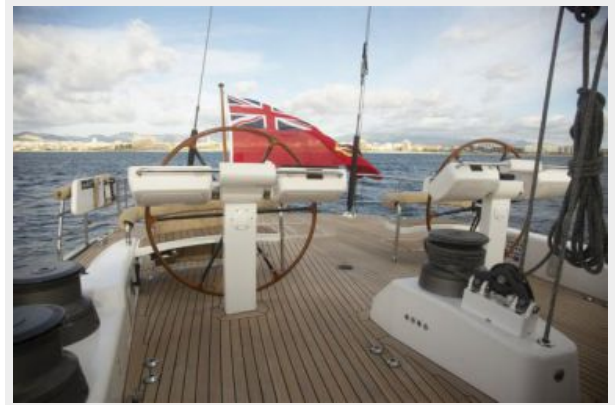

Deck-Helm



Deck-Helm3



Deck-Mast



Deck-Table



Deck-Table_3



Deck-Table_4



Varsovie Specs 2019_Page_11_Image_0001



Main Salon 1



Main Salon 2



Main Salon 3



Varsovie Specs 2019_Page_03_Image_0001 **Varsovie Specs 2019_Page_12_Image_0001**



Varsovie Specs 2019_Page_08_Image_0001

Galley1



Galley2



Galley3



Galley4



Galley6



Galley7



Galley8



Captain's Cabin



Captain's Cabin 2



AftStateroom



AftStateroom2



VIP Stateroom



Engine Room



Engine Room 2



Bow2



Wave



Varsovie Specs 2019_Page_06_Image_0001

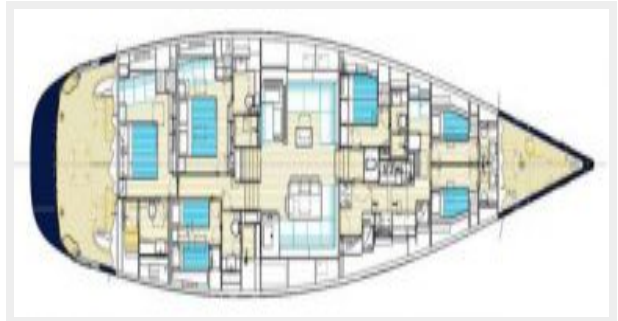

nautor_s_swan-varsovie-small-13

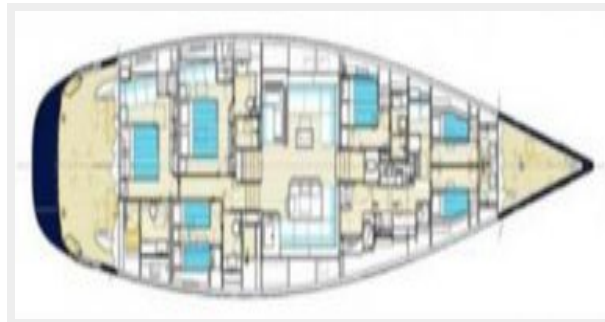

CONTACTS

Andrey Shestakov, leading yacht broker of the sales department of Shestakov Yacht Sales Inc. Shestakov Yacht Sales Inc., the official representative of the Miami/Fort Lauderdale FL headquarters.

Contact details

Email: andrey@shestakovyachtsales.com

Web: shestakovyachtsales.com/en/

Telephones

USA: +1(954)274-4435

Office hours

Monday – Saturday: **9:00 - 21:00** EDT

Sunday: **closed**

Address



Harbour Towne Marina, 850 NE 3rd St,
STE 213, Dania, FL 33004