

GOLDEN HORN — TURKISH GULET



Builder: [Turkish Gulet](#)

Year Built: 1997

Model: Cruising Ketch

Price: PRICE ON APPLICATION

Location: Italy

LOA: 78' 9" (23.99m)

Beam: 21' 4" (6.50m)

Max Draft: 6' 7" (2.00m)

Cruise Speed: 8 Kts. (9 MPH)

Max Speed: 11 Kts. (13 MPH)

Our experienced yacht broker, Andrey Shestakov, will help you choose and buy a yacht that best suits your needs **GOLDEN HORN — Turkish Gulet** from our catalogue. Presently, at Shestakov Yacht Sales Inc., we have a wide variety of yachts available on our sale's list. We also work in close contact with all the big yacht manufacturers from all over the world.

If you would like to buy a yacht **GOLDEN HORN — Turkish Gulet** or would like help answering any questions concerning purchasing, selling or chartering a yacht, please call **+1(954)274-4435**

TABLE OF CONTENTS

TABLE OF CONTENTS	2
SPECIFICATIONS	4
Overview	4
Basic Information	4
Dimensions	4
Speed, Capacities and Weight	4
Accommodations	5
Hull and Deck Information	5
Engine Information	5
DETAILED INFORMATION	6
Accommodations	6
Navigation Equipment	6
On Board Equipment	6
Exclusions	6
Disclaimer	6
PHOTOS	7
f0384919-2663-470c-a3b9-a20189559b63	7
IMG-20181015-WA0005	7
DSC_0058 (FILEminimizer)	7
20181015_163015 (FILEminimizer)	7
IMG-20180730-WA0026	7
DSC_0061 (FILEminimizer)	7
DSC_0044 (FILEminimizer)	8
IMG-20180730-WA0022	8
DSC_0045 (FILEminimizer)	8
DSC_0049 (FILEminimizer)	8
DSC_0047 (FILEminimizer)	8
DSC_0006 (FILEminimizer)	8

DSC_0008 (FILEminimizer)	9
DSC_0009 (FILEminimizer)	9
DSC_0013 (FILEminimizer)	9
DSC_0016 (FILEminimizer)	9
DSC_0017 (FILEminimizer)	9
DSC_0019 (FILEminimizer)	9
DSC_0024 (FILEminimizer)	10
DSC_0051 (FILEminimizer)	10
DSC_0026 (FILEminimizer)	10
4b690491-1dd9-451b-b628-ce14c485dceb	10
DSC_0028 (FILEminimizer)	10
DSC_0032 (FILEminimizer)	10
CONTACTS	11
Contact details	11
Telephones	11
Office hours	11
Address	11

SPECIFICATIONS

Overview

EXCHANGE ASSETS ARE WELCOME!

In 2018: all tanks (diesel, fresh/black/grey water) have been replaced - all batteries have been replaced - new battery charger, inverter & battery switch - engine full overhauling - the gunwale has been partially rebuild, full engine room and bottom bilge repainting - electric & water system fully overhauled - new galley appliances and a 20kw overhauled kohler generator has been fixed - new iroko parquet on the living room - windlass overhauling - new cieling roof and lights system - new bathroom fittings - new rudder blade

Basic Information

Category: Cruising Ketch

Sub Category: Cruising Ketch

Model Year: 2000

Year Built: 1997

Country: Italy

Dimensions

LOA: 78' 9" (23.99m)

Beam: 21' 4" (6.50m)

Max Draft: 6' 7" (2.00m)

MFG Length: 76' 0" (23.15m)

Speed, Capacities and Weight

Cruise Speed: 8 Kts. (9 MPH)

Max Speed: 11 Kts. (13 MPH)

Displacement: 180779.05484 Pounds

Gross Tonnage: 75 Pounds

Water Capacity: 528.344104 Gallons

Fuel Capacity: 528.344104 Gallons

Accommodations

Total Cabins: 7

Sleeps: 16

Hull and Deck Information

Hull Material: Wood

Deck Material: Iroko Wood

Hull Color: WHITE

Hull Finish: Steel

Engine Information

Engines: 1

Manufacturer: Leyland

Model: DOLPHIN

Engine Type: Inboard

Fuel Type: Diesel

DETAILED INFORMATION

Accommodations

7 cabins version Spacious living room with large sofa, table and 2 armchairs and opposite dining table Below deck kitchen with fully appliances (dishwasher, electric oven, twin fridge & freezer, gas stove) and laundry area with washer/dryer 3 forward double cabins with their own bathrooms with showers 2 aft double cabins with their own bathrooms with showers + 2 triple cabins with private bathrooms with showers

Navigation Equipment

VHF ECHO chart plotter Raymarine instrumenti motore / engine instrument ind. angolo di barra / rudder ind. level bussola / compass

On Board Equipment

20kw Kohler generator - Mastervolt 24/100-3 battery charger + Mastervolt Ultra 24/4000 inverter + Mastervolt battery switch 8 service batteries 180amp + 2 engine batteries 180 amp + 1 generator battery TV system predisposition in all cabins + usb ports - cd/mp3 player Sony engine room fire extinguishing system - smoke/fire alarm - full emergency equipment 3.60 Zodiac tender (2016) + 20hp Honda 4 stroke (2018) - manual gangway with davit for tender 600 lt grey water tank + 600 lt black water tank

Exclusions

Owner's personal belongings.

Disclaimer

The Company offers the details of this vessel or yacht in good faith but cannot guarantee or warrant the accuracy of this information nor warrant the condition of the vessel. A buyer should instruct his representatives, agents, or his surveyors, to investigate such details as the buyer desires validated. This vessel or yacht is offered subject to prior sale, price change, or withdrawal without notice.

PHOTOS

IMG-20181015-WA0005



f0384919-2663-470c-a3b9-a20189559b63



20181015_163015 (FILEminimizer)



DSC_0058 (FILEminimizer)



DSC_0061 (FILEminimizer)



IMG-20180730-WA0026



IMG-20180730-WA0022



DSC_0044 (FILEminimizer)



DSC_0045 (FILEminimizer)



DSC_0049 (FILEminimizer)



DSC_0047 (FILEminimizer)



DSC_0006 (FILEminimizer)



DSC_0008 (FILEminimizer)



DSC_0009 (FILEminimizer)



DSC_0013 (FILEminimizer)



DSC_0016 (FILEminimizer)



DSC_0017 (FILEminimizer)



DSC_0019 (FILEminimizer)



DSC_0024 (FILEminimizer)



DSC_0051 (FILEminimizer)



DSC_0026 (FILEminimizer)



4b690491-1dd9-451b-b628-ce14c485dceb

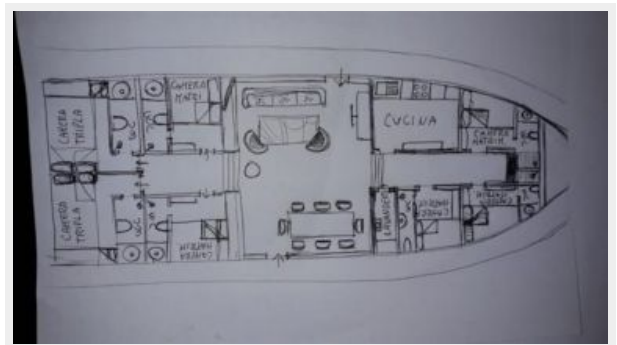

DSC_0028 (FILEminimizer)



DSC_0032 (FILEminimizer)



CONTACTS

Andrey Shestakov, leading yacht broker of the sales department of Shestakov Yacht Sales Inc. Shestakov Yacht Sales Inc., the official representative of the Miami/Fort Lauderdale FL headquarters.

Contact details

Email: andrey@shestakovyachtsales.com

Web: shestakovyachtsales.com/en/

Telephones

USA: +1(954)274-4435

Office hours

Monday – Saturday: **9:00 - 21:00** EDT

Sunday: **closed**

Address



Harbour Towne Marina, 850 NE 3rd St,
STE 213, Dania, FL 33004