

HOPE — HYLAS



Builder: [HYLAS](#)

Year Built: 2012

Model: Cruising Sailboat

Price: PRICE ON APPLICATION

Location: United States

LOA: 56' 4" (17.17m)

Beam: 15' 10" (4.83m)

Min Draft: 6' 4" (1.93m)

Cruise Speed: 8 Kts. (9 MPH)

Max Speed: 8.8 Kts. (10 MPH)

Our experienced yacht broker, Andrey Shestakov, will help you choose and buy a yacht that best suits your needs **HOPE — HYLAS** from our catalogue. Presently, at Shestakov Yacht Sales Inc., we have a wide variety of yachts available on our sale's list. We also work in close contact with all the big yacht manufacturers from all over the world.

If you would like to buy a yacht **HOPE — HYLAS** or would like help answering any questions concerning purchasing, selling or chartering a yacht, please call **+1(954)274-4435**

TABLE OF CONTENTS

TABLE OF CONTENTS	2
SPECIFICATIONS	4
Overview	4
Basic Information	4
Dimensions	4
Speed, Capacities and Weight	4
Accommodations	5
Hull and Deck Information	5
Engine Information	5
DETAILED INFORMATION	6
INTRODUCTION	6
INTERIOR ACCOMMODATIONS	6
NAVIGATION AND ENTERTAINMENT EQUIPMENT	8
ELECTRICAL SYSTEM	9
ENGINE AND MECHANICAL EQUIPMENT	9
MAST AND RIGGING	10
HULL AND DECK	10
SAFETY EQUIPMENT	12
EXCLUSIONS	12
Exclusions	12
Disclaimer	12
PHOTOS	13
Main Salon, Port	13
Main Salon, Starboard	13
Forward Cabin	13
Forward Head	13
Port Cabin	14
Main Salon, Looking Aft	14

Nav Station	14
Owner's Cabin	14
Owner's Head	14
Owner's Cabin, Forward	14
Owners Shower	15
Galley, Looking Aft	15
Galley, Looking Forward	15
Stemhead	15
Foredeck	15
Deck, Looking Aft	15
Deck, Looking Forward	16
Enclosures	16
Cockpit, Looking Forward	16
Cockpit, Looking Aft	16
Aft Deck	16
Aft Quarter	16
Rig	17
Stern View	17
Engine Space	17
Propeller	17
Underbody	17
Elevation Plan	17
HOPE_Layout-Plan	18
CONTACTS	19
Contact details	19
Telephones	19
Office hours	19
Address	19

SPECIFICATIONS

Overview

The Frers-designed Hylas 56 has proven to be the ideal size for a couple or family to easily operate and comfortably live aboard for extended periods. HOPE is a rare offering on the brokerage market that features a long list of desirable options, including carbon in-mast furling and a shoal-draft keel. She has seen limited use and is an ideal candidate for one looking for a quality yacht to enjoy time on the water.

Basic Information

Category: Cruising Sailboat

Sub Category: Aft Cockpit

Model Year: 2012

Year Built: 2012

Country: United States

Vessel Top: Bimini Top

Cockpit: Yes

Dimensions

LOA: 56' 4" (17.17m)

LWL: 50' 5" (15.37m)

Beam: 15' 10" (4.83m)

Min Draft: 6' 4" (1.93m)

Clearance: 73' 0" (22.25m)

Speed, Capacities and Weight

Cruise Speed: 8 Kts. (9 MPH)

Max Speed: 8.8 Kts. (10 MPH)

Displacement: 50200 Pounds

Water Capacity: 232 Gallons

Holding Tank: 64 Gallons

Fuel Capacity: 320 Gallons

Accommodations

Total Cabins: 3

Sleeps: 8

Total Heads: 2

Hull and Deck Information

Hull Material: Fiberglass

Deck Material: Fiberglass

Hull Color: Flag Blue

Hull Finish: Stainless Steel

Hull Designer: GERMAN FRERS

Engine Information

Engines: 1

Manufacturer: Yanmar

Model: 4BY2 150

Engine Type: Inboard

Fuel Type: Diesel

DETAILED INFORMATION

INTRODUCTION

The Frers-designed Hylas 56 has proven to be the ideal size for a couple or family to easily operate and comfortably live aboard for extended periods. HOPE is a rare offering on the brokerage market that features a long list of desirable options, including carbon in-mast furling and shoal-draft keel. She has seen limited use and is an ideal candidate for one looking for a quality yacht to enjoy time on the water.

INTERIOR ACCOMMODATIONS

HOPE sleeps six in three private cabins, plus 2-3 in the main salon. The interior joiner work is varnished teak and generous solid teak trim with a satin finish and optional raised-panel door cabinetry style throughout. Cabin soles are varnished teak with contrasting holly inlays. White fabric overhead panels with Oceanair hatch screens and blinds in all cabins. Interior fabric is all chamois Ultraleather in excellent condition. There are flush chrome LED overhead lights and reading lights as well as two-speed fans throughout.

Forward Cabin

Starting forward, this cabin features a large queen berth with lockers each side and a seat to starboard. Additional storage includes a hanging locker, multiple drawers and a shelf locker. Well-lit and ventilated, with a large hatch and two opening portholes.

Port Cabin

The second guest cabin is aft and to port and features a generous berth that extends to a double, allowing for extensive storage space below. There are multiple drawers and lockers, hatch, two portholes and dorade vent for light and ventilation.

Forward Head

Opposite to starboard is the forward guest head, which features a vanity with Corian counter, mirrored lockers and a Jabsco Quiet Flush toilet. There is a separate shower stall and two

access doors – one private from the forward cabin and one from the passageway.

Main Salon

Amidships is a large, bright, open main salon, thanks to the raised-deckhouse design with large windows on all sides, (2) deck hatches and (2) hull portlights. To port is a comfortable dinette with L-shaped settee outboard and movable bench seats inboard. The custom drop-leaf dining table features a beautiful compass rose inlay. To starboard is a full-length settee with storage lockers at each end. There are multiple storage compartments under and outboard both of the settees.

Nav Station

Aft and to port is an L-shaped nav station with custom wood seat. There is a full-size chart table and to one side a lift-up laptop table. Here one finds communication/nav equipment, as well as electrical breaker panels and main switches.

Galley

One of the impressive design features of the Hylas 56 is the immense galley that runs aft for 11' between the salon and owner's cabin. No lack of counter space here, plus there are many lockers and drawers both inboard and outboard, including a full-height pantry. Well ventilated with (4) opening portholes. Additional features:

- Corian countertops
- Twin stainless steel sinks with retractable faucet
- Force 10 three-burner stainless stove with oven
- Removable stop top cover with matching Corian surface and stainless back that slides into pocket outboard of stove
- Front-opening refrigerator under counter
- Vitrifrigo dual-drawer refrigerator/freezer
- Isotherm beverage cooler
- Sharp microwave/convection oven (2014)
- Fresh water foot pump
- Knife storage rack

Owner's Cabin

The spacious full-beam master suite aft is accessed through the galley passageway. This cabin

features a king sized berth, with bureau and full-height lockers each side. There are also numerous drawers under the berth and a deep hanging locker forward on centerline. Four opening portholes, two hull portlights and a large deck hatch provide plenty of light and ventilation. There is a full-length mirror and a 32" flat screen TV.

Owner's Head

Features a vanity with Corian counter, mirrored lockers and Jabsco Quiet Flush toilet. A private shower stall is attached, with teak grate and linen closet outboard.

NAVIGATION AND ENTERTAINMENT EQUIPMENT

- Furuno NAVnet 14" displays at helm and nav station
- Furuno DRS4D 4 kW radar
- FA50 AIS system
- Furuno 711 autopilot
- (2) Furuno multi displays in cockpit
- Furuno wind display in cockpit
- DFFI fish finder
- ICOM M504A VHF with Command Mic II at helm
- ICOM M802 SSB
- Proctor modem for SSN data transmissions
- Iridium sat phone
- iMac PC with 27" screen (2015)
- Linksys wireless router
- Sirius weather system

Entertainment Equipment

- Samsung 40" LCD screen in main salon with Blu Ray disc player
- Samsung 32" LCD screen in owner's cabin with Blu Ray disc player
- Bose V35 series HDMI system
- Bose speakers in each cabin, main salon, cockpit and aft deck

ELECTRICAL SYSTEM

- 12/24 volt DC and 110/220 volt AC electric systems with tinned wiring throughout
- Dedicated breaker panels with meters
- Northern Lights 6 KW generator (1,232 hours)
- Mastervolt 100 amp battery charger
- Twin 150 amp house and engine alternators
- Mastervolt 12/2500-100 inverter/charger
- (4) Lifeline AGM 8D house batteries, each rated 255 amp hour (new 2020)
- (2) Lifeline AGM 8D house batteries, each rated 255 amp hour (new 2020), for windlass and bow thruster
- (1) Lifeline AGM 4D engine start battery (new 2020), and (1) gen start battery
- All batteries self-contained, strapped and secured
- Xantrex Link DC monitor panel
- 50 amp shore power service port and starboard with 50' cord
- 230 volt/32 amp shore service with ACME transformer and DEI 50 amp galvanic isolator
- DC control panel next to helm to control windlass and all mast and running lights
- Solar panels on bimini
- Cockpit lights under bimini

ENGINE AND MECHANICAL EQUIPMENT

- Yanmar 125 hp 4-cylinder turbo diesel (1,450 hours)
- Single-lever throttle and shift control system
- Flexifold three-blade 20" folding prop
- Spurs line cutters
- Fire retardant engine room sound insulation
- Fireboy fire suppression in engine room
- Dual Racor filters for engine with bypass valve
- Groco oil change pump for engine and generator
- Cruise Air reverse cycle air conditioning (three zones, 40,000 BTU total)
- Sidepower dual propeller bow thruster
- (2) Independent electric bilge pump systems – one automatic, one manual control
- Manual bilge pump
- 232 gallons water (three tanks – stainless steel)
- 320 gallons fuel (five tanks – stainless steel)
- Dual Shurflow freshwater pumps (both new 2018)
- (2) Independent holding tanks, one dedicated to each head with overboard and deck pump-out
- Seaward 20 gallon hot water heater heated via engine driven system or AC supply
- (2) 20 lb. propane tanks in sealed deck locker starboard side
- Weema tank level indicators
- Splendide washer/dryer

- Spectra 24 volt watermaker

MAST AND RIGGING

- Custom GMT carbon fiber triple-spreader mast with in-mast furling and Selden boom
- BSI standing rod rigging with aluminum shroud rollers
- Insulated backstay
- Harken roller furling forestay
- Quick release inner forestay with running backstays
- GMT carbon whisker pole
- Selden boom vang
- Lewmar mainsheet traveler
- Storm trysail track on mast
- Masthead anchor and tricolor light
- Steaming light
- Foredeck light
- Spreader lights

Winches:

- (2) Antal W-66 ST electric primary winches
- (1) Antal W-48 ST electric mainsheet winch
- (1) Antal W-48 ST electric outhaul winch
- (2) Antal W-52 ST electric/manual secondary winches (one electric port side for genoa furling)
- (2) Antal W-48 ST halyard winches on mast

Sails:

- Doyle Stoway mainsail (2015)
- Doyle 135% genoa (2012)
- Doyle asymmetrical spinnaker with sock
- Doyle staysail
- Doyle storm trysail

HULL AND DECK

The hull incorporates Twaron, a carbon aramid fiber with alternating FRP fibers that was hand laid with no core and using Vinylester resins and Isophthalic gel coat. There is a skeg-hung rudder for optimal strength and protection and a teak rubrail with stainless steel striker. Topsides

are Flag Blue Awlgrip with single white boot stripe and gold cove stripe, and the bottom is red (new, spring 2020).

The deck is molded fiberglass with balsa core and solid fiberglass in all areas of deck for deck fittings and higher stress areas. White gelcoat with moondust non-skid molded in.

Details:

- Maxwell Nilsson WC 2500 windlass (new 2018) with chain counter and remote cockpit controls
- Solid stainless stem head fitting with split bow roller
- Rocna 40 kg anchor with 250' 3/8" HT all-chain rode
- Fortress FX-55 anchor with rode and chain
- Saltwater wash down for anchor
- Large forward step-down forepeak locker with separate chain locker forward
- (2) Large stern lazarettes, port and starboard
- 32" high stanchions/lifelines with stern rail extended forward to side gates
- Customized bow rail extended aft six feet
- Teak/stainless seats each side on foredeck
- Built-in stern seats, each side with cushions
- Stern swim platform with stainless steel grab rails and drop-down ladder
- Hinged door in transom to access garage
- Freshwater hot and cold shower on stern platform
- (6) Stainless steel deck hatches
- (14) Stainless steel opening portholes
- (4) Hull portlights
- (2) Solid stainless cowl vents
- Stainless handrails on foredeck, deckhouse and aft deck
- Teak toe rail with custom stainless steel chocks
- One pair of stainless steel 12" bow cleats, two pairs of 12" midship cleats and one pair of 12" stern cleats
- Teak/stainless side boarding ladder with port and starboard mounting bracket
- Lewmar pedestal with Mamba steering system and stainless wheel
- Ritchie 6" compass
- Solid teak varnished cockpit table with drink holders and insulated cooler
- Stainless steel companionway handrails
- Laid teak cockpit floor and cockpit seat tops
- Varnished teak companionway hatch slides
- Lexan companionway hatch slides
- Cockpit bimini with full front/ side panels and helm station window (all new 2017)
- Cockpit cushions

- Simpson S250 stainless dinghy davits (new motors 2018)
- Highfield 11' RIB with 20 hp 4-stroke outboard
- Misc. spares
- Tool kit
- Bosun's chair
- Stainless gas grill
- Docklines and fenders

SAFETY EQUIPMENT

- Winslow Offshore 6-person life raft mounted on stern rail
- EPIRB
- (8) Life jackets
- Jon Buoy MOB module
- Flares
- (2) Horseshoe life rings
- Emergency tiller
- Man overboard light
- Jacklines
- Bell
- Horn
- Advantage medical kit

EXCLUSIONS

- Owner's personal effects are excluded from the sale
- Artwork

Exclusions

Owner's personal belongings.

Disclaimer

The Company offers the details of this vessel or yacht in good faith but cannot guarantee or warrant the accuracy of this information nor warrant the condition of the vessel. A buyer should instruct his representatives, agents, or his surveyors, to investigate such details as the buyer desires validated. This vessel or yacht is offered subject to prior sale, price change, or withdrawal without notice.

PHOTOS

Main Salon, Port



Main Salon, Starboard



Forward Cabin



Forward Head



Port Cabin



Main Salon, Looking Aft



Nav Station



Owner's Cabin



Owner's Cabin, Forward



Owner's Head



Owners Shower



Galley, Looking Aft



Galley, Looking Forward



Stemhead



Foredeck



Deck, Looking Aft



Deck, Looking Forward



Enclosures



Cockpit, Looking Forward



Cockpit, Looking Aft



Aft Deck



Aft Quarter



Stern View



Rig



Engine Space



Propeller



Underbody

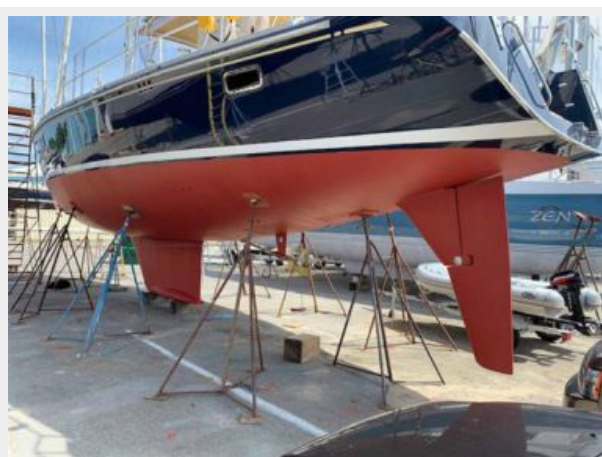

Elevation Plan

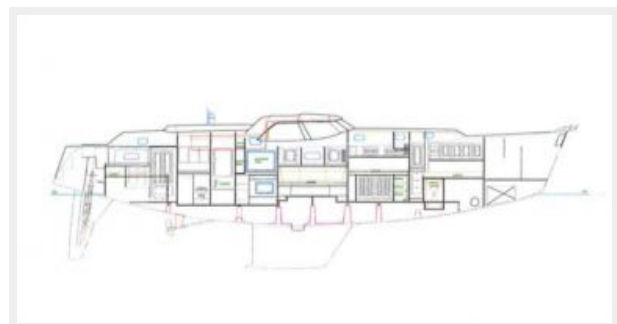

HOPE_Layout-Plan

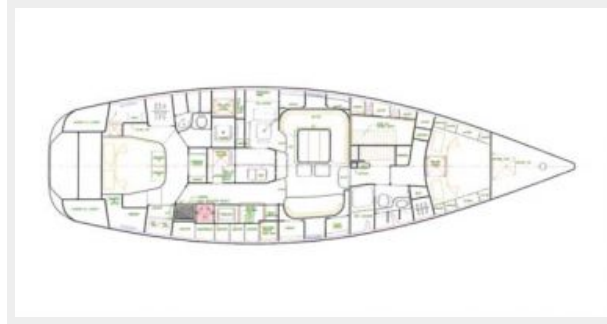

CONTACTS

Andrey Shestakov, leading yacht broker of the sales department of Shestakov Yacht Sales Inc. Shestakov Yacht Sales Inc., the official representative of the Miami/Fort Lauderdale FL headquarters.

Contact details

Email: andrey@shestakovyachtsales.com

Web: shestakovyachtsales.com/en/

Telephones

USA: +1(954)274-4435

Office hours

Monday – Saturday: **9:00 - 21:00** EDT

Sunday: **closed**

Address



Harbour Towne Marina, 850 NE 3rd St,
STE 213, Dania, FL 33004