

## SANLORENZO SX76 #44 — SANLORENZO



**Builder:** SANLORENZO

**Year Built:** 2020

**Model:** Motor Yacht

**Price:** PRICE ON APPLICATION

**Location:** Italy

**LOA:** 78' 0" (23.75m)

**Beam:** 21' 8" (6.60m)

**Max Draft:** 5' 5" (1.65m)

**Cruise Speed:** 18 Kts. (21 MPH)

**Max Speed:** 22 Kts. (25 MPH)

Our experienced yacht broker, Andrey Shestakov, will help you choose and buy a yacht that best suits your needs **Sanlorenzo SX76 #44 — SANLORENZO** from our catalogue. Presently, at Shestakov Yacht Sales Inc., we have a wide variety of yachts available on our sale's list. We also work in close contact with all the big yacht manufacturers from all over the world.

If you would like to buy a yacht **Sanlorenzo SX76 #44 — SANLORENZO** or would like help answering any questions concerning purchasing, selling or chartering a yacht, please call **+1(954)274-4435**

# TABLE OF CONTENTS

TABLE OF CONTENTS	2
SPECIFICATIONS	3
Overview	3
Basic Information	3
Dimensions	3
Speed, Capacities and Weight	3
Accommodations	3
Hull and Deck Information	4
Engine Information	4
DETAILED INFORMATION	5
Sanlorenzo SX76 #44	5
Accommodations	5
Equipment	5
Extra Equipment	5
Exclusions	7
Disclaimer	7
PHOTOS	8
Floorplan-Sanlorenzo-SX76-44-lengers-yachts	14
Floorplan-Sanlorenzo-SX76-44-Lengers-Yachts-1	14
Floorplan-Sanlorenzo-SX76-44-for-sale-Lengers-Yachts	14
Floorplan-Sanlorenzo-SX76-44-Lengers-Yachts-2	14
CONTACTS	15
Contact details	15
Telephones	15
Office hours	15
Address	15

---

# SPECIFICATIONS

---

## Overview

---

This luxury yacht SX76 from Sanlorenzo was built in 2020. It offers a lot of space with four spacious cabins plus one for a crew.

## Basic Information

---

**Category:** Motor Yacht

**Model Year:** 2020

**Year Built:** 2020

**Country:** Italy

**Fly Bridge:** Yes

## Dimensions

---

**LOA:** 78' 0" (23.75m)

**Beam:** 21' 8" (6.60m)

**Max Draft:** 5' 5" (1.65m)

## Speed, Capacities and Weight

---

**Cruise Speed:** 18 Kts. (21 MPH)

**Max Speed:** 22 Kts. (25 MPH)

**Displacement:** 147709.71554 Pounds

**Water Capacity:** 369.8408728 Gallons

**Fuel Capacity:** 1149.1484262 Gallons

## Accommodations

---

**Total Cabins:** 4

**Total Berths:** 8

**Sleeps:** 8

**Total Heads:** 4

**Crew Berths:** 1

**Crew Sleeps:** 1

---

## Hull and Deck Information

---

**Hull Material:** GRP

**Hull Configuration:** Semi-Displacement

**Hull Color:** white

---

## Engine Information

---

**Engines:** 2

**Manufacturer:** Volvo Penta

**Model:** IPS 1050

**Engine Type:** Inboard

**Fuel Type:** Diesel

---

# DETAILED INFORMATION

---

## Sanlorenzo SX76 #44

---

This Sanlorenzo yacht SX76 #44 is exclusively for sale at Lengers Yachts.

The yacht is newly built in 2020. The yacht is equipped with 2 Volvo engines IPS 1050 provided with 800 hp. It can accommodate up to 8 people plus crew.

The SX model integrates aesthetic and functionality in a perfect way. It offers an intelligent technic, practical and rational solutions and at the same way the characteristic elegance of the brand.

## Accommodations

---

- Icemaker with external refill on flybridge
- Watermaker - Idromar 180 L/h
- Airconditioning - 95000 BTU/h
- Televisions - 43" in owners cabin
- Sat. dish - receiver - KVH TV6 TV-sat antenna
- Soundsystem - Audio video gold package
- Internet - 4G Wifi system predisposition with harbour hot spot antenna

## Equipment

---

- Stabilizers - Electric
- Generator - second additional 28kW
- Battery Charger - 12V / 25A charger for generators
- Underwater lights - No. 4
- Bimini Top - Sun awning for the stern area of the flybridge behind the hardtop

## Extra Equipment

---

---

## ALARMS AND CONTROLS

- 12V 25A battery charger for generators
- No. 2 additional waterproof sockets: no. 1 on flybridge bar, no. 1 USB on helm station

## ALARMS AND CONTROLS

- Raymarine CCTV IP: no. 1 fixed in cockpit, no. 1 fixed in engine room
- Predisposition for additional Raymarine touch screen 12" monitor (ship monitoring system with empirbus) in crew mess
- Raymarine integrated dashboard system (ship monitoring) including third additional Raymarine monitor
- Raymarine diamond navigation package (diff. from standard)

## SATELLITE AND COMMUNICATION SYSTEMS (TV SAT)

- KVH TV6 TV-sat antenna
- KVH TV6 empty radome

## AUDIO AND VIDEO APPLIANCES\*

- 4G Wi-Fi system predisposition with harbour hot spot antenna
- TV 43" in owner's cabin (diff. from standard)
- Audio-video gold package

## HOUSEHOLD APPLIANCES

- Ice maker with external refill on flybridge

## INTERIOR ACCESSORIES

- Open galley layout modification
- Headshower in vip cabin
- Black opaque lacquered Foresti & Suardi round spotlights throughout the boat (diff. from standard)
- No. 4 washbasin integrated in standard marble in every bathroom (diff. from standard)
- Parquet in salon (diff. from standard)
- Dining table in Oceanic Brown Ex Mar Polished marble with rounded corners and central base in wood (diff. from standard)
- Aft wall with manual sliding panel in glass, finishing to be confirmed, and metal frame, in dining area
- TV behind fumè stopsol mirror in owner's cabin (diff. from standard)
- No. 2 custom TV cabinets in guest cabins
- No. 2 manual roller black-out curtains in owner's cabin
- L-shaped Minotti Andersen Slim sofa in standard textile model in salon and no. 1 chaise longue in same fabric
- Minotti Huber coffee table with Carrara marble top

- Supertuft Santushti Shell carpet

## EXTERIOR ACCESSORIES

- Hardtop with electric openable roof system with blades
- Sun awning for the stern area of the flybridge behind the hardtop
- Teak floor on flybridge
- Side windows of the flybridge with electric opening system
- Teak floor in beach area
- Backlit boat name predisposition
- Air conditioned on flybridge (including additional custom cabinet)
- No. 4 underwater lights: no. 2 in aft transom and no. 2 on the side

## Swimming platform lifting system

- Electric hi-lo table in teak on flybridge
- Custom L-shaped sofa on flybridge with drawers, structure in teak and Roda fabric (diff. from standard)
- No. 4 additional Roda Orson folding chairs
- Bow table with hi-lo manual system for transformation into sunbed, including additional cushion

## THRUSTERS AND STABILIZERS

- Volvo Joystick for engines IPS transmissions – second cockpit station
- Electric stabilizers (at anchor and under navigation)

## ENGINE ROOM EQUIPMENT

- Idromar 180 l/h watermaker
- Second additional 28kW generator

## Exclusions

---

Owner's personal belongings.

## Disclaimer

---

The Company offers the details of this vessel or yacht in good faith but cannot guarantee or warrant the accuracy of this information nor warrant the condition of the vessel. A buyer should instruct his representatives, agents, or his surveyors, to investigate such details as the buyer desires validated. This vessel or yacht is offered subject to prior sale, price change, or withdrawal without notice.

# PHOTOS

















**Floorplan-Sanlorenzo-SX76-44-lengers-yachts**

**Floorplan-Sanlorenzo-SX76-44-Lengers-Yachts-1**

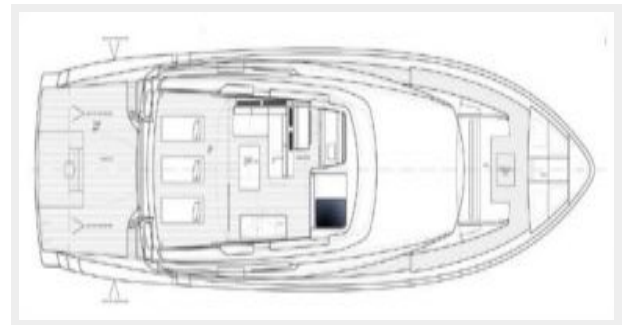

**Floorplan-Sanlorenzo-SX76-44-for-sale-Lengers-Yachts**

**Floorplan-Sanlorenzo-SX76-44-Lengers-Yachts-2**

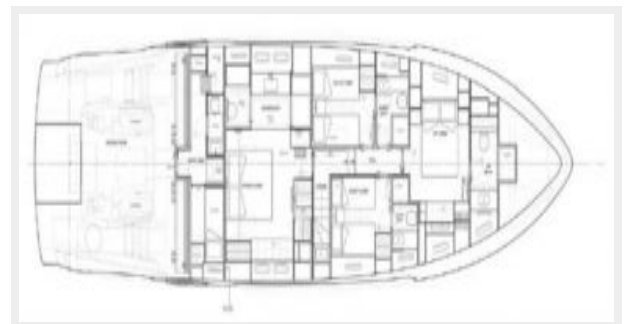
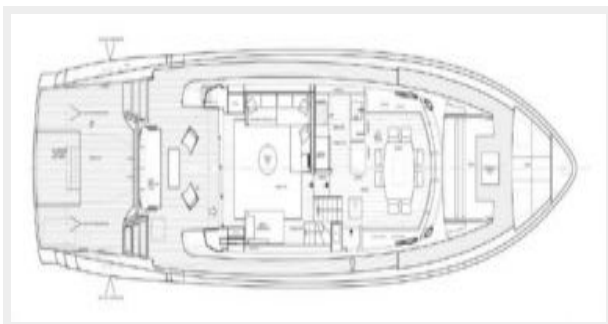

---

# CONTACTS

---

Andrey Shestakov, leading yacht broker of the sales department of Shestakov Yacht Sales Inc. Shestakov Yacht Sales Inc., the official representative of the Miami/Fort Lauderdale FL headquarters.

---

## Contact details

---

Email: [andrey@shestakovyachtsales.com](mailto:andrey@shestakovyachtsales.com)

Web: [shestakovyachtsales.com/en/](http://shestakovyachtsales.com/en/)

---

## Telephones

---

USA: +1(954)274-4435

---

## Office hours

---

Monday – Saturday: **9:00 - 21:00** EDT

Sunday: **closed**

---

## Address

---



Harbour Towne Marina, 850 NE 3rd St,  
STE 213, Dania, FL 33004