

BANDIDO — OYSTER MARINE LTD



Builder: OYSTER MARINE LTD

Year Built: 2011

Model: Cruising Sailboat

Price: PRICE ON APPLICATION

Location: United States

LOA: 63' 6" (19.35m)

Beam: 17' 10" (5.44m)

Max Draft: 9' 2" (2.79m)

Our experienced yacht broker, Andrey Shestakov, will help you choose and buy a yacht that best suits your needs **BANDIDO — OYSTER MARINE LTD** from our catalogue. Presently, at Shestakov Yacht Sales Inc., we have a wide variety of yachts available on our sale's list. We also work in close contact with all the big yacht manufacturers from all over the world.

If you would like to buy a yacht **BANDIDO — OYSTER MARINE LTD** or would like help answering any questions concerning purchasing, selling or chartering a yacht, please call **+1(954)274-4435**

TABLE OF CONTENTS

TABLE OF CONTENTS	2
SPECIFICATIONS	5
Overview	5
Basic Information	5
Dimensions	5
Speed, Capacities and Weight	5
Accommodations	5
Hull and Deck Information	6
Engine Information	6
DETAILED INFORMATION	7
INTRODUCTION	7
CONSTRUCTION	7
DECK	7
ACCOMMODATIONS	8
ENTERTAINMENT EQUIPMENT	11
DECK EQUIPMENT	11
RIG and SAIL HANDLING	12
MACHINERY	13
TANKAGE AND PLUMBING	14
ELECTRICAL SYSTEM	15
NAVIGATION and COMMUNICATION EQUIPMENT	16
SAFETY EQUIPMENT	18
ADDITIONAL EQUIPMENT	19
EXCLUSIONS	19
Exclusions	19
Disclaimer	19
PHOTOS	20
Sailing	20

Sailing	20
Sailing	20
Saloon Port Settee, Looking Fwd.	20
Port Settee	20
Saloon, Stbd	20
Hull Port Windows	21
Saloon Aft	21
Nav Station	21
Owner's Cabin	21
Owner's Cabin Settee	21
Owner's Cabin Fwd.	21
Owner's Head	22
Stbd. Guest Cabin	22
Stbd. Guest Head Shower	22
Galley	22
Refrigerator	23
Freezer	23
Washer/Dryer	23
Easy Access to Plumbing	23
At Sea	24
Windlass and Furlers	24
Foredeck	24
Window Profile	24
Cockpit, Fwd.	24
Cockpit	24
Cockpit	25
Twin Wheels	25
Cockpit	25
Port Helm	25

Stbd. Helm	25
Folding Cleats	25
Hydraulic Furler	26
Mainsheet	26
Engine	26
At Sea	26
BANDIDO Interior Layout	26
CONTACTS	27
Contact details	27
Telephones	27
Office hours	27
Address	27

SPECIFICATIONS

Overview

Bright 4-cabin layout with maple joinery and teak soles. "Seascape" hull windows, tasteful maple joinery. Huge twin-wheel cockpit, hydraulic sail handling, new electronics, newly painted spars and more. Awesome performer.

Basic Information

Category: Cruising Sailboat

Sub Category: Deck Saloon

Model Year: 2011

Year Built: 2011

Refit Year: 2019

Refit Type: Navigation/Comms

Country: United States

Vessel Top: Bimini Top

Cockpit: Yes

Dimensions

LOA: 63' 6" (19.35m)

LWL: 56' 6" (17.22m)

Beam: 17' 10" (5.44m)

Max Draft: 9' 2" (2.79m)

Speed, Capacities and Weight

Displacement: 73823 Pounds

Water Capacity: 317 Gallons

Fuel Capacity: 449 Gallons

Accommodations

Total Cabins: 4

Total Berths: 6

Sleeps: 8

Total Heads: 3

Hull and Deck Information

Hull Material: Fiberglass

Deck Material: Teak

Hull Color: White

Hull Finish: Plastic

Engine Information

Engines: 1

Manufacturer: Volvo

Model: D4

Engine Type: Inboard

Fuel Type: Diesel

DETAILED INFORMATION

INTRODUCTION

The Oyster 625 is part of Oyster Marine's current model line, taking the place of the highly successful Oyster 62, of which 21 hulls were made.

Perhaps the most notable feature of the 625 series are the vertical "sea-scape" hull port windows. A concept derived from much larger superyachts, this feature creates an amazing view to the outside world from down below. The new hull design has a narrow entry with beam carried aft making for a fast, comfortable ride at sea with the buoyancy needed for a long-distance cruising load carrier.

On deck, sail systems are fully automated and operated from the helm, making a yacht that can be easily run as an owner-operator.

Below decks BANDIDO boasts four spacious cabins plus forepeak/workshop. The interior joinery is of white maple with rich, contrasting teak soles. Loaded with amenities, BANDIDO is a pleasure to be aboard for extended cruising.

Due to a change in owner's plans, BANDIDO is seriously for sale and represents a significant savings over new construction, without the wait.

CONSTRUCTION

HULL:

The fiberglass hull is laid-up single skin with structural stringers and floors to Lloyds-approved design specifications. The outer hull laminate incorporates Kevlar and carbon fiber, built to comply with the requirements stipulated in the European Union's recreational craft directive (EURCD) to meet design category A – 'Ocean.'

HULL COLOR:

White with blue cove line and double boot top lines. Stern design incorporates a swim platform, finished in laid teak and molded fiberglass steps trimmed with teak, for access to the stern deck, and fitted with a deep stainless steel bathing ladder with oval treads.

DECK

- Oyster deck saloon with 'G5' styling and 'eyebrow' feature

- The cockpit is split into separate steering and guest/crew areas
- Aft cockpit has a clear central walkway between twin wheels, providing excellent access to the aft deck
- Main guest cockpit has a large high-gloss varnished central table with folding leaves and integral refrigerator
- Teak-laid decks, epoxied down
- Deck edge incorporates a bulwark, allowing relatively flat side decks
- Top of bulwark is clean fiberglass with a rolled edge
- C-Quip stainless steel folding mooring cleats
- Stainless steel pulpit, pushpit and gateway midship stanchions
- Gate to pushpit
- Stern quarter pushpit seats crafted of teak and stainless steel
- Stainless steel grab rails atop deck saloon
- Life raft stowage built vertically into STB pushpit with hydrostatic release
- Lazarette locker with twin stainless steel gas struts
- Stainless steel rail for rope stowage
- Gas locker for (2) 20 lb. propane cylinders
- Stainless steel dorades

STEERING

- Steering by Lewmar torque rod system at twin pedestals with 44” Mini-Maxi stainless steel wheels
- (2) Brown suede leather wheel covers

ACCOMMODATIONS

GENERAL DESCRIPTION:

Eight berths in four cabins, excluding the saloon. Interior joinery finished in maple. Essential features include high-polished stainless steel grab rails, ‘shadow-gap’ joints between panels and Oyster custom knobs for lockers and drawers. Teak cabin sole. Surfaces in galley are ‘Pearl’ Avonite. Surfaces in heads are ‘Cozumel’ Avonite. Headlining in off-white vinyl. Ivory leather upholstery. Lee cloths to each berth. Roman blind systems in all cabins. Oceanair sky screens on all deck hatches. Fly screens on all opening hull and coach roof ports. Caframo cabin fans. “Ocean view” fixed hull windows. Custom fitted linens.

LAYOUT (From Forward)

SAIL LOCKER:

Access via watertight door in port cabin forward head and via deck hatch with stainless steel ladder.

Deep, with plenty of storage for fenders and off-wind sails. Fold-down pipe berth.

TWIN GUEST CABIN:

Forward to port with upper and lower berths. Storage in hanging locker and drawers. Ventilation with hull port and overhead hatch.

PORT FWD. HEAD:

Basin with vanity mirror and storage. Separate shower stall, Par Quietflush toilet.

DOUBLE CABIN

To starboard with double berth, locker, drawers, hanging locker and under-berth lockers. Ventilation with hull port and overhead hatch.

ENSUITE HEAD:

Basin with vanity mirror and storage. Separate shower stall, Par Quietflush toilet.

MAIN SALOON:

(6) Large vertical fixed hull windows bring the outside seascape in. At deck level, there are two Oyster trademark large forward-opening deck saloon windows with gas struts. The main living space features a large, L-shaped settee to starboard around a maple table with a teak trimmed surround line. Bottle storage within table base in locker. There is a shorter settee to port plus two loose folding captain's chairs. A 32" TV on a lift hides behind port settee when not in use.

GALLEY:

Located aft of the saloon to port. Galley features include:

- Stainless steel, gimbaled Force 10 gas stove with (5) burners, grill and oven
- Alpes range exhaust hood
- Tall Frigomatic front-opening fridge inboard with brushed stainless steel doors
- Front-opening freezer box
- Custom built-in Fisher and Paykal dishwasher
- Twin stainless steel sinks
- Panasonic microwave oven
- Oyster customized Sheffield stainless steel cutlery
- Splendide washer/dryer in cabinet port forward side

All surfaces and upstands in 'Pearl' Avonite. There is abundant storage in cabinets and drawers throughout.

NAVIGATION AREA:

To starboard of saloon with chart table, locker and bookshelf. Electrical service panel located inboard aft of companionway within easy reach. Battery isolation breakers.

CREW CABIN:

Steps lead down from navigation area into passageway with access to a twin-berth crew cabin. There are double doors opening into engine room for great access.

ENGINE ROOM:

Sound-insulated with 24 V lighting and extractor fans. Accessed via double-hinged doors from crew cabin.

OWNER'S STATEROOM:

Aft cabin has a queen berth centerline with under-berth drawers, dressing table/desk and large hanging lockers with built-in safe. There are numerous drawers and lockers for storage and a 26" flat screen TV mounted on the forward bulkhead. Private access via sliding hatch and ladder to the aft deck. Plenty of ventilation with large deck-opening hatches, opening hull ports and coach roof windows.

EN-SUITE HEAD:

Aft cabin to starboard is the owner's head with large basin area, double vanity doors and shower stall. Par Quietflush toilet. Full-length beveled edge mirror on cabin door.

ENTERTAINMENT EQUIPMENT

MAIN SALOON:

- 32" Samsung TV with electric lift system
- Alpine DVD /CD/FM stereo with (5) Gallo speakers

OWNERS CABIN:

- 26" Samsung TV
- Alpine DVD/CD/FM stereo with speakers and iPod interface near berth

COCKPIT:

- Waterproof speaker in cockpit

DECK EQUIPMENT

ANCHORING:

- Lewmar heavy duty hydraulic windlass
- 74 lb. stainless steel CQR main anchor with 325' stainless steel chain
- Spade 55 lb. collapsible kedge anchor with 328' x 18 mm Octoplait nylon warp and 32' x 12 mm chain tail

HATCHES and PORTS:

- Solimar flush-mount deck hatches
- Gebo alloy-framed portlights in coaming
- Gebo opening hullports
- Deck saloon opening windows with gas struts

WINCHES (all Lewmar self-tailing):

- (2) 77 CEST 2-speed electric primaries
- (2) 58 CST 2-speed secondaries
- 58 CEST 2-speed electric mainsheet
- 58 CST 2-speed electric mainsail halyard
- 58 CST 2-speed manual genoa and staysail halyard fitted on mast

DAVITS:

- Cooney S300 electric davits with belly bands

CANVAS:

- Spray hood
- Bimini
- Covers for cockpit table and pedestals

DECK EQUIPMENT – GENERAL:

- Cockpit table – gloss-varnished teak with Frigomatic refrigerated cool box and extra folding extension leaves at fwd. & aft ends
- Cockpit and foredeck cushions with closed-cell foam
- Hot and cold freshwater deck shower in transom locker
- Freshwater wash-down at bow and pedestal in cockpit
- Oyster custom drop-down washboard system

RIG and SAIL HANDLING

MAST AND RIGGING:

- Cutter rig
- Formula white painted aluminum mast with hydraulic in-mast furling (new paint 2019)
- Formula white painted aluminum boom (new paint 2019)
- Navtec backstay and vang adjuster with remote hydraulic control panel at pedestal
- (2) 'No strike' ion dissipaters at masthead
- Discontinuous stainless steel wire rigging
- Preventer lines fixed on boom

HEADSAIL FURLING:

- Reckmann hydraulic headsail furler
- Reckmann hydraulic staysail furler

- Dolphin Pentex cruise laminate mainsail & staysail
- Quantum Contender Pro Hybrid Yankee (new 2018)
- Dolphin asymmetric chute with sock and gear

MACHINERY

ENGINE:

- Volvo D4, 180 hp. (2,371 hrs. as of July, 2020)
- Twin Racor filters with change-over system and vacuum gauge

PROPELLER:

- Brunton Varifold prop
- Ambassador AM20 rope cutter on prop shaft

ROPE CUTTER:

Ambassador rope cutter

ALTERNATORS:

- Volvo 115A, 12 V alternator for starting/battery charging
- Second Mastervolt 150 A, 24 V high-output alternator for domestic battery charging

GENERATOR:

- Onan 21.5 kVA generator – 110V @ 60Hz (1,485 hrs. as of July, 2020)

THRUSTER:

- Sleipner SP240 tunnel bow thruster

HYDRAULICS:

- Lewmar Commander with twin motors and 4-function system for headsail and staysail furling, mainsail furling and outhaul

AIR CONDITIONING:

- (4) Reverse-cycle aircon units for cabins and main saloon

HEATING:

- Eberspacher Hydro 16 heater with outlets in each cabin

REFRIGERATION:

- Frigomatic galley refrigeration for fridge and freezer
- Frigomatic cockpit refrigeration

WATERMAKER:

- Seafresh 206A watermaker with Seafresh auto-flush system producing approx. 27 gallons/hour

TANKAGE AND PLUMBING

FUEL:

- (2) Fiberglass tanks, 449 gallons total
- Twin Racor filter system

WATER:

- (2) Fiberglass tanks, 317 gallons total
- Charcoal water filter

TANK TENDER GAUGES:

- Offshore tank system for monitoring tanks, plus dipsticks

HOT WATER:

- Insulated tank heated by AC 110 V or engine

HOLDING TANKS:

- (3) Gravity discharge polypropylene toilet holding tanks with Wema gauge and fittings for deck pump-out systems

ELECTRICAL SYSTEM

SHIP'S DC SUPPLY:

- 24 V

RINGMAIN:

- 220 V with 110 V AC ring main with outlets throughout the interior

BATTERIES:

- Domestic: Rolls Surrette 820 AHr
- Engine start
- Generator start

BATTERY MANAGEMENT:

- (2) Mastervolt MASS 24/100 Amp chargers, including temperature sensors
- Mastervolt battery monitor

INVERTER:

- Mastervolt 110 V MASS Sine Inverter 24/2100 W for powering domestic sockets,

microwave and PC

SHORE POWER:

- 50 A dockside power cable with Marinetek ends. Marinetek socket in transom
- Isolation transformer

INTERIOR LIGHTING:

- Recessed overhead lights with dimmer switch in polished chrome finish
- Reading lights at berths
- LED ribbon lighting in saloon floor area and galley and saloon recesses
- Red “courtesy” footlights
- Red overhead night lights at galley and navigation table

EXTERIOR LIGHTING:

- LED boom light over cockpit table, additional light at end of boom
- Spreader lights – (1) pair down and (3) pair up. Separately switched at pedestal
- Tri-white anchor/navigation light at masthead
- Steaming and deck light on mast
- Low-level deck lighting in cockpit and aft walkway, switched at pedestal
- Transom courtesy light
- (2) Underwater lights at transom

NAVIGATION and COMMUNICATION EQUIPMENT

COMPASS:

- SIRS Marine Major 150 mm diameter compass mounted at each helm

INSTRUMENTS:

Companionway Console

- (3) Raymarine sailing instruments: Speed, Wind, Depth

Port Pedestal

- i70 Multi display
- Raymarine autopilot control head
- Bow thruster control
- Raymarine Axiom 12" radar/GPS/plotter/Sirius weather (new 2019)

Starboard Pedestal

- i70 Multi display
- Raymarine Axiom 12" radar/GPS/plotter/Sirius weather (new 2019)
- Alpine stereo control head

Chart Table

- i70 Multi display
- Raymarine Axiom 12" radar/GPS/plotter/Sirius weather (new 2019)

Radar:

- Raymarine Quantum II dome

GPS:

- Raymarine ST60 Plus

AIS:

- Sitex

AUTOPILOT:

- Raymarine ST6002 autopilot control with Whitlock Mamba drive and Evolution EV1 self-learning course computer

WINDEX:

- At masthead

VHF RADIO:

Simrad VHF with second handset in cockpit

SSB RADIO:

- ICOM 802 SSB radio including DSC antenna
- Wide copper strip and ground plates
- Backstay insulator as aerial for SSB

PC:

- Windows XP PC with printer at navigation station

SAFETY EQUIPMENT

LIFE RAFT:

- Ocean Safety, 8-person

RADAR REFLECTOR:

- Echomax 230 at masthead

BILGE PUMPS:

- Par electric bilge pump with Par hydro air switch
- Henderson Mk V manual bilge pump

DECK SAFETY:

- Webbing jackstays with Wichard padeyes, forward bolted through deck
- Emergency tiller stowed in lazarette locker

FIRE EXTINGUISHERS:

- Various, including automatic fire extinguisher in engine bay

ADDITIONAL EQUIPMENT

- AB 11' aluminum-hull RIB
- Honda 20 hp 4-stroke outboard
- Warps and fenders
- Spares and manuals

EXCLUSIONS

- All personal belongings and all other items not expressly listed in the above inventory are excluded from the sale.
- Chelsea clocks

Exclusions

Owner's personal belongings.

Disclaimer

The Company offers the details of this vessel or yacht in good faith but cannot guarantee or warrant the accuracy of this information nor warrant the condition of the vessel. A buyer should instruct his representatives, agents, or his surveyors, to investigate such details as the buyer desires validated. This vessel or yacht is offered subject to prior sale, price change, or withdrawal without notice.

PHOTOS

Sailing



Sailing



Sailing



Saloon Port Settee, Looking Fwd.



Port Settee



Saloon, Stbd



Hull Port Windows



Saloon Aft



Nav Station



Owner's Cabin



Owner's Cabin Settee



Owner's Cabin Fwd.



Owner's Head



Stbd. Guest Cabin



Stbd. Guest Head Shower



Galley



Freezer



Refrigerator



Washer/Dryer



Easy Access to Plumbing



At Sea



Windlass and Furlers



Foredeck



Window Profile



Cockpit, Fwd.



Cockpit



Cockpit



Twin Wheels



Cockpit



Port Helm



Stbd. Helm



Folding Cleats



Mainsheet



Hydraulic Furler



Engine



At Sea



BANDIDO Interior Layout

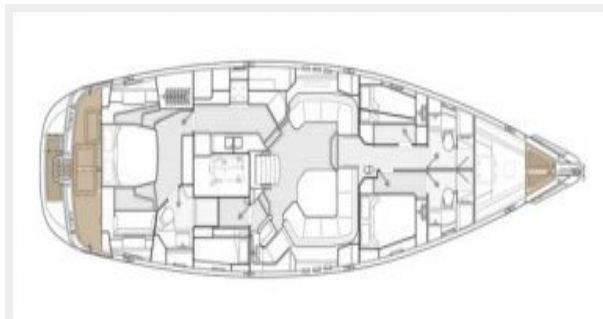

CONTACTS

Andrey Shestakov, leading yacht broker of the sales department of Shestakov Yacht Sales Inc. Shestakov Yacht Sales Inc., the official representative of the Miami/Fort Lauderdale FL headquarters.

Contact details

Email: andrey@shestakovyachtsales.com

Web: shestakovyachtsales.com/en/

Telephones

USA: +1(954)274-4435

Office hours

Monday – Saturday: **9:00 - 21:00** EDT

Sunday: **closed**

Address



Harbour Towne Marina, 850 NE 3rd St,
STE 213, Dania, FL 33004