

50M PRIME MEGAYACHT PLATFORM CALO



Year Built: 2021

Model: Motor Yacht

Price: PRICE ON APPLICATION

LOA: 162' (49.38mm)

Beam: 28.75

Max Draft: 7' 1" (2.16mm)

Cruise Speed: 13 Knots Kts. (15 MPH)

Max Speed: 16 Knots Kts. (18 MPH)

Our experienced yacht broker, Andrey Shestakov, will help you choose and buy a yacht that best suits your needs **50m PRIME Megayacht Platform Calou** — n/a from our catalogue. Presently, at **Shestakov Yacht Sales Inc.**, we have a wide variety of yachts available on our sale's list. We also work in close contact with all the big yacht manufacturers from all over the world.

If you would like to buy a yacht **50m PRIME Megayacht Platform Calou** — n/a or would like help answering any questions concerning purchasing, selling or chartering a yacht, please call **+1(954)274-4435**

TABLE OF CONTENTS

TABLE OF CONTENTS	2
SPECIFICATIONS	3
Overview	3
Basic Information	3
Dimensions	3
Speed, Capacities and Weight	3
Accommodations	4
Hull and Deck Information	4
Engine Information	4
PHOTOS	5
CONTACTS	7
Contact details	7
Telephones	7
Office hours	7
Address	7

SPECIFICATIONS

Overview

The PRIME Megayacht Platform

The Future of Semi-Custom has arrived

At PRIME, our belief is that those who invest time and energy into building a megayacht should be rewarded with a creation which represents his or her distinctive style. Much like a custom home builder, PRIME offers you the sophistication of a custom build with the time- and cost-savings benefits of a semi-production series. Choose from The Collection (CALOU, DREAM, NEXT, PRISMA) or take advantage of PRIME's flexibility to create your own masterpiece. Create with Confidence, while benefitting from a thoroughly engineered platform designed by an elite team of naval architects, master builders and interior designers.

Basic Information

Category: Motor Yacht	Sub Category: Mega Yacht
Model Year: 2023	Year Built: 2021

Dimensions

LOA: 162' (49.38mm)	Beam: 28.75
Max Draft: 7' 1" (2.16mm)	

Speed, Capacities and Weight

Cruise Speed: 13 Knots Kts. (15 MPH)	Max Speed: 16 Knots Kts. (18 MPH)
Gross Tonnage: 499 Pounds	Water Capacity: 12000 Gallons
Fuel Capacity: 13208.6 Gal Gallons	

Accommodations

Total Cabins: 5	Sleeps: 10
Total Heads: 5	Crew Cabin: 10

Hull and Deck Information

Hull Material: Aluminum	Hull Designer: Azure Yacht Design
Exterior Designer: Reymond Langton	

Engine Information

Engines: 2	Manufacturer: MTU
Engine Type: Inboard	Fuel Type: Diesel

PHOTOS

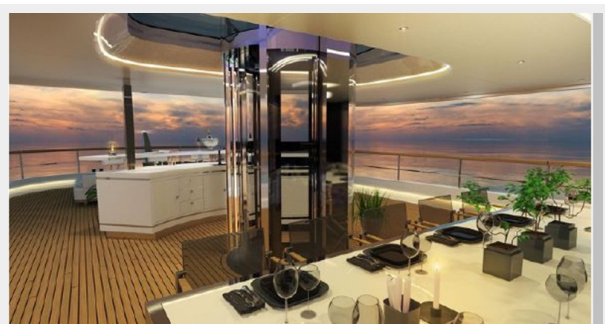
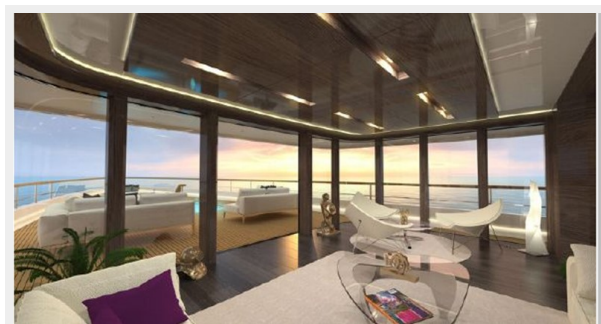
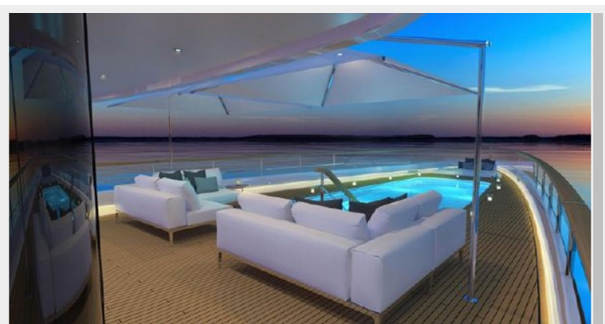
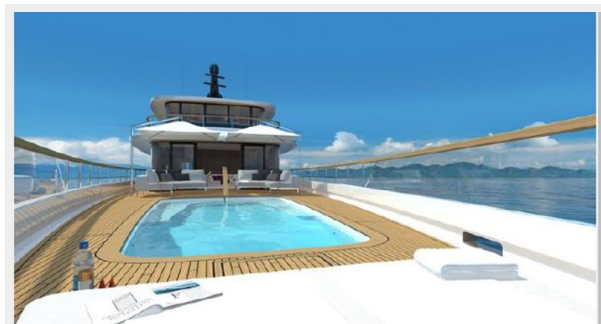

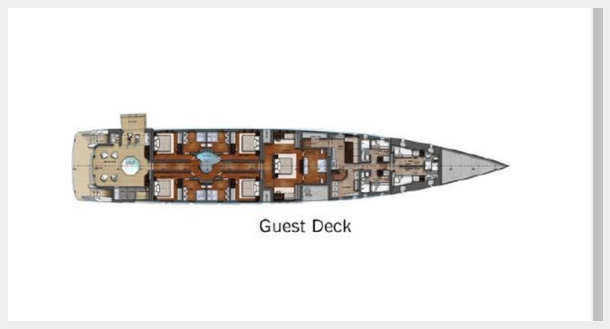
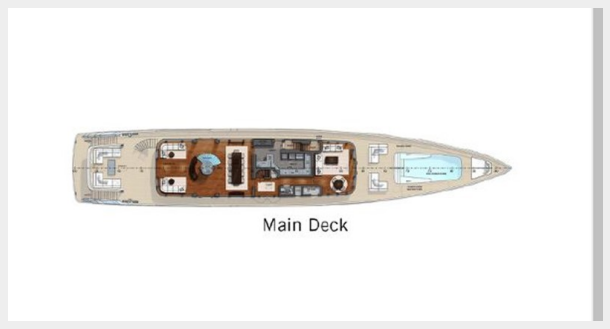

CONTACTS

Andrey Shestakov, leading yacht broker of the sales department of Shestakov Yacht Sales Inc. Shestakov Yacht Sales Inc., the official representative of the Miami/Fort Lauderdale FL headquarters.

Contact details

Email: **andrey@shestakovyachtsales.com**

Web: shestakovyachtsales.com/en/

Telephones

USA: **+1(954)274-4435**

Office hours

Monday – Saturday: **9:00 - 21:00 EDT**

Sunday: **closed**

Address



Harbour Towne Marina, 850 NE 3rd St,
STE 213, Dania, FL 33004