

MAXIMUS — CUSTOM



Builder: CUSTOM

Year Built: 2029

Model: Displacement

Price: PRICE ON APPLICATION

Location: Spain

LOA: 525' (160mm)

Beam: 72.17

Min Draft: 17' 9" (5.4mm)

Cruise Speed: 12 Knots Kts. (14 MPH)

Max Speed: 19 Knots Kts. (22 MPH)

Our experienced yacht broker, Andrey Shestakov, will help you choose and buy a yacht that best suits your needs **MAXIMUS — CUSTOM** from our catalogue. Presently, at Shestakov Yacht Sales Inc., we have a wide variety of yachts available on our sale's list. We also work in close contact with all the big yacht manufacturers from all over the world.

If you would like to buy a yacht **MAXIMUS — CUSTOM** or would like help answering any questions concerning purchasing, selling or chartering a yacht, please call **+1(954)274-4435**

TABLE OF CONTENTS

TABLE OF CONTENTS	2
SPECIFICATIONS	3
Overview	3
Basic Information	3
Dimensions	3
Speed, Capacities and Weight	3
Accommodations	4
Hull and Deck Information	4
Engine Information	4
PHOTOS	5
MAXIMUS with Helicopter	5
MAXIMUS_alfresco dining	5
MAXIMUS_beachclub	5
MAXIMUS_casino	5
MAXIMUS_cocktail lounge	5
MAXIMUS_guest lounge 01	5
MAXIMUS_guest lounge 02	6
MAXIMUS_guest	6
MAXIMUS_outdoor lounge 01	6
MAXIMUS_outdoor lounge 02	6
MAXIMUS_outdoor lounge 03	6
MAXIMUS_VIP	6
CONTACTS	7
Contact details	7
Telephones	7
Office hours	7
Address	7

SPECIFICATIONS

Overview

The MAXIMUS, designed by Gill Schmid Designs from New York, was originally developed in conjunction with Astilleros Hijos de Barreras in Vigo, northern Spain, best known for constructing the MV Ritz Carlton cruise ship,. It is worth noting that this project may be eligible for the Spanish Tax Relief system, specifically designed for new construction projects of a commercial nature. This could potentially result in a significant discount of up to 20 percent on overall build costs.

Basic Information

Category: Displacement

Sub Category: Displacement

Model Year: 2028

Year Built: 2029

Country: Spain

Dimensions

LOA: 525' (160mm)

Beam: 72.17

Min Draft: 17' 9" (5.4mm)

Speed, Capacities and Weight

Cruise Speed: 12 Knots Kts. (14 MPH)

Cruise Speed Range: 12500

Max Speed: 19 Knots Kts. (22 MPH)

Max Speed Range: 7125 Kts.

Gross Tonnage: 13500 Pounds

Water Capacity: 100000 Gallons

Holding Tank: 22454.62 Gal Gallons

Fuel Capacity: 264172.05 Gal Gallons

Accommodations

Total Cabins: 24

Total Berths: 48

Sleeps: 48

Total Heads: 30

Crew Cabin: 64

Crew Heads: 32

Hull and Deck Information

Hull Material: Steel

Deck Material: Teak over Aluminum

Hull Configuration: Displacement w/
Bulbous Bow

Exterior Designer: Gill Schmid Design

Engine Information

Engines: 2

Manufacturer: ABB

Engine Type: Inboard

Fuel Type: Diesel/Electric

PHOTOS

MAXIMUS with Helicopter



MAXIMUS_alfresco dining



MAXIMUS_beachclub



MAXIMUS_casino



MAXIMUS_cocktail lounge



MAXIMUS_guest lounge 01



MAXIMUS_guest lounge 02



MAXIMUS_guest



MAXIMUS_outdoor lounge 01



MAXIMUS_outdoor lounge 02



MAXIMUS_outdoor lounge 03

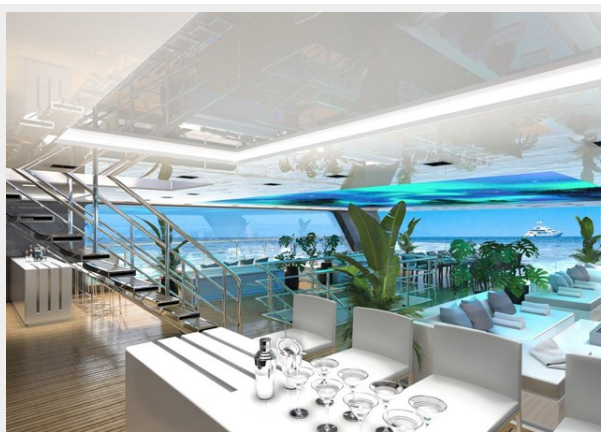

MAXIMUS_VIP



CONTACTS

Andrey Shestakov, leading yacht broker of the sales department of Shestakov Yacht Sales Inc. Shestakov Yacht Sales Inc., the official representative of the Miami/Fort Lauderdale FL headquarters.

Contact details

Email: andrey@shestakovyachtsales.com

Web: shestakovyachtsales.com/en/

Telephones

USA: +1(954)274-4435

Office hours

Monday – Saturday: **9:00 - 21:00** EDT

Sunday: **closed**

Address



Harbour Towne Marina, 850 NE 3rd St,
STE 213, Dania, FL 33004