

## OHANA — TIARA



**Builder:** TIARA

**Year Built:** 2003

**Model:** cruiser

**Price:** PRICE ON APPLICATION

**Location:** United States

**LOA:** 40' (12.19mm)

**Beam:** 14.5

**Max Draft:** 4' (1.22mm)

Our experienced yacht broker, Andrey Shestakov, will help you choose and buy a yacht that best suits your needs **Ohana — TIARA** from our catalogue. Presently, at **Shestakov Yacht Sales Inc.**, we have a wide variety of yachts available on our **sale's list**. We also work in close contact with all the big **yacht manufacturers** from all over the world.

If you would like to buy a yacht **Ohana — TIARA** or would like help answering any questions concerning purchasing, selling or chartering a yacht, please call **+1(954)274-4435**

# TABLE OF CONTENTS

TABLE OF CONTENTS	2
SPECIFICATIONS	6
Overview	6
Basic Information	6
Dimensions	6
Speed, Capacities and Weight	6
Accommodations	6
Hull and Deck Information	7
Engine Information	7
PHOTOS	8
8590362_20230608105355888_1_XLARGE	8
112377_0_070320091744_9	8
8590362_20230608105421118_1_XLARGE	8
8590362_20230608105426197_1_XLARGE	8
8590362_20230608105440455_1_XLARGE	8
8590362_20230608105449022_1_XLARGE	8
8590362_20230608105416524_1_XLARGE	9
8590362_20230608105411473_1_XLARGE	9
8590362_20230608105519575_1_XLARGE	9
8590362_20230608105509908_1_XLARGE	9
8590362_20230608105513864_1_XLARGE	9
8590362_20230608120855559_1_XLARGE	9
8590362_20230608120900541_1_XLARGE	10
8590362_20230608120905343_1_XLARGE	10
8590362_20230608120910574_1_XLARGE	10
8590362_20230608120915669_1_XLARGE	10
8590362_20230608120920614_1_XLARGE	10
8590362_20230608120816878_1_XLARGE	10

---

8590362_20230608120819848_1_XLARGE	11
8590362_20230608120823694_1_XLARGE	11
8590362_20230608120844207_1_XLARGE	11
8590362_20230608120847268_1_XLARGE	11
8590362_20230608120850260_1_XLARGE	11
8590362_20230608120926005_1_XLARGE	11
8590362_20230608120931801_1_XLARGE	12
8590362_20230608120942207_1_XLARGE	12
8590362_20230608120936992_1_XLARGE	12
8590362_20230608120946889_1_XLARGE	12
8590362_20221109095033616_1_XLARGE	12
8590362_20221109095036665_1_XLARGE	12
8590362_20221109095038714_1_XLARGE	13
8590362_20221109095042751_1_XLARGE	13
8590362_20221109095101496_1_XLARGE	13
8590362_20221109095105046_1_XLARGE	13
8590362_20221109095054919_1_XLARGE	13
8590362_20221109095050994_1_XLARGE	13
8590362_20221109095048857_1_XLARGE	14
8590362_20221109095108177_1_XLARGE	14
8590362_20221109095115473_1_XLARGE	14
8590362_20221109095112175_1_XLARGE	14
8590362_20221109095119264_1_XLARGE	14
8590362_20221109095122261_1_XLARGE	14
8590362_20221109095126332_1_XLARGE	15
8590362_20221109095129355_1_XLARGE	15
8590362_20221109095133410_1_XLARGE	15
8590362_20221109095136435_1_XLARGE	15
8590362_20221109095141397_1_XLARGE	15

---

---

8590362_20221109095149603_1_XLARGE	15
8590362_20221109095145557_1_XLARGE	16
8590362_20221109095159718_1_XLARGE	16
8590362_20221109095202868_1_XLARGE	16
8590362_20230608121019148_1_XLARGE	16
8590362_20230608121024994_1_XLARGE	16
8590362_20230608121031638_1_XLARGE	16
8590362_20230608121037499_1_XLARGE	17
8590362_20230608121126703_1_XLARGE	17
8590362_20230608121054736_1_XLARGE	17
8590362_20230608121105140_1_XLARGE	17
8590362_20230608121136912_1_XLARGE	17
8590362_20230608121111476_1_XLARGE	17
8590362_20230608121059547_1_XLARGE	18
8590362_20230608121116677_1_XLARGE	18
8590362_20230608121042972_1_XLARGE	18
8590362_20221109095156571_1_XLARGE	18
8590362_20230608121141935_1_XLARGE	18
8590362_20230608121156260_1_XLARGE	18
8590362_20230414104621791_1_XLARGE	19
8590362_20221109094925712_1_XLARGE	19
8590362_20230414104610314_1_XLARGE	19
8590362_20230414104504603_1_XLARGE	19
8590362_20230608105454670_1_XLARGE	19
8590362_20230414104515320_1_XLARGE	19
CONTACTS	20
Contact details	20
Telephones	20
Office hours	20

---

---

Address

20

---

---

# SPECIFICATIONS

---

## Overview

---

Roomy Express Cruiser powered by Twin 480HP Cummins diesels with 1320hours, Onan Generator with sound shield and under 1100hours. Full Raymarine electronics suite with GPS/Chart/Radar/Fish finder/Auto Pilot and Dual 12in Hybrid touch Displays. This vessel has ample room for entertain, dual bench seating in the cockpit and huge convertible dinette in the salon. Large Swim platform with Trunk storage for Bikes/Water Toys/Dive Equipment.

## Basic Information

---

**Category:** cruiser

**Sub Category:** Express

**Model Year:** 2003

**Year Built:** 2003

**Country:** United States

## Dimensions

---

**LOA:** 40' (12.19mm)

**Beam:** 14.5

**Max Draft:** 4' (1.22mm)

## Speed, Capacities and Weight

---

**Water Capacity:** 160 Gallons

**Holding Tank:** 57 Gal Gallons

**Fuel Capacity:** 444 Gal Gallons

## Accommodations

---

**Total Cabins:** 1

---

## Hull and Deck Information

---

**Hull Material:** Fiberglass

## Engine Information

---

**Engines:** 2

**Manufacturer:** Cummins

**Engine Type:** Inboard

**Fuel Type:** Diesel

# PHOTOS

8590362\_20230608105355888\_1\_XLARGE

112377\_0\_070320091744\_9

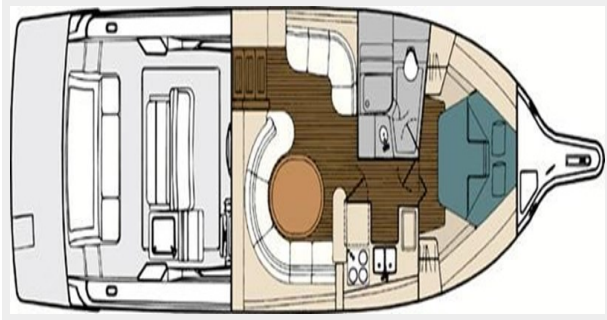

8590362\_20230608105421118\_1\_XLARGE

8590362\_20230608105426197\_1\_XLARGE



8590362\_20230608105440455\_1\_XLARGE

8590362\_20230608105449022\_1\_XLARGE





8590362\_20230608105416524\_1\_XLARGE



8590362\_20230608105411473\_1\_XLARGE



8590362\_20230608105519575\_1\_XLARGE



8590362\_20230608105509908\_1\_XLARGE



8590362\_20230608105513864\_1\_XLARGE



8590362\_20230608120855559\_1\_XLARGE



8590362\_20230608120900541\_1\_XLARGE



8590362\_20230608120905343\_1\_XLARGE



8590362\_20230608120910574\_1\_XLARGE



8590362\_20230608120915669\_1\_XLARGE



8590362\_20230608120920614\_1\_XLARGE



8590362\_20230608120816878\_1\_XLARGE





8590362\_20230608120819848\_1\_XLARGE



8590362\_20230608120823694\_1\_XLARGE



8590362\_20230608120844207\_1\_XLARGE



8590362\_20230608120847268\_1\_XLARGE



8590362\_20230608120850260\_1\_XLARGE



8590362\_20230608120926005\_1\_XLARGE



8590362\_20230608120931801\_1\_XLARGE



8590362\_20230608120942207\_1\_XLARGE



8590362\_20230608120936992\_1\_XLARGE



8590362\_20230608120946889\_1\_XLARGE



8590362\_20221109095033616\_1\_XLARGE



8590362\_20221109095036665\_1\_XLARGE





8590362\_20221109095038714\_1\_XLARGE



8590362\_20221109095042751\_1\_XLARGE



8590362\_20221109095101496\_1\_XLARGE



8590362\_20221109095105046\_1\_XLARGE



8590362\_20221109095054919\_1\_XLARGE



8590362\_20221109095050994\_1\_XLARGE



8590362\_20221109095048857\_1\_XLARGE



8590362\_20221109095108177\_1\_XLARGE



8590362\_20221109095115473\_1\_XLARGE



8590362\_20221109095112175\_1\_XLARGE



8590362\_20221109095119264\_1\_XLARGE



8590362\_20221109095122261\_1\_XLARGE





8590362\_20221109095126332\_1\_XLARGE



8590362\_20221109095129355\_1\_XLARGE



8590362\_20221109095133410\_1\_XLARGE

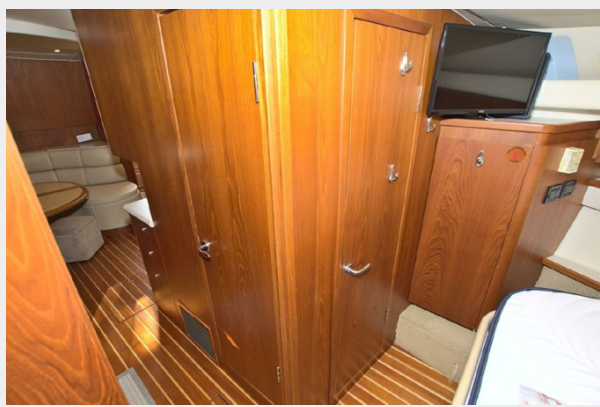

8590362\_20221109095136435\_1\_XLARGE



8590362\_20221109095141397\_1\_XLARGE

8590362\_20221109095149603\_1\_XLARGE



8590362\_20221109095145557\_1\_XLARGE



8590362\_20221109095159718\_1\_XLARGE



8590362\_20221109095202868\_1\_XLARGE



8590362\_20230608121019148\_1\_XLARGE



8590362\_20230608121024994\_1\_XLARGE



8590362\_20230608121031638\_1\_XLARGE





8590362\_20230608121037499\_1\_XLARGE



8590362\_20230608121126703\_1\_XLARGE



8590362\_20230608121054736\_1\_XLARGE



8590362\_20230608121105140\_1\_XLARGE



8590362\_20230608121136912\_1\_XLARGE



8590362\_2023060812111476\_1\_XLARGE





8590362\_20230608121059547\_1\_XLARGE



8590362\_20230608121116677\_1\_XLARGE



8590362\_20230608121042972\_1\_XLARGE



8590362\_20221109095156571\_1\_XLARGE



8590362\_20230608121141935\_1\_XLARGE



8590362\_20230608121156260\_1\_XLARGE





8590362\_20230414104621791\_1\_XLARGE



8590362\_20221109094925712\_1\_XLARGE



8590362\_20230414104504603\_1\_XLARGE



8590362\_20230414104610314\_1\_XLARGE



8590362\_20230414104515320\_1\_XLARGE



8590362\_20230608105454670\_1\_XLARGE



# CONTACTS

---

Andrey Shestakov, leading yacht broker of the sales department of Shestakov Yacht Sales Inc. Shestakov Yacht Sales Inc., the official representative of the Miami/Fort Lauderdale FL headquarters.

## Contact details

---

Email: [andrey@shestakovyachtsales.com](mailto:andrey@shestakovyachtsales.com)

Web: [shestakovyachtsales.com/en/](http://shestakovyachtsales.com/en/)

## Telephones

---

USA: +1(954)274-4435

## Office hours

---

Monday – Saturday: **9:00 - 21:00** EDT

Sunday: **closed**

## Address

---



Harbour Towne Marina, 850 NE 3rd St,  
STE 213, Dania, FL 33004