

## 2024 MCCONAGHY 82P — MC CONAGHY



**Builder:** MC CONAGHY

**Year Built:** 2024

**Model:** Cruiser

**Price:** Price on Application

**Location:** United States

**LOA:** 81' 5" (24.82mm)

**Beam:** 37.07

**Min Draft:** 5' 5" (1.65mm)

**Max Draft:** 14' 2" (4.3mm)

**Cruise Speed:** 14 Knots Kts. (16 MPH)

**Max Speed:** 20 Knots Kts. (23 MPH)

Our experienced yacht broker, Andrey Shestakov, will help you choose and buy a yacht that best suits your needs 2024 McConaghy 82P — MC CONAGHY from our catalogue. Presently, at Shestakov Yacht Sales Inc., we have a wide variety of yachts available on our sale's list. We also work in close contact with all the big yacht manufacturers from all over the world.

If you would like to buy a yacht 2024 McConaghy 82P — MC CONAGHY or would like help answering any questions concerning purchasing, selling or chartering a yacht, please call **+1(954)274-4435**

---

# TABLE OF CONTENTS

---

TABLE OF CONTENTS	2
SPECIFICATIONS	3
Overview	3
Basic Information	4
Dimensions	4
Speed, Capacities and Weight	4
Accommodations	4
Hull and Deck Information	5
Engine Information	5
PHOTOS	6
2	6
3	6
5	6
4	6
7	6
6	6
CONTACTS	7
Contact details	7
Telephones	7
Office hours	7
Address	7

---

# SPECIFICATIONS

---

## Overview

---

### 2024 McConaghy 82P

Best In Class Power Catamaran/Long Range Cruiser or Yacht Charter!

The yacht's internal volume has been maximised and every space configured with distinct purpose in a layout that dispels all preconceptions of yacht interiors. The MC82p features a huge saloon lounge with a dining area and open plan galley on the main deck, a spacious aft deck with sofas and al fresco dining space, and a cosy exterior lounge forward of the superstructure. On the flybridge there is another informal dining area and freestanding lounge furniture, with sun loungers positioned aft to make the most of the elevated and uninterrupted views. The flybridge itself is sheltered by a fixed bimini with a retractable centre 'sun roof' panel. The accommodation arrangement allows for four seaward-facing double cabins, three of which can be converted to twin berths, and there are two additional cabins for crew. The MC82p is driven from the flybridge. Equipped with twin 250hp Yanmar engines, the yacht will reach a top speed of 17 knots and cruise at 10 knots, with the efficient hull form and lightweight construction reducing fuel burn by 30 to 50% compared to a motor yacht of the same length. The MC82p carries a 5.7m tender on a hydraulic aft platform, which, with the tender deployed, creates a spacious swim platform or provides additional deck space. Additional production options include solar power generation, synthetic teak decking, various hull colours, underwater lights and an impressive integrated audiovisual package. The general arrangement of any McConaghy Multihull can be configured to specifically suit each client's requirements. Some clients like to have a master suite on the main deck, while others request fewer but larger guest suites and some place greater emphasis on crew accommodation and layout versatility. At McConaghy, we pride ourselves on being able to meet any client request – this is production boat building with full-custom possibility.

Engel & Voelkers Yachting is the North American Dealer. See all models on our site at [evyachting.com](http://evyachting.com). 239-404-9329

---

## Basic Information

---

**Category:** Cruiser

**Sub Category:** Cruiser

**Model Year:** 2024

**Year Built:** 2024

**Country:** United States

---

## Dimensions

---

**LOA:** 81' 5" (24.82mm)

**Beam:** 37.07

**Min Draft:** 5' 5" (1.65mm)

**Max Draft:** 14' 2" (4.3mm)

---

## Speed, Capacities and Weight

---

**Cruise Speed:** 14 Knots Kts. (16 MPH)

**Cruise Speed Range:** 2000

**Max Speed:** 20 Knots Kts. (23 MPH)

**Max Speed Range:** 1500 Kts.

**Gross Tonnage:** 72 Pounds

**Water Capacity:** 396.258 Gallons

**Holding Tank:** 211.34 Gal Gallons

**Fuel Capacity:** 1590 Gal Gallons

---

## Accommodations

---

**Total Cabins:** 4

**Total Berths:** 8

**Sleeps:** 8

**Total Heads:** 4

**Crew Cabin:** 2

**Crew Berths:** 2

**Crew Heads:** 1

---

## Hull and Deck Information

---

**Hull Material:** Carbon Fiber

**Deck Material:** Teak

**Hull Configuration:** Catamaran

**Hull Designer:** Morelli & Melvin

**Interior Designer:** Autotroph

---

## Engine Information

---

**Engines:** 2

**Manufacturer:** Volvo Penta

**Fuel Type:** Diesel

# PHOTOS

2



3



4



5



6



7

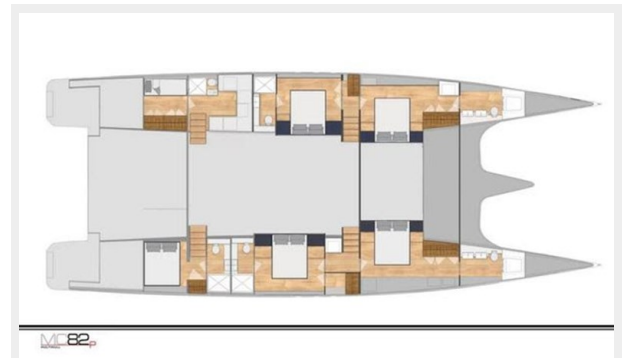

# CONTACTS

---

Andrey Shestakov, leading yacht broker of the sales department of Shestakov Yacht Sales Inc. Shestakov Yacht Sales Inc., the official representative of the Miami/Fort Lauderdale FL headquarters.

## Contact details

---

Email: [andrey@shestakovyachtsales.com](mailto:andrey@shestakovyachtsales.com)

Web: [shestakovyachtsales.com/en/](http://shestakovyachtsales.com/en/)

## Telephones

---

USA: +1(954)274-4435

## Office hours

---

Monday – Saturday: **9:00 - 21:00** EDT

Sunday: **closed**

## Address

---



Harbour Towne Marina, 850 NE 3rd St,  
STE 213, Dania, FL 33004