

2024 SELENE 40 KIWI SEDAN — SELENE YACHTS



Builder: SELENE YACHTS

Year Built: 2024

Model: trawler

Price: Price on Application

Location: New Zealand

LOA: 42' (12.8mm)

Beam: 14.5

Max Draft: 4' 6" (1.37mm)

Cruise Speed: 9 Knots Kts. (10 MPH)

Max Speed: 11 Knots Kts. (13 MPH)

Our experienced yacht broker, Andrey Shestakov, will help you choose and buy a yacht that best suits your needs **2024 Selene 40 Kiwi Sedan — SELENE YACHTS** from **our catalogue**. Presently, at **Shestakov Yacht Sales Inc.**, we have a wide variety of yachts available on **our sale's list**. We also work in close contact with all the big **yacht manufacturers** from all over the world.

If you would like to buy a yacht **2024 Selene 40 Kiwi Sedan — SELENE YACHTS** or would like help answering any questions concerning purchasing, selling or chartering a yacht, please call **+1(954)274-4435**

TABLE OF CONTENTS

TABLE OF CONTENTS	2
SPECIFICATIONS	3
Overview	3
Basic Information	3
Dimensions	3
Speed, Capacities and Weight	3
Hull and Deck Information	3
Engine Information	4
PHOTOS	5
CONTACTS	7
Contact details	7
Telephones	7
Office hours	7
Address	7

SPECIFICATIONS

Overview

This is the latest generation displacement cruiser from the Selene drawing board. It is a sedan version of the popular 42 Flybridge model with similar specifications to the standard 42' minus the flybridge. The class, style, and craftsmanship that make Selene a world leader in this category are now available in a family sedan model, and the price quoted is ex-factory. The images are a representation only. The interior photos are representative of the Selene 42 Euro-deck, which has precisely the same interior dimensions as the Selene Kiwi Sedan.

Basic Information

Category: trawler

Model Year: 2024

Year Built: 2024

Country: New Zealand

Dimensions

LOA: 42' (12.8mm)

Beam: 14.5

Max Draft: 4' 6" (1.37mm)

Speed, Capacities and Weight

Cruise Speed: 9 Knots Kts. (10 MPH)

Max Speed: 11 Knots Kts. (13 MPH)

Water Capacity: 200 Gallons

Holding Tank: 80 Gal Gallons

Fuel Capacity: 600 Gal Gallons

Hull and Deck Information

Hull Material: Fiberglass

Hull Designer: Howard Chen

Engine Information

Engines: 1

Manufacturer: Cummins

Engine Type: Inboard

Fuel Type: Diesel

PHOTOS



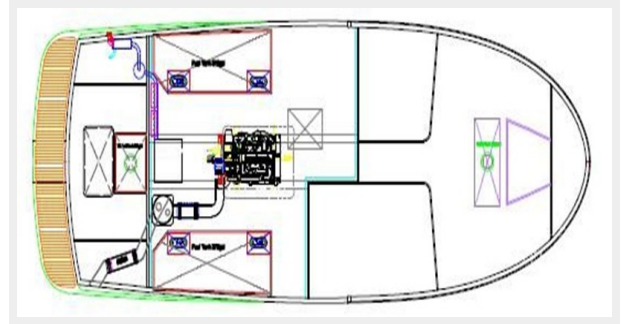
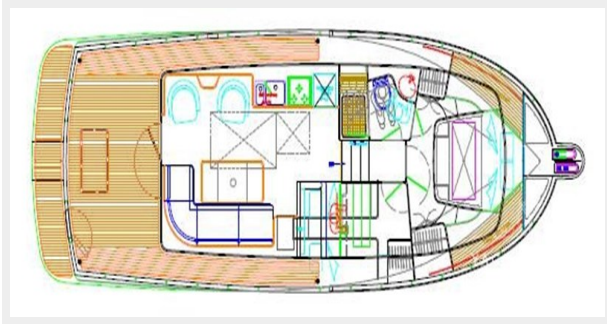
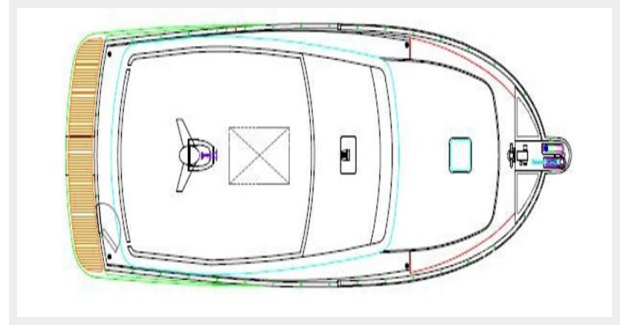

CONTACTS

Andrey Shestakov, leading yacht broker of the sales department of Shestakov Yacht Sales Inc. Shestakov Yacht Sales Inc., the official representative of the Miami/Fort Lauderdale FL headquarters.

Contact details

Email: **andrey@shestakovyachtsales.com**

Web: shestakovyachtsales.com/en/

Telephones

USA: **+1(954)274-4435**

Office hours

Monday – Saturday: **9:00 - 21:00** EDT

Sunday: **closed**

Address



Harbour Towne Marina, 850 NE 3rd St, STE 213, Dania, FL 33004