

44' 2006 PDQ ANTARES — PDQ



Судостроитель: PDQ

Год постройки: 2006

Модель: Катамаран

Цена: **ЦЕНА ЯХТЫ ПО ЗАПРОСУ**

Местонахождение: United States

Длина общая: 44' 0" (13.41m)

Ширина: 21' 10" (6.63m)

Макс. осадка: 4' 0" (1.22m)

Купить 44' 2006 PDQ Antares — PDQ а также выбрать подходящую вам яхту из нашего каталога яхт вам поможет опытный яхтенный брокер Андрей Шестаков. На сегодняшний день компания Shestakov Yacht Sales Inc. имеет большое количество яхт в собственном списке продаж, а также тесно сотрудничает со всеми крупными яхтенными производителями по всему миру.

Для того чтобы купить яхту 44' 2006 PDQ Antares — PDQ а также проконсультироваться по любому вопросу связанному с покупкой, продажей, чартером яхт позвоните по телефону **+7(918)465-66-44**.

ОГЛАВЛЕНИЕ

| | |
|--|----|
| ОГЛАВЛЕНИЕ | 2 |
| ХАРАКТЕРИСТИКИ | 6 |
| Основная информация | 6 |
| Размеры | 6 |
| Скорость, вместимость и масса | 6 |
| Корпус и палуба | 6 |
| Информация о двигателе | 6 |
| ПОДРОБНОЕ ОПИСАНИЕ | 7 |
| Features | 7 |
| Accommodations | 7 |
| Galley | 7 |
| Electronics and Navigational Equipment | 7 |
| Electrical System | 8 |
| Deck Equipment | 8 |
| Sails and Rigging | 8 |
| Options | 8 |
| Исключения | 9 |
| Отказ от ответственности | 9 |
| ФОТОГРАФИИ | 10 |
| Aft Starboard View | 10 |
| Aft Seating | 10 |
| Starboard View | 10 |
| Arch W Seating and Solar | 10 |
| Aft | 11 |
| Port View | 11 |
| Hulls | 11 |
| Deck | 11 |
| Deck | 11 |

| | |
|------------------------------|----|
| Skreetcher | 11 |
| Deck | 12 |
| Deck | 12 |
| Starboard Hardtop With solar | 12 |
| Port Hardtop W Solar | 12 |
| Mast | 12 |
| Track | 12 |
| Helm Seat | 13 |
| Helm | 13 |
| Helm Electrical Panel | 13 |
| Helm | 13 |
| Electric Helm Winch W Bags | 14 |
| Port Cockpit | 14 |
| Cockpit | 14 |
| Cockpit | 14 |
| Helm | 15 |
| Mast | 15 |
| Helm Cleats | 15 |
| Starboard Aft | 15 |
| Salon | 16 |
| Salon | 16 |
| Salon Desk | 16 |
| Salon | 16 |
| Galley | 17 |
| Galley | 17 |
| Galley | 17 |
| Fridge | 17 |
| Fridge | 18 |
| Freezer | 18 |

| | |
|------------------------|----|
| Galley | 18 |
| Port Forward Stateroom | 18 |
| Port Forward Head | 19 |
| Port Forward Stateroom | 19 |
| Port Aft Stateroom | 19 |
| Port Aft Stateroom | 19 |
| Master Head | 20 |
| Port Aft Stateroom | 20 |
| Master Head | 20 |
| Master Head | 20 |
| Starboard Hull | 21 |
| Starboard Hull | 21 |
| Master | 21 |
| Master | 21 |
| Master | 22 |
| Master | 22 |
| Starboard Hull | 22 |
| Master | 22 |
| Electrical Panel | 23 |
| Electrical Panel | 23 |
| Clean Wiring | 23 |
| Clean Starboard Bilge | 23 |
| Clean Starboard Engine | 24 |
| Clean Port Bilge | 24 |
| Clean Port Bilge | 24 |
| Clean Port Engine | 24 |
| Layout | 24 |
| Layout | 24 |
| Forward View | 25 |

| | |
|-----------------------|----|
| Starboard | 25 |
| Port | 25 |
| Sailing | 25 |
| КОНТАКТЫ | 26 |
| Контактная информация | 26 |
| Телефоны | 26 |
| Время работы | 26 |
| Адрес | 26 |

ХАРАКТЕРИСТИКИ

Основная информация

Тип судна: Катамаран

Модельный год: 2006

Год постройки: 2006

Страна: United States

Размеры

Длина общая: 44' 0" (13.41m)

Ширина: 21' 10" (6.63m)

Макс. осадка: 4' 0" (1.22m)

Трапы: 61' 0" (18.59m)

Скорость, вместимость и масса

Водоизмещение: 22500 Pounds

Вместимость воды: 50 Gallons

Вместимость сточного бака: 60 Gallons

Объем топливного бака: 120 Gallons

Корпус и палуба

Материал корпуса: Fiberglass

Информация о двигателе

Двигатели: 2

Производитель: Yanmar

Тип двигателя: Inboard

Тип топлива: Diesel

ПОДРОБНОЕ ОПИСАНИЕ

Features

This is a rare opportunity to own the best production catamaran available in the world. Why is PDQ the best available production catamaran? First, PDQ is said to be short for Pretty Dam Quick; she will sail at just about wind speed in light wind. Second, her bridge deck clearance is far superior to other manufacturers, giving her a smooth slap free ride in most sea conditions. Third, she has incredible headroom and yacht feel having an interior built with lightweight honeycomb that has a wood overlay. Finally, unlike most production catamarans, she has engines midship for stability with very reliable straight shafts driving her props (not in water saildrives). For sailing She is equipped with a Mainsail, Screecher, Jib, Genoa and Spinnaker, She has six solar panels for extended cruising, a diesel generator, Central Heat and A/C, Lots of Storage and over 50k in upgrades, see full specs for complete photo's and equipment. This is the best performance/cruising Cat available.

Accommodations

Sleeps six in Three Berths(all pre wired with cat-5 internet and cable TV). Two Heads. Full Galley, Large folding teak table in cockpit. Large Salon with built in Desk. Everything needed to be a comfortable liveaboard or cruising yacht.

Galley

3-BURNER GAS STOVE GAS OVEN TWIN REFRIDGERATOR/FREEZER SYSTEM
CONVECTION MICROWAVE STAINLESS STEEL BACKSPLASH FISHER PAYKEL
DISHWASHER STAINLESS SINK

Electronics and Navigational Equipment

RAYMARINE E SERIES 120 WITH 12" DISPLAY MOUNTED AT HELM RAYSTAR 125 WAAS
GPS SENSOR MOUNTED ON HARDTOP RAYMARINE ST6001 INBOARD AUTOPILOT
RAYMARINE ST60 TRIDATA SPEED/DEPTH/TEMP RAYMARINE ST60 WINDMETER
SYSTEM SEATALK HIGH SPEED CABLE (10 METERS) SEATALK HIGH SPEED
CROSSOVER COUPLER HORIZON QUEST VHF RADIO RAM MICROPHONE FOR VHF
RAYDOME 2KW MOUNTED ON MAST CLARION AM/FM/MP3/DVD/6 DISC CD WITH TWO
SALON SPEAKERS AND TWO COCKPIT SPEAKERS SUBWOOFER WITH AMPLIFIER
FLAT PANEL 20" TV MOUNTED IN MASTER SHAKESPEARE AM/FM VHF BAND
SEPARATOR ON VHF ANTENNA WIRED DIRECTED TO ENTERTAINMENT AREA

Electrical System

NORTHERN LIGHTS 6KW GENERATOR INCLUDING SOUND SHIELD PROSIGN INVERTER 2.0 AQ CRUISAIR AIR CONDITIONING (2X 6500 BTU, 1X 18000 BTU) 12 VOLT AND 110 VOLT OUTLETS IN EACH CABIN CABLE TV/PHONE INLET BY SHORE POWER CONNECTION SPENDID MODEL 2000 WASHER/DRYER ICEMAKER UNDER SINK IN WET BAR AREA TRASH COMPACTOR FOUR 50 WATT SOLAR PANELS RECESSED INTO HARDTOP WITH SMART REGULATORS TWO ADDITIONAL 80 WATT SOLAR PANELS MOUNTED ON TRANSOM ARCH PROSIGN INVERTER 2.0 LOCATED UNDER MAIN SETTEE WITH CONTROL PANEL IN NAV STATION TANK WATCH IV MONITORING SYSTEM IS INSTALLED ON BOTH HOLDING AND WATER TANKS THREE 12V DC TYPE 24 FLOODED CELL BATTERIES FOR ENGINES FOUR 6V DC 8116 FLOODED CELL HOUSE BATTERIES

Deck Equipment

TWO 20LB PROPANE TANKS IN AFT ROPE LOCKERS HARDTOP INCLUDES DODGER WITH LEXAN PANELS AND FULL ENCLOSURE RYDER QUICK 1000 ELECTRIC WINDLASS WITH DECK CONTROLS 50' X 10MM HIGH TEST CHAIN, 250' X 5/8" ANCHOR RODE SPADE 100 ANCHOR DOUBLE ANCHOR ROLLER AND CHAIN STOP STAINLESS STEEL ARCH WITH INTEGRATED BENCH/DAVIT SYSTEM TEAK COCKPIT TABLE MAGMA BBQ ON AFT BENCH

Sails and Rigging

HALYARDS AND REEFING LINES LED AFT TO THE COCKPIT FULLY BATTENED MAIN SELF TACKING JIB SPINNACKER SCREECHER RIG GENOA FURLEX FURLING SYSTEM HARKEN STEA48 POWERED SHEET WINCH AT HELM HARKEN STEA48 POWERED HALYARD WINCH MOUNTED ON AFT PEDESTAL SAIL AREAS: MAINSAIL 606 sq. ft. JIB 243 sq. ft. GENOA 472 sq. ft. SCREECHER 635 sq. ft.

Options

16" 3-BLADE FEATHERINE MAX PROPS 55AMP ALTERNATORS RAYCOR DUAL 75/500 MAXD FUEL FILTERS IN LINE WITH VACUUM GAGES ON TOP OF FILTER INTERPROTECT 2000 EPOXY BARRIER COAT BUG SCREENS INCLUDED FOR ALL OPENING HATCHES WORK BENCH IN STARBOARD FORWARD LOCKER FOUR 20" RAILSHANDRAILS AT LOWER TRANSOM BOOM MAINTAMER INCLUDING LIGHTS MAIN, AND JIB UPGRADED TO CXT TWO UNDERWATER LIGHTS BEHIND RUDDER COCKPIT AND SALON CUSHIONS UPGRADED TO IVORY ULTRALEATHER QUIETFLUSH ELECTRIC HEAD IN PORT FORWARD HEAD AND MASTER HEAD SKEGGED RUDDERS AND REFLECTIVE STRIPING 2 ADDITIONAL OVERHEAD HATCHES WITH OCEANAIR

BLINDS/SCREEN UPGRADED CORIAN TO PEMPEII RED TWO RED LIGHTS IN COCKPIT
HARDTOP DIMMER FOR COCKPIT LIGHTS COURTESY LIGHTS ON TRANSOM STEPS
3X5 FLOODLIGHT IN ARCH FACING AFT LITTLE WONDERMAKER 200 IN STARBOARD
TRANSOM LOCKER

Исключения

При продаже яхты исключаются личные вещи владельца.

Отказ от ответственности

Компания предоставляет описание судна или яхты добросовестно, но не может гарантировать точность этой информации, а также не ручается за техническое состояние. Покупатель должен проинструктировать своих агентов или оценщиков исследовать представленную информацию более подробно, по собственному желанию. Продажа судна или яхты, изменение цены или снятие с продажи будет происходить без предварительного уведомления.

ФОТОГРАФИИ

Aft Seating



Aft Starboard View



Arch W Seating and Solar



Starboard View



Aft



Port View



Hulls



Deck



Deck



Skreetcher



Deck



Deck



Starboard Hardtop With solar



Port Hardtop W Solar



Mast



Track



Helm Seat



Helm



Helm Electrical Panel

Helm



Electric Helm Winch W Bags



Port Cockpit



Cockpit



Cockpit



Helm



Mast



Helm Cleats



Starboard Aft



Salon



Salon



Salon Desk



Salon



Galley



Galley



Galley

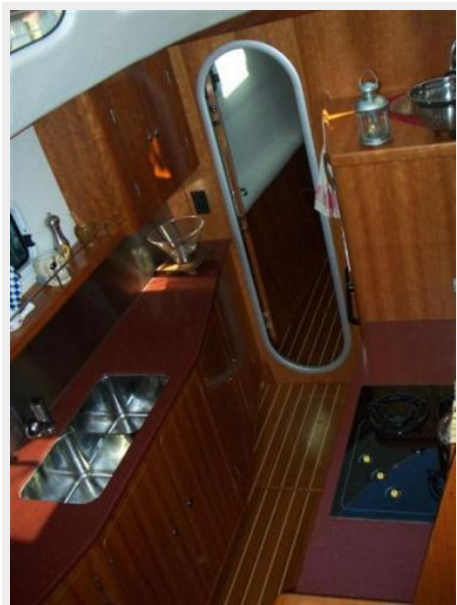

Fridge



Fridge



Freezer



Galley



Port Forward Stateroom



Port Forward Head



Port Forward Stateroom



Port Aft Stateroom



Port Aft Stateroom



Port Aft Stateroom



Master Head



Master Head



Master Head



Starboard Hull



Starboard Hull



Master



Master



Master



Master



Starboard Hull

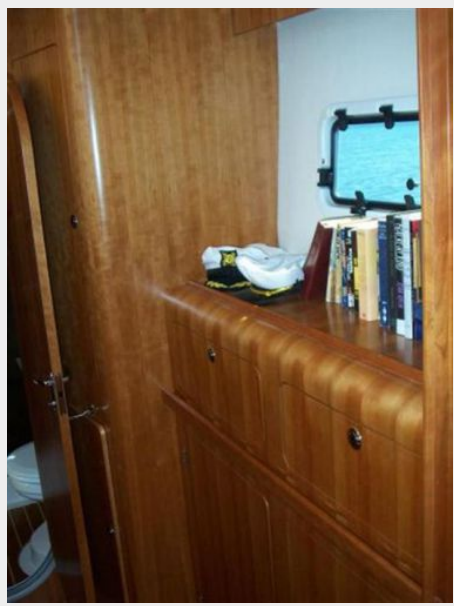

Master



Electrical Panel



Electrical Panel



Clean Wiring



Clean Starboard Bilge



Clean Starboard Engine



Clean Port Bilge



Clean Port Bilge



Clean Port Engine



Layout

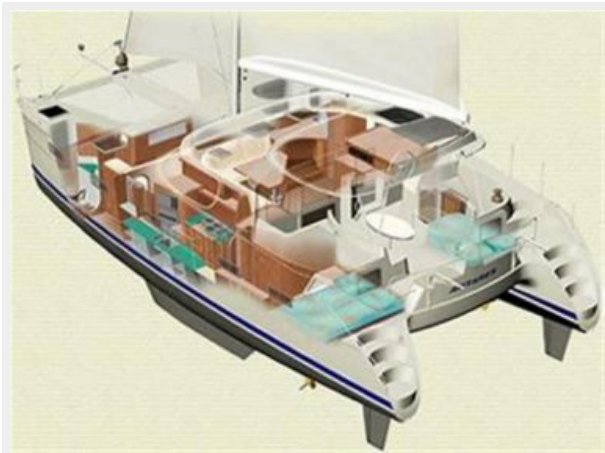

Layout

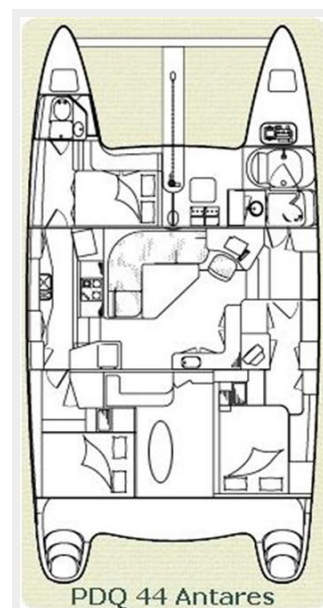

Forward View



Starboard



Port



Sailing



КОНТАКТЫ

Андрей Шестаков (Andrey Shestakov) – ведущий яхтенный брокер отдела продаж яхт и судов компании Shestakov Yacht Sales Inc. Официальный представитель Shestakov Yacht Sales Inc. для русскоговорящих клиентов в центральном офисе компании в Майами/Форт Лодердейл/Флорида/США.

Контактная информация

Email: andrey@shestakovyachtsales.com

Web: shestakovyachtsales.com

Телефоны

Краснодарский край: **+7(918)465-66-44**

США, Майами, Флорида: **+1(954)274-4435**

Время работы

Понедельник – Суббота: **9:00 - 21:00**
EDT

Воскресенье: **Закрито**

Адрес



Harbour Towne Marina, 850 NE 3rd St,
STE 213, Dania, FL 33004