

RHOBOAT — HATTERAS



Builder: HATTERAS

Year Built: 1989

Model: Motor Yacht

Price: PRICE ON APPLICATION

Location: United States

LOA: 65' 10" (20.07m)

Beam: 18' 2" (5.54m)

Max Draft: 5' 5" (1.65m)

Cruise Speed: 15 Kts. (17 MPH)

Max Speed: 18 Kts. (21 MPH)

Our experienced yacht broker, Andrey Shestakov, will help you choose and buy a yacht that best suits your needs **Rhoboat — HATTERAS** from our catalogue. Presently, at Shestakov Yacht Sales Inc., we have a wide variety of yachts available on our sale's list. We also work in close contact with all the big yacht manufacturers from all over the world.

If you would like to buy a yacht **Rhoboat — HATTERAS** or would like help answering any questions concerning purchasing, selling or chartering a yacht, please call **+1(954)274-4435**

TABLE OF CONTENTS

TABLE OF CONTENTS	2
SPECIFICATIONS	4
Overview	4
Basic Information	4
Dimensions	4
Speed, Capacities and Weight	4
Accommodations	5
Hull and Deck Information	5
Engine Information	5
DETAILED INFORMATION	6
Accommodations and Layout	6
Galley	6
Engine Room & Mechanical	6
Electronics and Entertainment	6
Hull & Deck Equipment	7
Electrical System	7
Remarks	7
Exclusions	8
Disclaimer	8
PHOTOS	9
Galley	9
Settee	9
Salon forward view	9
Entertainment and Wetbar	9
Sofa	9
Master stateroom	9
Master Bath	10
Dressing Room	10

Guest stateroom	10
Guest stateroom mid	10
Spiral Stairs to Flybridge	11
Lower helm	11
Wet Bar	11
Upper Helm	11
Flybridge aft view	11
Foredeck	11
Stern view	12
Aft deck	12
Engine room	12
Genset room	12
Layout	12
CONTACTS	13
Contact details	13
Telephones	13
Office hours	13
Address	13

SPECIFICATIONS

Overview

This classic Hatteras 65' motoryacht is a popular 4 stateroom, galley-up flush deck design with a wheelhouse. The exterior looks excellent and will appeal to boaters who appreciate an extra-large master stateroom area with a separate dressing room (or infant nursery). The white panels throughout the boat can be removed if one desires the original hatteras teak paneling. The machinery features a recently overhauled GM 12V71 engine (the other was completely inspected and certified to be in good condition) , renewed waste hoses and equipment , twin gensets, stabilizers and watermaker. The flybridge area features a custom wetbar and twin bimini tops. She is priced to sell by the original owner (wants to move up). Easy to inspect anytime in North Miami, Florida. Bring all offers!!! Check out the photos and register to see more details!

Basic Information

Category: Motor Yacht

Sub Category: Pilothouse

Model Year: 1989

Year Built: 1989

Country: United States

Fly Bridge: Yes

Dimensions

LOA: 65' 10" (20.07m)

Beam: 18' 2" (5.54m)

Max Draft: 5' 5" (1.65m)

Speed, Capacities and Weight

Cruise Speed: 15 Kts. (17 MPH)

Max Speed: 18 Kts. (21 MPH)

Displacement: 100000 Pounds

Water Capacity: 350 Gallons

Fuel Capacity: 1170 Gallons

Accommodations

Total Cabins: 4

Total Berths: 6

Sleeps: 7

Total Heads: 4

Crew Berths: 1

Crew Sleeps: 1

Crew Heads: 1

Hull and Deck Information

Hull Material: Fiberglass

Deck Material: Fiberglass Sandwich

Hull Configuration: Semi-Displacement

Hull Color: Hatteras Off-White

Engine Information

Engines: 2

Manufacturer: Detroit Diesel

Engine Type: Inboard

Fuel Type: Diesel

DETAILED INFORMATION

Accommodations and Layout

Galley up design with full beam salon and enclosed aft deck (teak flooring). The salon features loose sofas to aft and port with a built in entertainment center and wetbar forward and starboard. To port and forward is a custom glass-topped **dining table for six**. A **stainless steel spiral staircase** accesses the flybridge. The guest accommodations are reached via a stairwell to starboard of the lower helm station and features **3 double twin cabins all with private baths**. Additionally, **the master stateroom area is aft and features a large dressing room** with cedar-lined wardrobes and a bath to starboard complete with a Jacuzzi tub. A king-sized centerline bed with white -lacquered drawers and nightstands. All cabins have opening portlights. The décor is white vinyl panels which cover original teak (can be renewed). The countertops throughout are burl-toned mica. Flooring is off-white pile carpeting (with canvas runners), **black granite flooring** in the galley and helm area, and **beige marble** in the baths.

Galley

The galley is just aft of the lower helm and forward of the salon featuring white cabinetry, mica countertops and black granite flooring. A u-shaped settee with table is to starboard. Kenmore s/s side-by-side fridge/freezer Whirlpool oven and 4-burner cooktop Frigidaire Dishwasher Whirlpool trash compactor Wetbar salon (Scotsman icemaker and sink) Wetbar Flybridge (sink, Scotsman icemaker, drink fridge)

Engine Room & Mechanical

Twin Detroit diesel 12V71 TA's with Walker airseps and D'Angelo exhausts. **Port engine was rebuilt (15 hrs smoh). Stbd engine has 2200 original hours.** These engines are very durable and run great! Dual racor fuel/water separators with vacuum gauges for each engine Dahl fuel/water separators for each genset Bronze seacocks and strainers Sink and toolbox (ER) Oil changing system Air compressor Hynautic engine controls New steering tubing (2012)

Trim Tabs **Naiad Stabilizers H2O watermaker** CO2 fire suppression system (ER) Cruisair air-conditioning units with digital controls Galley Maid 24 vdc fresh water pump Galley Maid heads **(all hoses and pumps renewed 2007)** Auto/manual bilge and sump pumps

Electronics and Entertainment

The lower helm area features a helm station with an overhead console and a bench seat to port. Wing doors open to the port and starboard walkarounds leading to the foredeck. The upper helm features a single helm chair and instrument console.

Northstar 962XD plotters (FB and PH) Robertson AP200 autopilot (FB and PH) Furuno GPS -36 and 500 (PH) Furuno 72 nm radar (PH) Datamarine datalink (depth, speed, wind) (FB and PH) Furuno VHF (PH)

Icom VHF (FB)

SEA hailer (FB)

Ritchie compasses (FB and PH) TV's each stateroom Sylvania flat-screen television (salon) Denon stereo receiver (salon) Kenwood CD player (salon) Cable TV inlet and distribution

Hull & Deck Equipment

Hatteras is renowned for their sturdy and smooth riding Hargrave designed hulls. The hull bottom is solid FRP with cored hull-sides, decks and house. The original Hatteras off-white **Imron has been well-maintained** and is in excellent condition. The flybridge features a boat deck aft, large U-shaped settee with a fixed, hinged table, fore and aft white sunbrella bimini tops, and a custom wet-bar to port. Vinyl cushions for this area and foredeck seating. Windows in the salon and galley slide open. Decks are non-skid paint. The hull is recently painted and blister-free. Marquipt hydraulic davit (2005) Hydraulic windlass Galvanized CQR anchor and chain Tide-ride boarding steps Foredeck boxes Fenders and lines Foredeck hatch Black mesh lower helm screen covers (new 2012) Twin bimini tops (FB 2012) Swim platform with tender whips and ladder to aft deck Teak handrails (Awlbrite 2012) Aft deck enclosure (renewed 10.13)

Electrical System

220/110 vac (60 hz) distribution panels (lower helm) Glendinning shorepower reels (port and starboard) (2) isolation transformers for shorepower 12/24 vdc distribution panels Battery banks (engine and genset starting, house, electronics - renewed 2011, 2012) Sentry battery charger(2) **Onan 20 kw gensets** with 2500, 2700 hours (4.12) - accessed in generator room below foyer in lower deck. Track lighting (salon) Interior halogen lighting Exterior courtesy lighting Navigation lighting Docking lights

Remarks

This well-maintained Hatteras 65 is a unique offering. The exterior looks excellent and will appeal to boaters who appreciate an extra-large master stateroom area with a separate dressing room (or infant nursery). The white panels throughout the boat can be removed if one desires the original hatteras teak paneling. The machinery features a recently overhauled engine (the other was completely inspected and certified to be in good condition) , renewed waste hoses and equipment , twin gensets, stabilizers and watermaker. The flybridge area features a custom

wetbar and twin bimini tops.

Exclusions

Owner's personal belongings.

Disclaimer

The Company offers the details of this vessel or yacht in good faith but cannot guarantee or warrant the accuracy of this information nor warrant the condition of the vessel. A buyer should instruct his representatives, agents, or his surveyors, to investigate such details as the buyer desires validated. This vessel or yacht is offered subject to prior sale, price change, or withdrawal without notice.

PHOTOS

Galley



Settee



Salon forward view



Entertainment and Wetbar



Sofa



Master stateroom



Master Bath



Dressing Room



Guest stateroom



Guest stateroom mid



Lower helm



Spiral Stairs to Flybridge



Upper Helm



Wet Bar



Flybridge aft view



Foredeck



Stern view



Aft deck



Genset room



Engine room



Layout

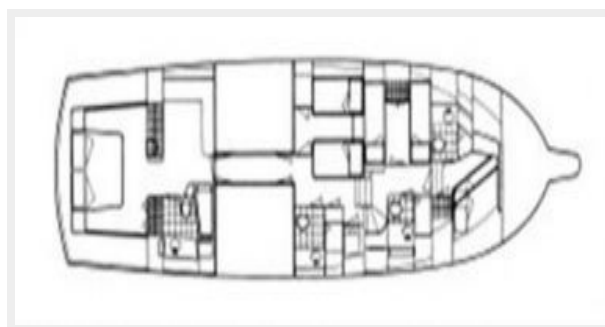

CONTACTS

Andrey Shestakov, leading yacht broker of the sales department of Shestakov Yacht Sales Inc. Shestakov Yacht Sales Inc., the official representative of the Miami/Fort Lauderdale FL headquarters.

Contact details

Email: **andrey@shestakovyachtsales.com**

Web: shestakovyachtsales.com/en/

Telephones

USA: **+1(954)274-4435**

Office hours

Monday – Saturday: **9:00 - 21:00 EDT**

Sunday: **closed**

Address



Harbour Towne Marina, 850 NE 3rd St,
STE 213, Dania, FL 33004