

ALASKAN 75' NEW BOAT BUILD SPECS (AI — ALASKAN



Судостроитель: ALASKAN

Год постройки: 2012

Модель: Моторная яхта

Цена: ЦЕНА ЯХТЫ ПО ЗАПРОСУ

Местонахождение: China

Длина общая: 75' 0" (22.86m)

Ширина: 19' 7" (5.94m)

Макс. осадка: 5' 0" (1.52m)

Крейс. скорость: 10 Kts. (12 MPH)

Макс. скорость: 18 Kts. (21 MPH)

Купить **Alaskan 75' New Boat Build Specs (Addendum A) — ALASKAN** а также выбрать подходящую вам яхту из нашего каталога яхт вам поможет опытный яхтенный брокер Андрей Шестаков. На сегодняшний день компания **Shestakov Yacht Sales Inc.** имеет большое количество яхт в собственном списке продаж, а также тесно сотрудничает со всеми крупными яхтенными производителями по всему миру.

Для того чтобы купить яхту **Alaskan 75' New Boat Build Specs (Addendum A) — ALASKAN** а также проконсультироваться по любому вопросу связанному с покупкой, продажей, чартером яхт позвоните по телефону **+7(918)465-66-44**.

ОГЛАВЛЕНИЕ

ОГЛАВЛЕНИЕ	2
ХАРАКТЕРИСТИКИ	3
Обзор	3
Основная информация	3
Размеры	3
Скорость, вместимость и масса	3
Размещение	4
Корпус и палуба	4
Информация о двигателе	4
ПОДРОБНОЕ ОПИСАНИЕ	5
Construction	5
General	5
Deck	6
Engine Room	7
Interior Finishes	8
Typical Electronics Package	9
Appliances	10
Special Features	10
Options	11
Исключения	11
Отказ от ответственности	11
ФОТОГРАФИИ	12
КОНТАКТЫ	13
Контактная информация	13
Телефоны	13
Время работы	13
Адрес	13

ХАРАКТЕРИСТИКИ

Обзор

This Alaskan model can be built as a flushdeck as well as the raised pilothouse.

Основная информация

Тип судна: Моторная яхта

Подкатегория: Raised Pilothouse

Модельный год: 2013

Год постройки: 2012

Страна: China

Открытая палуба мостика: Да

Размеры

Длина общая: 75' 0" (22.86m)

Ширина: 19' 7" (5.94m)

Макс. осадка: 5' 0" (1.52m)

Длина привального бруса: 75' 0"
(22.86m)

Скорость, вместимость и масса

Крейс. скорость: 10 Kts. (12 MPH)

Дальность на крейсерской скорости:
2200

Макс. скорость: 18 Kts. (21 MPH)

Водоизмещение: 140000 Pounds

Вместимость воды: 600 Gallons

Вместимость сточного бака: 200 Gallons

Объем топливного бака: 3000 Gallons

Размещение

Всего кают: 4

Всего коек: 6

Спальные места: 8

Всего ком. состава: 4

Каюта капитана: Да

Каюты экипажа: 1

Койки экипажа: 2

Спальных мест экипажа: 2

Корпус и палуба

Материал корпуса: Fiberglass

Материал палубы: Fiberglass

Комплектация корпуса: Semi-Displacement

Цвет корпуса: White

Отделка корпуса: Stainless Steel

Информация о двигателе

Двигатели: 2

Производитель: Caterpillar

Модель: C-18 Acerts

Тип двигателя: Inboard

Тип топлива: Diesel

ПОДРОБНОЕ ОПИСАНИЕ

Construction

Construction:

- Cored 1 1/4" main bulkheads padded at hull, bonded as per schedule
- Boat deck drain system to water line
- Four full length longitudinal engine stringers and athwartship reinforcing stringers (as per design) of foam cored laminated fiberglass
- Hull to deck connection mechanically fastened and bonded, as per schedule
- Laminated vacuum bagged fiberglass reinforced with PVC rigid foam core in all hull and deck areas above the waterline and solid hand lay-up below the waterline
- Molded FRP interior and exterior window frames
- Reinforced windlass anchor platform, per plans
- Multiple Laminations at chine, keel and running hardware locations
- Underwater exhaust with bypass
- Uni-directional and bi-directional laminates at engine stringers and hull door openings
- Vinylester barrier hull laminate for osmosis protection
- Water cooled exhaust system

General

- 3 or 4 staterooms, 3 or 4 heads plus crew
- 5" Ritchie compasses: one on flybridge, and one in pilothouse
- LED AC and DC lighting throughout interior, per plan with distribution panels at lower station, 5 point AC switches, 24 volt
- Air conditioning deflectors/covers at pilothouse for vents
- Bottom paint: two (2) coats of Micron CSC; five (5) coats Gelshield-2000
- Condensation groove on all windows
- LED Courtesy lights exterior and interior
- Cruiseair air conditioning 230 volt AC/60 hz reverse cycle with SMX controls and remote compressors, five zone, chilled water
- Electronic Glendinning controls at two station
- Hynautic hydraulic steering
- Khalenberg double air horn
- Manship stainless steel port lights with screens, per plan
- Multiple athwarship stringers
- Pilothouse table in teak, hi-lo with folding leaf, stainless steel pedestal
- Spray rails

- Stainless steel destroyer wheel on flybridge
- Pompanette Platinum helm seat: two reclining backrest and adjustable armrests, stainless steel hardware, Hi-Lo adjustable pedestal with footrest, upholstered in "Naugahyde", located on Flybridge
- Pompanette Platinum helm seat: one reclining backrest and adjustable armrests, stainless steel hardware, Hi-Lo adjustable pedestal with footrest, upholstered in "Dura Touch", located in pilothouse
- Teak and stainless steel destroyer wheel in pilothouse
- Telephone stations, pre-wired, seven (7)
- Telephone/TV two inlets phone/cable TV inlet connectors fore and aft
- Tempered glass, front windows are 3/8" and side windows are 1/4" tinted
- Tinted flybridge Venturi wind screen with stainless steel frame
- Two-arm parallel windshield wipers with fresh water wash system, three (3)
- Windshield defrost ducts
- Indirect rope lighting
- 1,000 GPD watermaker
- Head and galley ventilation - individual time delayed vent fans
- Security cameras in engine room / aft deck / bridge deck

Deck

- 1 1/2 316 stainless steel handrails with welded joints at forward deck and boat deck
- 24 volt deck dome lights
- Aft deck spacious enough for a wet bar, with built in bench seating and table. There is plenty of room for extra deck furniture as well.
- Molded flybridge access steps.
- Anchor chain and anchor rope storage with tumble system in divided chain locker
- Anchor roller/chock 316 stainless steel
- Aqua navigatoin lights (white finish)
- Bilge areas finished smooth with white epoxy paint
- Bow and stern flag staffs and sockets
- Breast plate" protecting plate on bow, stainless steel
- Swim platform shower in FRP cabinet
- Conduit from mast to pilothouse for radar and antenna
- "Exalto" two speed wiper system with F/W wash - three double arm
- Exterior safety lights
- Fiberglass cap rail and trim
- Flybridge cabinet for storage or equipment (BBQ, wet bar, etc.)
- Flybridge seating with storage beneath, teak grates, sunbrella upholstered cushions
- Formed fiberglass fiberglass flybridge and seating area with sunbrella cushions
- Watertight doors for transom and pilothouse
- Fresh water wash down; fore, aft, engine room and flybridge
- Hawse hole/cocks (8)

- Light and Pennant mast
- Lockers to port and starboard for fowl weather gear or deck furniture
- Manship stainless steel port lights with screens
- Manship stainless steel / acrylic deck hatches
- Maxwell 4000 single capstan windlass, dual directional, two station, vertical
- Molded fiberglass exterior window and door frames
- Molded upper and lower rub rails capped with 1 1/4" stainless steel trim rail
- Multiple athwartship stringers, as per plan
- 2000 lb. fully hydraulic davit, hardwired (240 volt AC) 10 1/2' boom
- One 110 lb. CQR type anchor and 300'-1/2" Hi test chain
- One 12" anchor cleat
- One Khalenburg triple air horn with compressor
- One stainless steel destroyer wheel on flybridge
- Spreader lighting on flybridge and swim deck
- Swim ladder, stainless steel (built in)
- Tinted flybridge wind screen with stainless steel frame
- Transom gate doors and port/starboard hull doors
- Two swim platform pop-up cleats
- White non-skid decks

Engine Room

Engine room bulkheads and ceiling are sound shielded with sound down insulation. Fuel tanks are faced with insulation and white aluminum clad hardboard. Flooring is synthetic coin dot.

- 80 amp Sentry charger for engine and house batteries, 24 volt
- 40 amp Sentry charger for generator and electronics, 12 volt
- 60 amp C-10 alternators
- Two isolation transformers for shore power inlets
- 1000 GPD modular stainless steel water maker
- AC and DC engine room lighting eight and four
- Accessible clean outs on all tanks
- Baffled engine air intakes to resit water induction
- Chilled water air conditioning - 96,000 BTU's
- Complete engine instrumentation at both stations, per plan
- Livos technology engine room environment controls and moisture elimination
- Dockside water pressure system with regulator
- Dripless shaft seals - two on each shaft
- Engine battery parallel system
- Engine beds of custom formed stainless steel
- Engine driven emergency bilge pump off engine
- Engine room bulkheads and ceiling are sound shielded with multiple layers of high density foam and lead

- Fiberglass mufflers for engines and generators
- Fire suppression system
- Five Rule 3500 bilge pumps with automatic switches
- Flooring is synthetic coin dot pattern
- Four 8D 24 volt starting batteries with secured box
- Four fuel tanks, per plan at 2,600 US gallons (additional tankage available)
- FRP 200 gallon holding tank system beneath sole with macerator and deck pump outs
- Fuel tanks are shielded with sound detaining insulation
- Fuel transfer system with manifold and polishing filtration
- Full flow valves throughout
- Gauge system for fuel and water
- Glendinning electronic controls at two stations
- Groco Senior Pressure Max system with filter and accumulator tank and heavy duty fresh water pump
- High water alarm with bilge pump switch - 5 zone
- Oil change pump with manifold
- One stainless steel water tank, 600 gallons
- Quality bronze propellers sized for HP
- Quality stainless steel propeller shaft struts with cutlass bearings
- Sealand macerator discharge pump
- Sealand monitor panel
- Shaft grounding brush
- Shut off valve at all tank supply fittings
- Hydraulic bow/stern thrusters, 20 hp with dual stations
- Stainless steel fuel manifold system (supply and return)
- Stainless steel rudder posts
- Stainless steel stanchions and engine safety rails
- Supply lines from all tanks from aft lowest corner
- Hydraulic stabilizers, electronic dual station, with 9" square fin
- Trace 4000 inverter with two AGM 8D batteries
- Two 12 volt AGM start batteries for generators with secured box
- Two 8D 24 volt AGM deep cycle house batteries with secured box
- Two 18 gallon stainless steel hot water heaters, 240 Volt
- Two 25 KW Northern Lights generators with sound shields
- Two Glendinning Cablemaster CM7 with 100" - fore and aft (50 amp/220 Volt) cable
- Two Racor 75/1000 MAX fuel filters for generators - one each
- Two Racor 75/1000 MAX dual fuel filters for each main engines
- Whale Gusher diaphragm bilge pump
- Two sea chests

Interior Finishes

- All cabinetry is teak with hand rubbed satin finish
- All wall surfaces/bulkheads are teak veneer or wallpaper
- Cabin soles teak and holly in wheelhouse, galley and heads
- Countertops, corian or standard granite countertops at galley and heads
- Covers for interior switches and outlets are custom teak
- Fixtures/faucets, all Grohe including galley, heads and showers
- Foam cushions upholstered in Sunbrella fabric
- Formica or mirror headliner in heads
- Hanging cedar lined lockers with automatic lighting, vinyl interior
- Interior door hardware brushed stainless steel: cabinets are chrome hinges with chrome or brass push/pulls; stainless steel dawgs, four (4) on pilothouse doors
- Mirrors are teak framed
- Red lights at pilothouse with dimmer switch, two (2)
- Refrigerator locks, hinged L-locks, two (2) stainless steel
- Shelves painted in lazarette
- Showers, FRP surface
- Sinks: galley-polar, double: heads, polar oval-stainless steel
- Vinyl headliner throughout (except heads)
- Walk in pantry or day head

Typical Electronics Package

This package provides: dual-station GPS/chartplotter with radar (6kw 4-6ft open array); backup GPS/chartplotter/echosounder system; 15 inch monitor; dual-station VHF (DSC) radio with intercom, foghorn and hailer; dual-station depth/data displays; dual-station autopilot control (also functions as data repeater); transducers include two depth transducers and wind masthead unit; Simrad data card for saving all CX54 data.

- CX54 15-inch GPS/chartplotter/radar display at lower helm
- 6K48A radar antenna, 6kw 4-6ft open array
- 15-meter radar cable (10 m is standard length)
- DS44-CX 10-inch second station for CX44 at bridge
- Data card
- CX33-E 6 inch GPS/chartplotter/echosounder at lower helm
- Monitor, 15-inch LCD (24-volt)
- RS86:F VHF radio system (intercom, hailer, foghorn, can have up to 4 stations)
- 87AKH second station for VHF, 87 handset style
- IS15 Multi data display head set for Depth (large digits only) lower helm
- AT15 Active T connector (SimNet)
- IS15 Multi data display head set for Depth (large digits only) bridge
- AT15 Active T connector (SimNet)

- AP25 Autopilot System (AP2504=AP25,AC20, RC36, RF300, RPU80)
- AP25 second station display for bridge
- IS12 TW wind transducer
- B17 Smart transducer, 235kHz, primary depth data source
- B744V triducer, 50/200 kHz, speed/depth/temp for CX33-E
- Hi-speed fairing block for B744V triducer

Because of rapid changes in electronics, packages and equipment may vary depending on buyers requirements. Amounts over the allowance will be paid by buyer at time of ordering.

ALLOWANCE: \$50,000.00

Entertainment Package

Alaskan Yachts will prewire boat to specified package. It is the owners responsibility to install and pay for entertainment equipment at the time of ordering.

Appliances

Appliances can include:

A) Standard G.E. Profile Performance Series: cook top, glass top, electric, dishwasher, microwave, convection oven, refrigerator/freezer / freezer with in-door ice and water, side-by-side, trash compactor.

B) Frigidaire; front loading washer and dryer (choice of black, white or custom wood panels)

Drawings supplied in the spec may show optional items.

Allowance: \$25,000.00

Special Features

Crew Quarters are configured by client, but can include:

- Full double berth stateroom with head, shower, sink, refrigerator, microwave and stereo
- Private access
- Very large storage room that could be converted into a lounge area

Options

Options:

- Cockpit
- Etched shower doors
- Teak blinds
- Third station controls
- Teak and holly flooring
- Under water lights
- Teak decking

EURO EDITION OPTION = \$300,000.00

- CE Mark
- Passerelle
- Electrical
- Shipping

Исключения

При продаже яхты исключаются личные вещи владельца.

Отказ от ответственности

Компания предоставляет описание судна или яхты добросовестно, но не может гарантировать точность этой информации, а также не ручается за техническое состояние. Покупатель должен проинструктировать своих агентов или оценщиков исследовать представленную информацию более подробно, по собственному желанию. Продажа судна или яхты, изменение цены или снятие с продажи будет происходить без предварительного уведомления.

ФОТОГРАФИИ

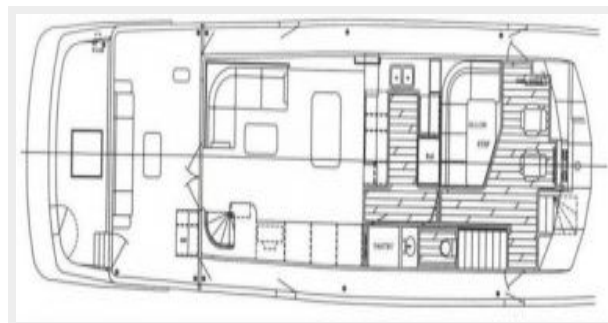
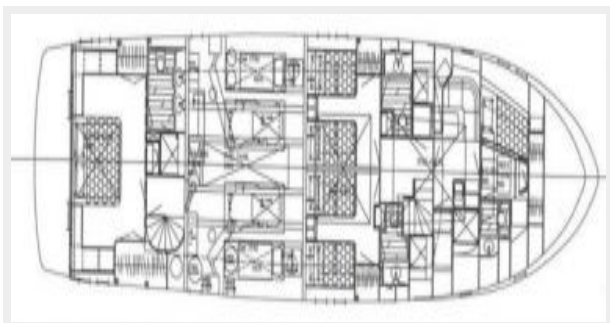
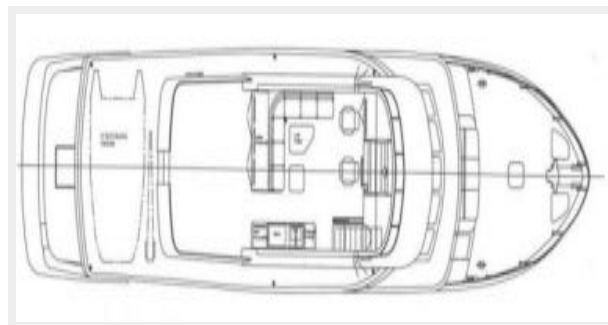
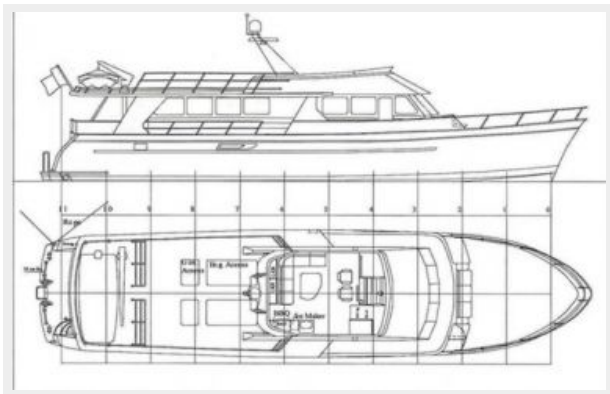

КОНТАКТЫ

Андрей Шестаков (Andrey Shestakov) – ведущий яхтенный брокер отдела продаж яхт и судов компании Shestakov Yacht Sales Inc. Официальный представитель Shestakov Yacht Sales Inc. для русскоговорящих клиентов в центральном офисе компании в Майами/Форт Лодердейл/Флорида/США.

Контактная информация

Email: andrey@shestakovyachtsales.com

Web: shestakovyachtsales.com

Телефоны

Краснодарский край: **+7(918)465-66-44**

США, Майами, Флорида: **+1(954)274-4435**

Время работы

Понедельник – Суббота: **9:00 - 21:00**
EDT

Воскресенье: **Закрето**

Адрес



Harbour Towne Marina, 850 NE 3rd St,
STE 213, Dania, FL 33004